

BIKE	KAWASAKI Z1000	PART NO.	EKA-79
YEAR	2007 - 2009	FIT KITS	OVAL Z039.11234 // ROUND Z039.10234
NOTES	Where not supplied use original fittings	DB-Killer	2 x SCEXDBK12 - (Type B)

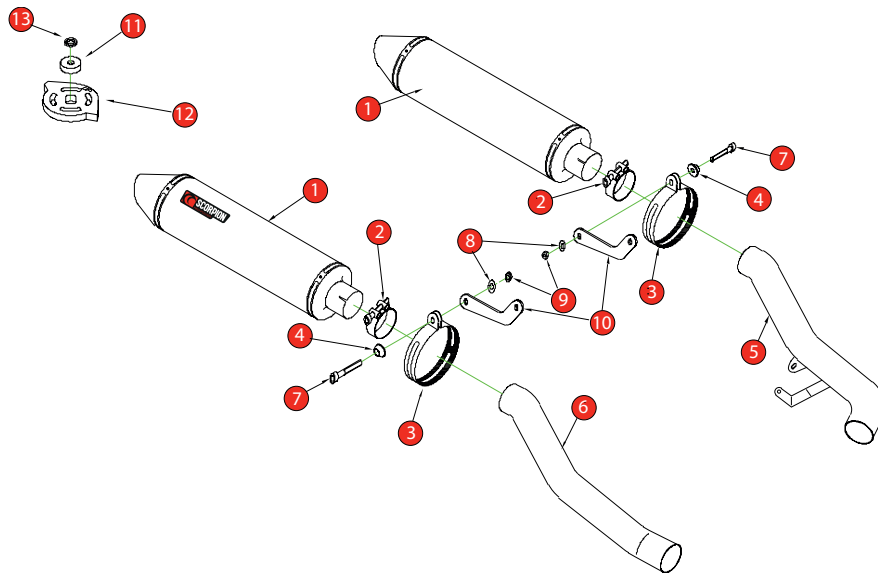

**DO NOT TURN ON BIKE UNTIL INSTALLATION IS COMPLETE AND SERVO WHEEL HAS BE FULLY INSTALLED.**

1	2 x 450mm Silencers ESC 118	9	2 x M8 Nyloc Nuts (Z017.10062)
2	2 x 51-55mm Band Clamps (Z016.10002)	10	2 x Mounting Brackets (Z015.20931)
3	2 x Composite Straps (R-Z038.10090)(O-Z038.10088)	11	Aluminium Collar (Z026.20045)
4	2 x Aluminium Bolt Finishers (Z026.20068)	12	Replacement Servo Wheel (Z007.10955)
5	Connecting Pipe CP 422	13	M6 Split Washer (Z017.10027)
6	Connecting Pipe CP 423	14	Bump Stop Kit (Z017.10010)
7	2 x M8 x 25mm Cap Head Bolts (Z017.10073)		
8	2 x M8 x 17mm Washers (Z017.10831)		

**NOTE:** ENSURE SCORPION SYSTEM IS CLEAR OF MOVING PARTS AND ALL ORIGINAL FUNCTIONS WORK CORRECTLY.

E-MARK PIPE	<a href="#">KA-79R E4 2296</a> (5) <a href="#">KA-79O E4 2326</a> (5)
E-MARK ROUND	<a href="#">KA-79R E4 2296</a> (9)
E-MARK OVAL	<a href="#">KA-79O E4 2326</a> (9)
ISSUE NO.	08
DATE	18/10/2018
AUTHORISED	J.Harkin
CHECKED	

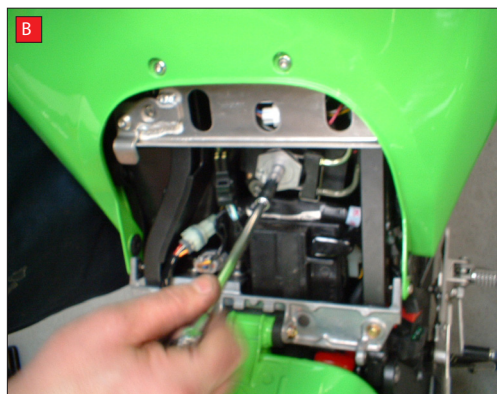
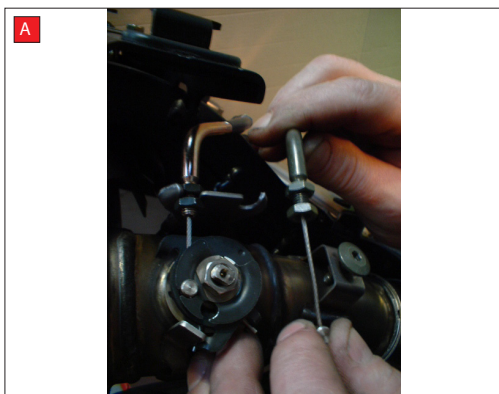

A) Disconnect cables on exhaust valve and leave loose.

B) To disconnect cables at the servo box end, you have to remove the hexagonal wheel, without turning it's shaft.

Remove bolt in centre of hexagonal wheel using an 8mm socket. Support wheel if tight.

C) Remove hexagonal wheel from shaft, retaining OE bolt. Do not turn shaft.

Remove spring clip retaining cables and completely remove the cables



D) The replacement wheel comes with an aluminium collar & spring washer that is secured in place with OE bolt – TIGHTEN TO 5ft/lb USING A TORQUE WRENCH.

**SCORPION**  
RED POWER

Box: PLOCK 1

BIKE	KAWASAKI Z1000	PART NO.	EKA - 79
YEAR	2007 - ON	FIT KITS	OVAL Z039.11234 // ROUND Z039.10234
NOTES	Where not supplied use original fittings	FEATURES	

CONTINUED FROM OVERLEAF:

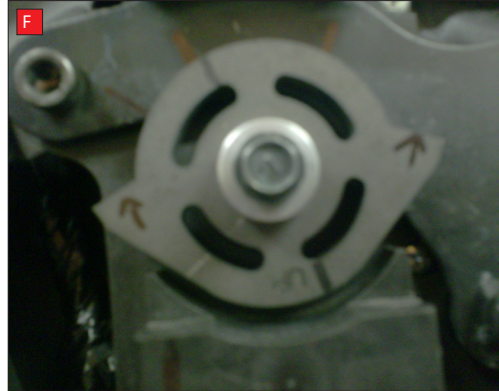

The replacement wheel must be fitted with the etched letters "UP"

E) RIGHT  
F) WRONG