

Box: PLOCK 2x2

BIKE	HONDA CB 900 HORNET	PART NO.	EHA - 76
YEAR	2001 - 2008	FIT KITS	OVAL Z039.11041 // ROUND Z039.10041
NOTES	Where not supplied use original fittings	DB-Killers	2 x SCEXDBK12 - (Type B)

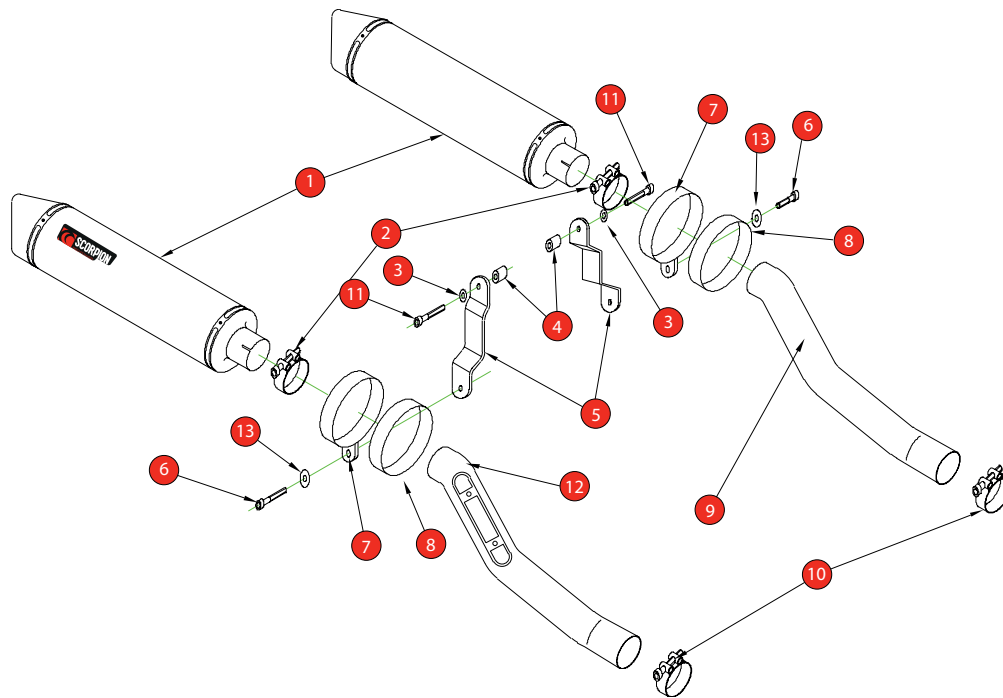

1 2 x 400mm Silencers ESC 51	8 2 x Silencer Strap Rubbers (Z029.10022)
2 2 x 51-55mm Band Clamp (Z016.10002)	9 Connecting Pipe CP 80
3 2 x M8 x 17mm Washers (Z017.10831)	10 2 x 37-40mm Band Clamps (Z016.10006)
4 2 x 15mm Aluminium Spacers (Z026.10005)	11 2 x M8 x 20mm Cap Head Bolts (Z017.10072)
5 2 x Mounting Brackets (Z015.10006)	12 Connecting Pipe CP 81
6 2 x M8 x 40mm Cap Head Bolts (Z017.10076)	13 2 x M8 x 25mm Washers (Z017.10825)
7 2 x Silencer Straps (R-Z028.10229) (O-Z028.10231)	

E-MARK ROUND	SCDB-RS E4 2035
E-MARK OVAL	SCDB-OS E4 2072
ISSUE NO.	08
DATE	09/10/2018
AUTHORISED	J.Harkin
CHECKED	

NOTE: ENSURE SCORPION SYSTEM IS CLEAR OF MOVING PARTS AND ALL ORIGINAL FUNCTIONS WORK CORRECTLY.

A) Remove original exhaust from bike, taking care to keep all original components in a safe place.

B) Refit Scorpion exhaust as per line diagram above.

C) When fitted take bike for a short ride to ensure all functions are correct.

D) When bike & exhaust are cool enough check all nuts and bolts are still secure.