

Box: PLOCK 2

BIKE	HONDA CB1100 XF (X11)	PART NO.	EHA - 72
YEAR	1999 - 2004	FIT KITS	OVAL Z039.11054 // ROUND Z039.10054
NOTES	Use standard fittings where not supplied Remove standard gasket if fitted.	DB-Killer	SCEXDBK12 - (Type B)

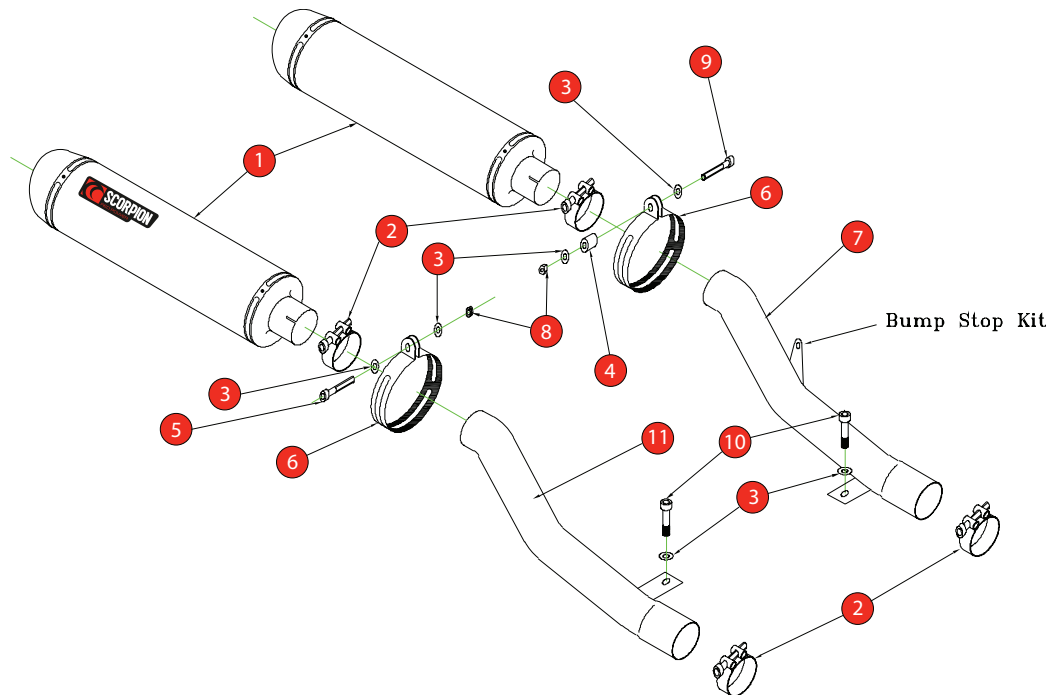

1	2 x 450mm Silencers ESC 50	8	2 x M8 Nyloc Nuts (Z017.10010)
2	4 x 51-55mm Band Clamps (Z016.10002)	9	M8 x 55mm Cap Head Bolt (Z017.10074)
3	4 x M8 x 17mm Washers (Z017.10831)	10	2 x M8 x 30mm Cap Head Bolts (Z017.10074)
4	10mm Aluminium Spacer(Z026.10004)	11	Connecting Pipe CP 60
5	M8 x 45mm Cap Head Bolt (Z017.10077)	12	Bump Stop Kit (Z017.10010)
6	2 x Comp Silencer Straps (R-Z038.10090) (O-Z038.10088)		
7	Connecting Pipe CP 59		

E-MARK ROUND	BSAU 193a 1990/t3
E-MARK OVAL	BSAU 193a 1990/t3
ISSUE NO.	06
DATE	09/10/2018
AUTHORISED	J.Harkin
CHECKED	

NOTE: ENSURE SCORPION SYSTEM IS CLEAR OF MOVING PARTS AND ALL ORIGINAL FUNCTIONS WORK CORRECTLY.

A) Remove original exhaust from bike, taking care to keep all original components in a safe place.

B) Refit Scorpion exhaust as per line diagram above.

C) When fitted take bike for a short ride to ensure all functions are correct.

D) When bike & exhaust are cool enough check all nuts and bolts are still secure.