

Box: PLOCK 1

BIKE	BMW K 1200 S/R	PART NO.	EBM - 57
YEAR	2005 - 2008	FIT KITS	OVAL Z039.11185
NOTES	Use standard fittings where not supplied Remove standard gasket if fitted.	DB-Killer	SCEXDBK12 - (Type B)

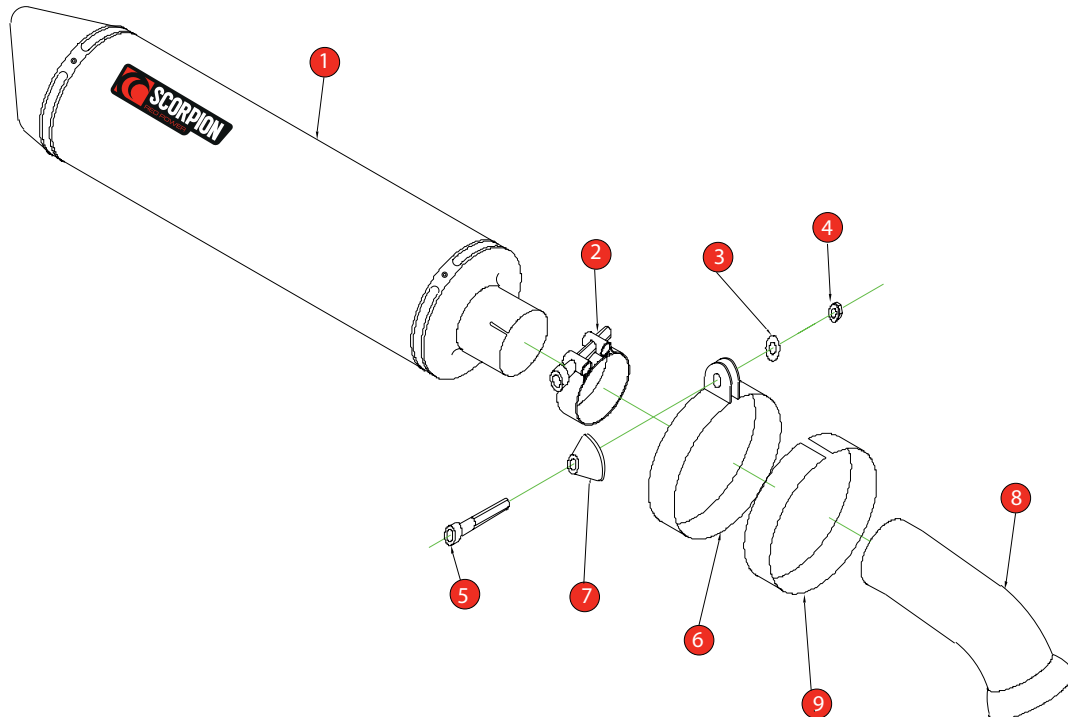

1 450mm Silencer ESC 26	8 Connector Pipe CP-315
2 63-69mm Band Clamp (Z016.10005)	9 Silencer Strap Rubber (Z029.10022)
3 M8 x 25mm Washer (Z017.10825)	
4 M8 Nyloc Nut (Z017.10103)	
5 M8 x 35mm Cap Head Bolt (Z017.10075)	
6 Oval Strap (Z028.10231)	
7 Aluminium Bolt Finisher (Z026.20068)	

E-MARK ROUND	N/A
E-MARK OVAL	SC-26 [e4] 2168
ISSUE NO.	08
DATE	13/12/2018
AUTHORISED	J.Harkin
CHECKED	

NOTE: ENSURE SCORPION SYSTEM IS CLEAR OF MOVING PARTS AND ALL ORIGINAL FUNCTIONS WORK CORRECTLY.

A) Remove original exhaust from bike, taking care to keep all original components in a safe place.

B) Refit Scorpion exhaust as per line diagram above.

C) When fitted take bike for a short ride to ensure all functions are correct.

D) When bike & exhaust are cool enough check all nuts and bolts are still secure.