

BIKE	HONDA CBR 1000 RR	PART NO.	RHA - 154
YEAR	2012 - 13	FIT KITS	Z039.20450
NOTES	Use standard fittings where not supplied Remove standard gasket if fitted.	DB-Killer	SCEXDBK25 - (Type Y)

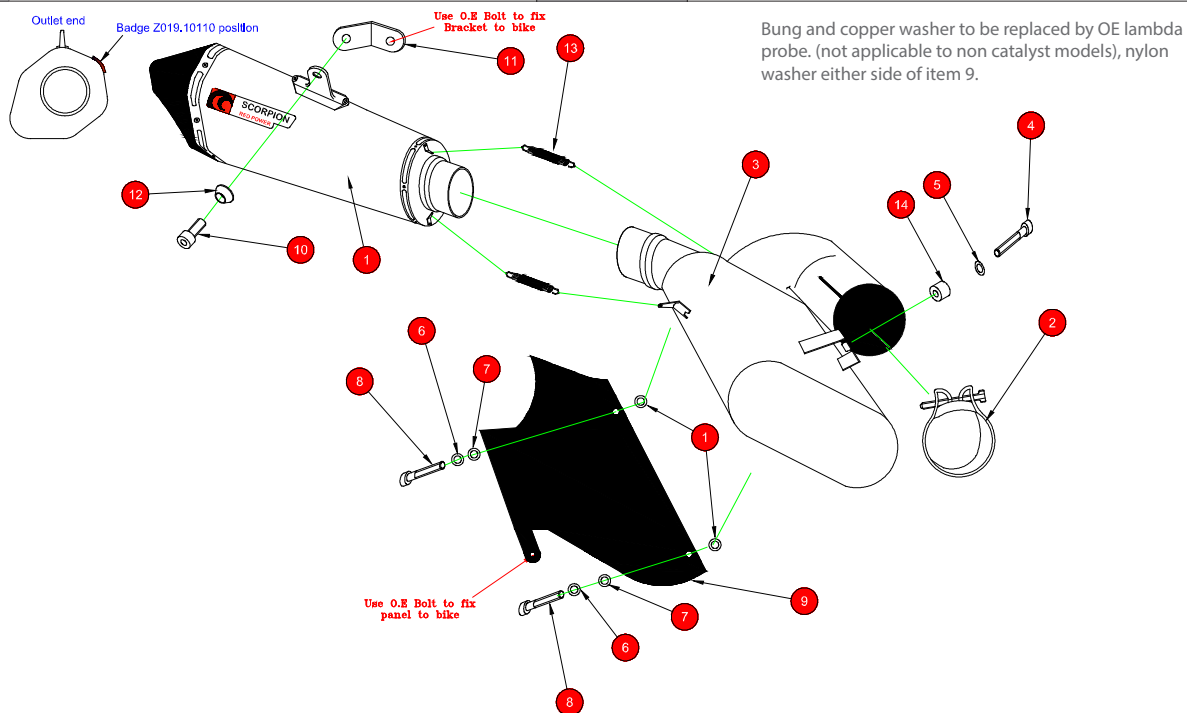

- | | |
|------------------------------------|---|
| 1 Serket Silencer 275mm RSC223 | 8 2 x M6 x 10mm Button Heads (Z017.12707) |
| 2 51-55mm Band Clamp (Z016.100030) | 9 Panel (Z028.20181) |
| 3 Connecting Box CP668 | 10 M8 x 20mm Cap Head (Z017.10072) |
| 4 M8 x 30mm Cap Head (Z017.10074) | 11 Mounting Bracket (Z015.30942) |
| 5 M8 x 17mm Washer (Z017.10831) | 12 Alloy Bolt Finisher (Z026.20068) |
| 6 2 x M6 Star Washers (Z017.10614) | 13 2 x Rubber Coated Springs (Z028.10030) |
| 7 4 x Nylon Washers (Z017.12748) | 14 15mm Alloy Spacer (Z026.10005) |

E-MARK BOX	HA-95
E-MARK OVAL	HA-95
ISSUE NO.	05
DATE	16/10/2018
AUTHORISED	J.Harkin
CHECKED	

NOTE: ENSURE SCORPION SYSTEM IS CLEAR OF MOVING PARTS AND ALL ORIGINAL FUNCTIONS WORK CORRECTLY.

Fitting instructions overleaf:



BIKE	HONDA CBR 1000 RR	PART NO.	RHA-154
YEAR	2012 - 13	FIT KITS	Z039.20450
NOTES	Bung and copper washer to be replaced by OE lambda probe. (not applicable to non catalyst models), nylon washer either side of item 9.	FEATURES	

CONTINUED FROM OVERLEAF:



A) Remove side panel behind pillion foot peg.



B) Remove back panel to allow access to servo wheel.

C) Turn servo wheel 45° clockwise, this make the cable easier to remove.

D) Remove the cable from the clip at the back of the servo wheel unit.

E) Remove the bolt on the belly pan to allow access to the O.E exhaust, save this bolt as it is used later on.

F) Remove the bolt on the other side belly pan to allow access to the O.E exhaust.

G) Remove Lambda sensor (if bike is fitted with one)

H) Loosen O.E clamp to free the O.E exhaust from O.E system.

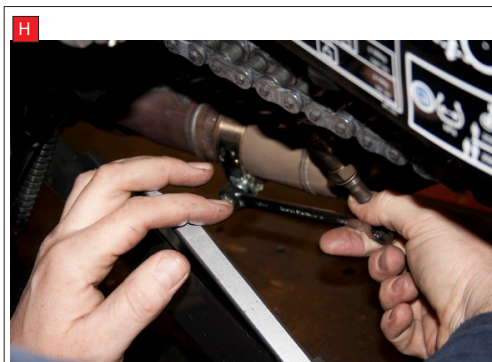
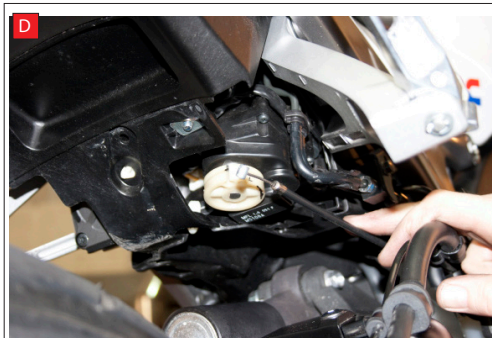

BIKE	HONDA CBR 1000 RR	PART NO.	RHA-154
YEAR	2012 - 13	FIT KITS	Z039.20450
NOTES	Bung and copper washer to be replaced by OE lambda probe. (not applicable to non catalyst models), nylon washer either side of item 9.	FEATURES	

CONTINUED FROM OVERLEAF:

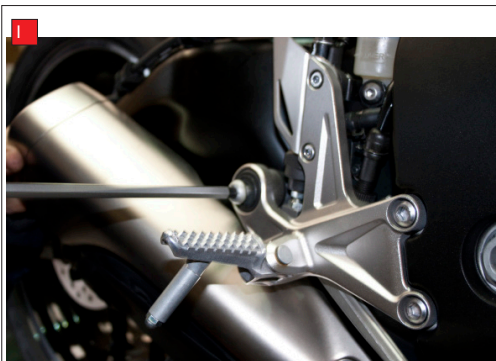

I) Remove O.E silencer mounting bolt, keep this bolt as it will be needed later on in fitting Scorpion Exhaust.

J) Slowly remove the O.E exhaust< take care with feeding out the servo cable.

K) Introduce the connecting box CP668 upto the O.E system, DO NOT tighten up the clamp.

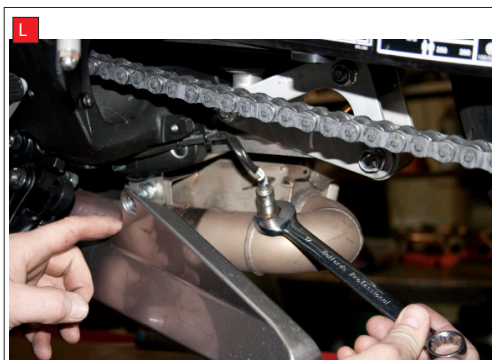
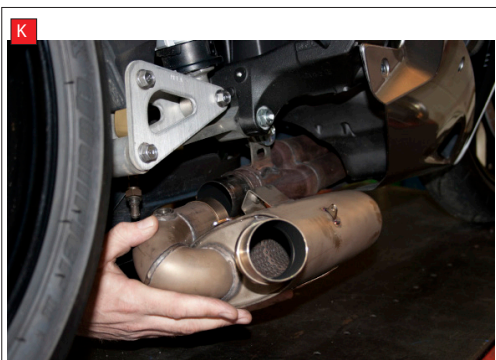

L) Put the Lambda sensor into the CP668, if no lambda sensor is on bike then leave in blanking plug, make sure the Lambda or blanking plug is tight.

M) Bolt on the Scorpion mounting bracket using the O.E mounting bolt, DO NOT FULLY TIGHTEN.

N) Fit Scorpion silencer to CP668, and bolt to the mounting bracket. tighten up both bolts and attach the 2 x rubber coated springs.

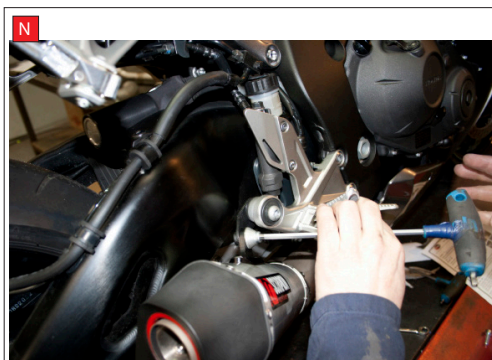
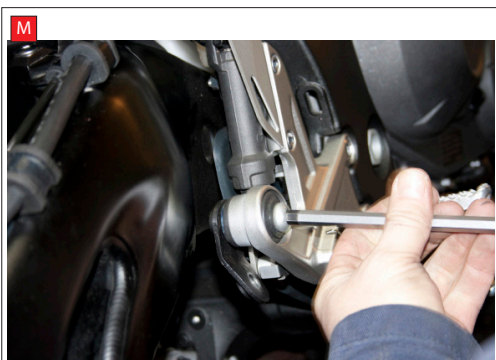

O) Fully tighten the clamp on CP668 to O.E system.

P) Bolt back the belly pan fairing on this side.

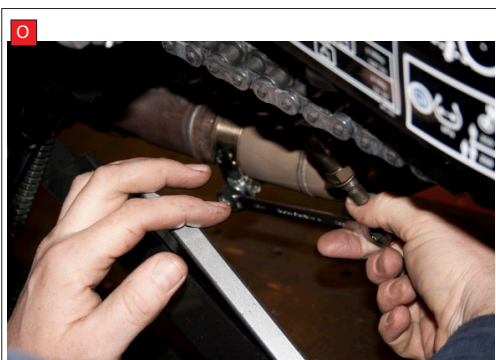

Box: PLOCK 3

BIKE	HONDA CBR 1000 RR	PART NO.	RHA-154
YEAR	2012 - 13	FIT KITS	Z039.20450
NOTES	Bung and copper washer to be replaced by OE lambda probe. (not applicable to non catalyst models), nylon washer either side of item 9.	FEATURES	

CONTINUED FROM OVERLEAF:



Q) Fit the Scorpion composite fairing, using the line drawing on page 1 to make sure all the fixings are in the correct place, on the top mounting point on the fairing use the O.E bolt.

R) Bolt back the 2 x plastic panels that hid the servo wheel.

S) When all the steps have been carried out double check all nuts and bolts are tight and that all the bikes original functions work correctly and that nothing on the bike is impaired. When satisfied fitment is correct take your bike for a short run to ensure system is sealed correctly and there are no gas leaks. After a short run, check all nuts and bolts are still tight and nothing has come loose.

Cleaning instructions overleaf:



Box: PLOCK 3

BIKE	HONDA CBR 1000 RR	PART NO.	RHA-154
YEAR	2012 - 13	FIT KITS	Z039.20450
NOTES		FEATURES	

Thank you for purchasing your Scorpion Silencer.

Care of your exhaust: Please refrain from cleaning silencer with heavy solvents or abrasives!

Vielen Dank Fur den kauf eines Scorpion Schalldampfers! Pflegehinweis: Bitte verwenden Sie niemals Scheuermittel oder aggressive Reiniger zur Pflege Ihres Auspuffes!

Merci d'avoir choisi un echappement Scorpion.

Entretien de votre silencieux: Ne pas utiliser de solvants ou de produits abrasifs!

"Muchas gracias por adquirir un Silencioso Scorpion. Le recomendamos no limpiar el silencioso con productos abrasivos o aquellos que contengan disolventes."