

Box: PLOCK 1

BIKE	SUZUKI GSX S 1000 inc. FA	PART NO.	SI-1009
YEAR	2015- Current	FIT KITS	Z039.10555
NOTES	Use standard fittings where not supplied Remove standard gasket if fitted.	DB-Killer	N/A

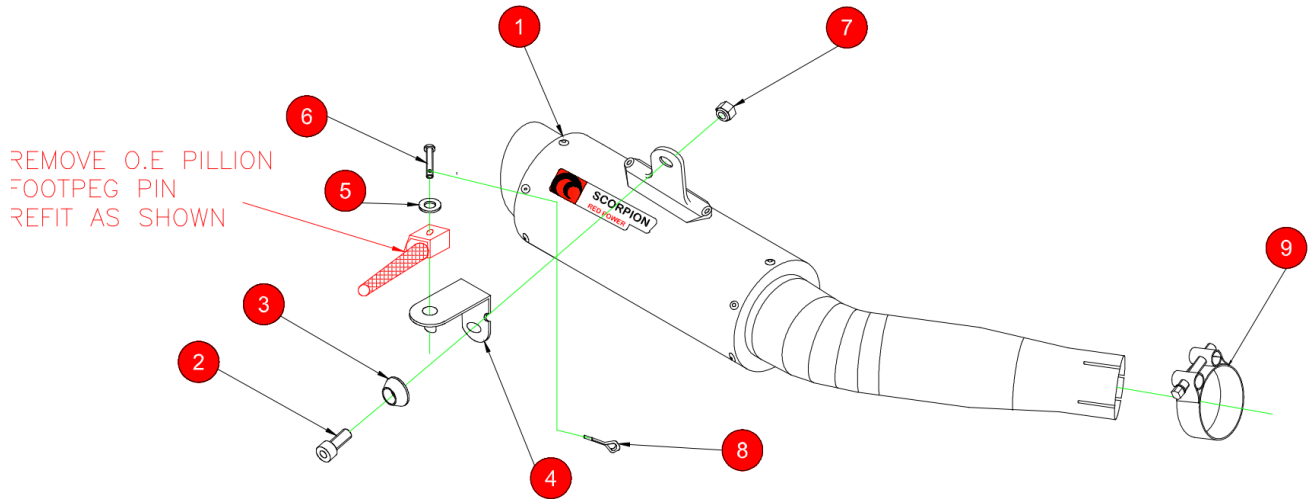

- 1 RP1-GP Silencer (SC257) with Intergrated (CP868)
- 2 M8x20mm Cap Head Bolt (Z017.10072)
- 3 Alloy Bolt Finisher (Z026.20068)
- 4 Mounting Bracket (Z015.31259)
- 5 M8x17mm Washer (Z017.10831)
- 6 M8x50mm Domehead With Hole (Z017.10006)
- 7 M8 Nyloc Nut (Z017.10062)

- 8 Split Pin (Z017.10008)
- 9 43-47mm Clamp (Z016.10008)

E-MARK	BSAU 193a 1990/t3
ISSUE NO.	04
DATE	04/08/12
AUTHORISED	M.YDLIBI
CHECKED	

NOTE: ENSURE SCORPION SYSTEM IS CLEAR OF MOVING PARTS AND ALL ORIGINAL FUNCTIONS WORK CORRECTLY.



Box: PLOCK 1

BIKE	SUZUKI GSX S 1000 inc. FA	PART NO.	SI-1009
YEAR	2015- Current	FIT KITS	Z039.10555
NOTES	Use standard fittings where not supplied Remove standard gasket if fitted.	FEATURES	N/A

CONTINUED FROM OVERLEAF:



A) Remove original exhaust from bike, taking care to keep all original components in a safe place.

B) Refit Scorpion exhaust as per line diagram above.

C) When fitted take bike for a short ride to ensure all functions are correct.

D) When bike & exhaust are cool enough check all nuts and bolts are still secure.

E) Please make sure that the bracket is in this position and the split pin is fitted as picture shows.

Box: PLOCK 1

BIKE	SUZUKI GSX S 1000 inc. FA	PART NO.	SI-1009
YEAR	2015- Current	FIT KITS	Z039.10555
NOTES	Use standard fittings where not supplied Remove standard gasket if fitted.	FEATURES	N/A

Thank you for purchasing your Scorpion Silencer.

Care of your exhaust: Please refrain from cleaning silencer with heavy solvents or abrasives!

Vielen Dank Für den kauf eines Scorpion Schalldampfers! Pflegehinweis: Bitte verwenden Sie niemals Scheuermittel oder aggressive Reiniger zur Pflege Ihres Auspuffes!

Merci d'avoir choisi un echappement Scorpion.

Entretien de votre silencieux: Ne pas utiliser de solvants ou de produits abrasifs!

Muchas gracias por adquirir un Silencioso Scorpion. Le recomendamos no limpiar el silencioso con productos abrasivos o aquellos que contengan disolventes.