

BIKE	Yamaha YZF-R1	PART NO.	RYA-85
YEAR	2009-14	FIT KITS	Z039.20417
NOTES	Use standard fittings where not supplied Remove standard gasket if fitted.	DB-Killer	2 x SCEXDBK23 - (Type V)

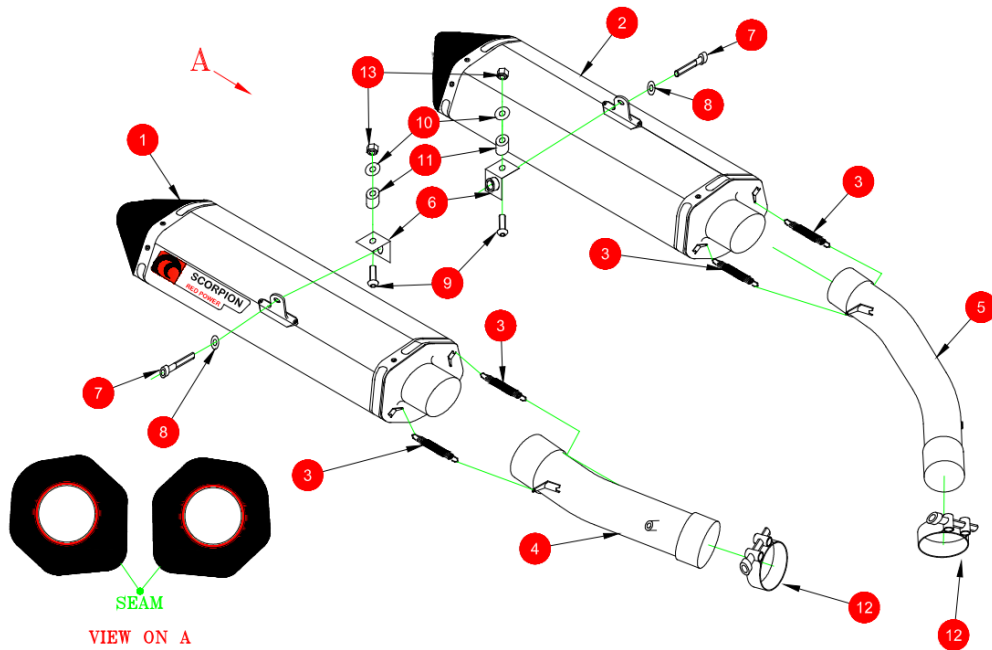

1 250mm Serket Silencer RSC205 R/H (Rotated 45°)

2 250mm Serket Silencer RSC204 L/H (Rotated 45°)

3 4 x Red Power Springs (Z028.10030)

4 Connecting Pipe R/H CP647

5 Connecting Pipe L/H CP646

6 2 x Mounting Brackets (Z015.30939)

7 2 x M8x16mm Cap Head Bolts (Z017.10808)

8 4 x M8x17mm Washers (Z017.10831)

9 2 x M8x25mm Button Head Bolts (Z017.10110)

10 2 x M8x30mm Washers (Z017.12754)

11 2 x 15mm Alloy Spacers (Z026.10005) - See Note 1

12 2 x 43-47mm Band Clamps (Z016.10008)

13 2 x M8 Nyloc Nuts (Z017.10062)

E-MARK ROUND	N/A
E-MARK OVAL	BSAU 193a 1990/t3
ISSUE NO.	04
DATE	05/08/21
AUTHORISED	M.Ydlibi
CHECKED	

NOTE: ENSURE SCORPION SYSTEM IS CLEAR OF MOVING PARTS AND ALL ORIGINAL FUNCTIONS WORK CORRECTLY.



Box: PLOCK 2

BIKE	Yamaha YZF-R1	PART NO.	RYA-85
YEAR	2009-14	FIT KITS	Z039.20417
NOTES	Use standard fittings where not supplied Remove standard gasket if fitted.	FEATURES	2 x SCEXDBK23 - (Type V)

CONTINUED FROM OVERLEAF:



A) Remove O.E exhaust from bike and remove highlighted rubber bush.

B) Install Scorpion supplied mountings.

C) Attach O.E heatshields to Scorpion link pipes, using O.E fixings.



When all the above steps have been completed ensure that all original functions are working correctly, take your bike out for a short journey, upon return allow your bike to cool before rechecking all nuts and bolts.