

Box: PLOCK 1

BIKE	HONDA CB 600 HORNET	PART NO.	EHA - 63
YEAR	1998 - 2002	FIT KITS	OVAL Z039.11033 // ROUND Z039.10033
NOTES	Seat Cowl Will Require Removing to Enable Fitment Use standard fittings where not supplied Remove standard gasket if fitted.	DB-Killer	SCEXDBK12 - (Type B)

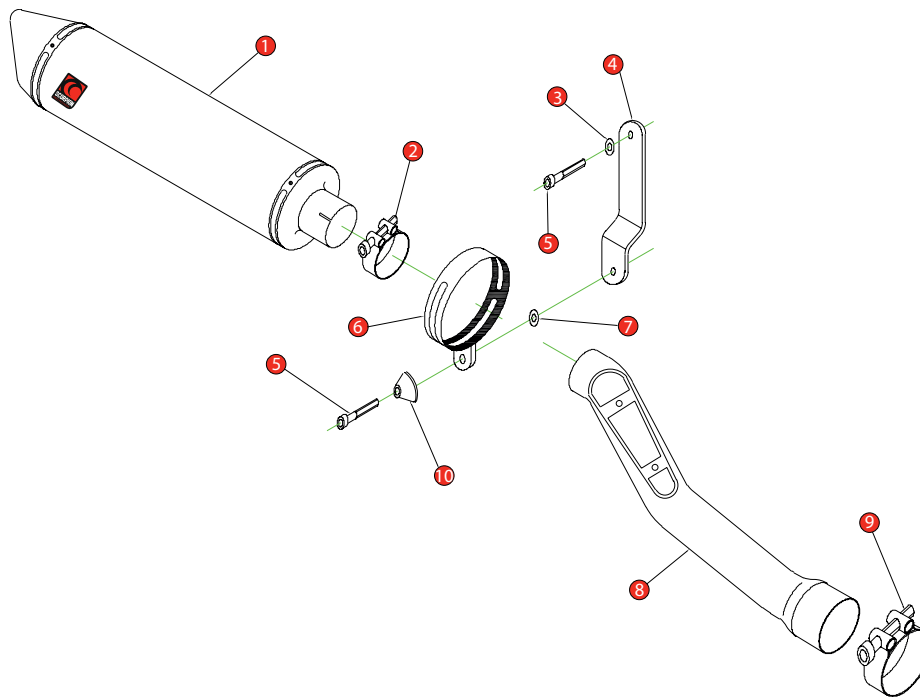

1 400mm Silencer ESC 51	8 Connecting Pipe CP 102
2 51-55mm Band Clamp (Z016.10002)	9 43 -47mm Band Clamp (Z016.10008)
3 M8 x 17 washer (Z017.10831)	10 Aluminium Bolt Finisher (Z026.20068)
4 Mounting bracket (Z015.10004)	
5 2 x M8 x 16mm Cap head bolts (Z017.10808)	
6 Composite Silencer Strap (R-Z038.10090) (O-Z038.10088)	
7 M8 x 25mm Washer (Z017.10825)	

E-MARK ROUND	SCDB-RS e4 2035
E-MARK OVAL	SCDB-OS e4 2072
ISSUE NO.	09
DATE	18/10/2018
AUTHORISED	J.Harkin
CHECKED	

NOTE: ENSURE SCORPION SYSTEM IS CLEAR OF MOVING PARTS AND ALL ORIGINAL FUNCTIONS WORK CORRECTLY.

A) Remove original exhaust from bike, taking care to keep all original components in a safe place.

B) Refit Scorpion exhaust as per line diagram above.

C) When fitted take bike for a short ride to ensure all functions are correct.

D) When bike & exhaust are cool enough check all nuts and bolts are still secure.