

Box: PLOCK 2

BIKE	Yamaha YZF-R1	PART NO.	EYA-59
YEAR	1998-01	FIT KITS	OVAL Z039.11127 / ROUND Z039.10127
NOTES	Use standard fittings where not supplied <b>Remove standard gasket if fitted.</b>	DB-Killer	SCEXDBK12 - (Type B)

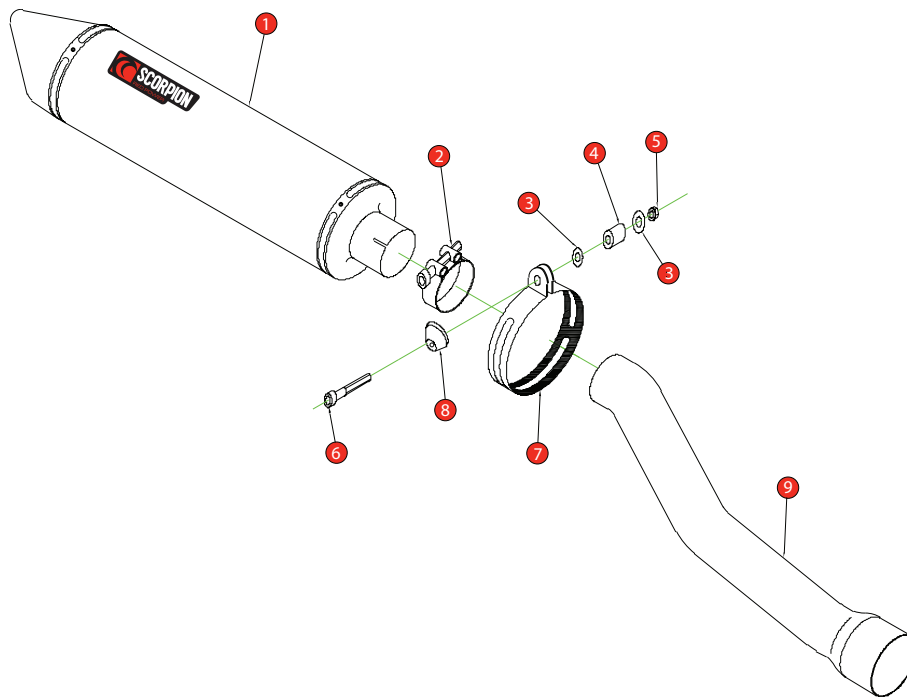

- |   |  |
|---|--|
| 1 450mm Silencer ESC 50                                 | 8 Aluminium Bolt Finisher (Z026.20068) |
| 2 51-55mm Band Clamp (Z016.10002)                       | 9 Connecting Pipe CP 18                |
| 3 M8 x 25mm Washers (Z017.10825)                        |  |
| 4 10mm Aluminium Spacer (Z026.10004)                    |  |
| 5 M8 Nyloc Nut (Z017.10062)                             |  |
| 6 M8 x 60mm Cap Head Bolt (Z017.10080)                  |  |
| 7 Composite Silencer Strap (R-Z038.10090)(O-Z038.10088) |  |

E-MARK ROUND	BSAU 193a 1990/t3
E-MARK OVAL	BSAU 193a 1990/t3
ISSUE NO.	12
DATE	05/08/21
AUTHORISED	M.Ydlibi
CHECKED	

**NOTE:** ENSURE SCORPION SYSTEM IS CLEAR OF MOVING PARTS AND ALL ORIGINAL FUNCTIONS WORK CORRECTLY.

A) Remove original exhaust from bike, taking care to keep all original components in a safe place.

B) Refit Scorpion exhaust as per line diagram above.

C) When fitted take bike for a short ride to ensure all functions are correct.

D) When bike & exhaust are cool enough check all nuts and bolts are still secure.