

BIKE	KTM Duke 390	PART NO.	RKT-81
YEAR	2013-16	FIT KITS	Z039.10575
NOTES	Use standard fittings where not supplied <b>Remove standard gasket if fitted.</b>	DB-Killer	SCEXDBK23 - (Type V)

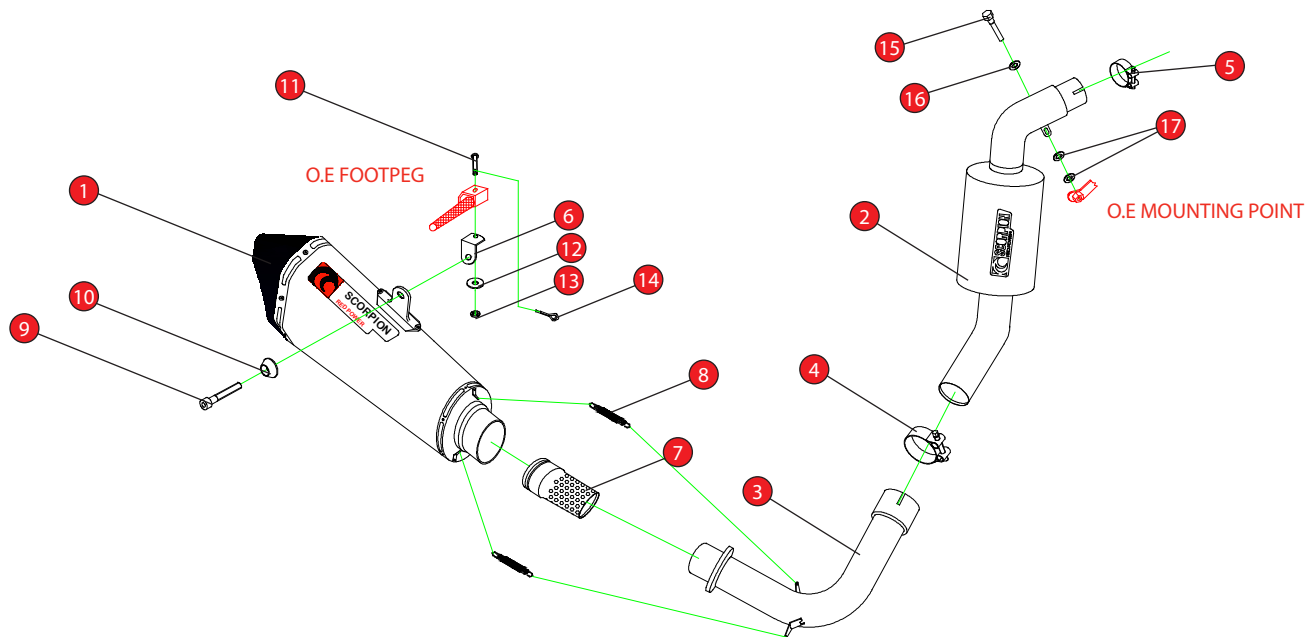

- |   |  |
|---|--|
| 1 Serket Taper RSC231                     | 12 M8 x 25mm Washer (Z017.10825)         |
| 2 Connecting Pipe 894                     | 13 M8 Spring Washer (Z017.10064)         |
| 3 Connecting Pipe 895                     | 14 Split Pin (Z017.10008)                |
| 4 51-55mm Clamp (Z016.10002)              | 15 M6 x 20mm Hex Head Screw (Z017.10611) |
| 5 43-47mm Clamp (Z016.10008)              | 16 M6 x 17mm Washer (Z017.12722)         |
| 6 Mounting Bracket (Z015.31249)           | 17 2 x Fibre Washer (Z017.12748)         |
| 7 Closed End Flute (Z028.20188)           |  |
| 8 2 x Rubber Coated Spring (Z028.10030)   |  |
| 9 M8 x 25mm Cap Head Screw (Z017.10073)   |  |
| 10 Alloy Bolt Finisher (Z026.20068)       |  |
| 11 M8 x 50mm Dome Head Screw (Z017.10006) |  |

E-MARK	BSAU 193a 1990/t3
ISSUE NO.	01
DATE	18/10/2018
AUTHORISED	J.Harkin
CHECKED	

**NOTE:** ENSURE SCORPION SYSTEM IS CLEAR OF MOVING PARTS AND ALL ORIGINAL FUNCTIONS WORK CORRECTLY.



Box: P-LOCK 2

BIKE	KTM Duke 390	PART NO.	RKT-81
YEAR	2013 - ON	FIT KITS	Z039.10575
NOTES	Use standard fittings where not supplied <b>Remove standard gasket if fitted.</b>	FEATURES	

Thank you for purchasing your Scorpion Silencer.

Care of your exhaust: Please refrain from cleaning silencer with heavy solvents or abrasives!

Vielen Dank Für den kauf eines Scorpion Schalldampfers! Pflegehinweis: Bitte verwenden Sie niemals Scheuermittel oder aggressive Reiniger zur Pflege Ihres Auspuffes!

Merci d'avoir choisi un echappement Scorpion.

Entretien de votre silencieux: Ne pas utiliser de solvants ou de produits abrasifs!

"Muchas gracias por adquirir un Silencioso Scorpion. Le recomendamos no limpiar el silencioso con productos abrasivos o aquellos que contengan disolventes."