

<b>Bike</b>	Royal Enfield Meteor 350	<b>Part No.</b>	PRE-102
<b>Year</b>	2020 - Current	<b>Fit Kit</b>	Z039.10718
<b>Notes</b>	Where not supplied use original fittings. Remove OE Gasket	<b>dB Killer</b>	SCEXDBK48 - (TYPE PC)

Estimated Fitting Time: 15 Minutes

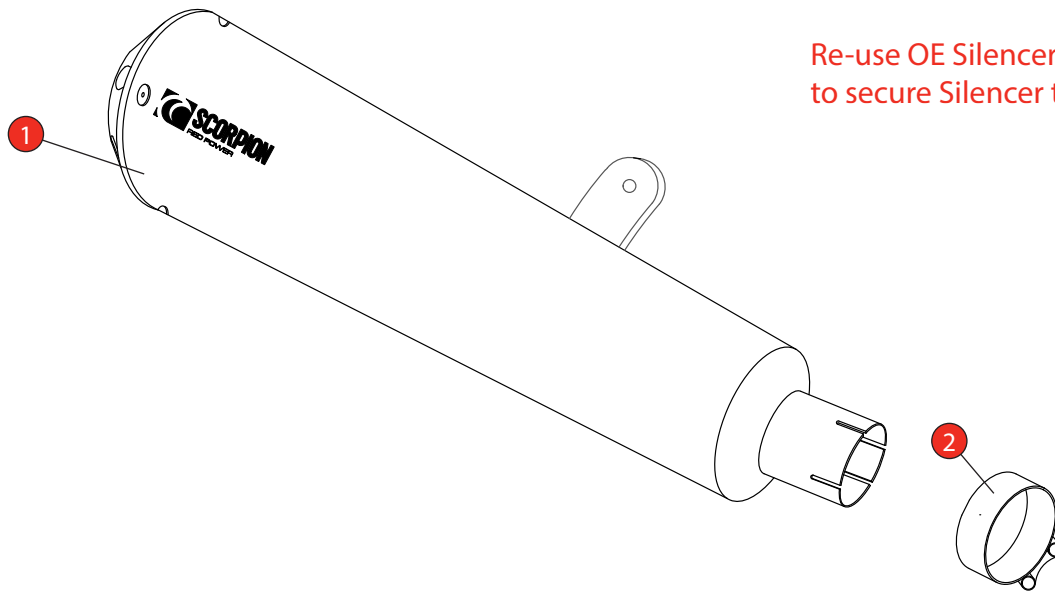

NO.	PART NO.	DESCRIPTION	QTY
1	PSC513	Red Power Silencer	1
<b>Fit Kit - Z039.10718</b>			
2	Z028.10007	40-43mm Clamp	1

CLASSIFICATION	Closed Circuit Product
HOMOLOGATED	NO
DATE	26/09/2022
ISSUE	00
AUTHORISED	S Shipley

**NOTE:** ENSURE SCORPION SYSTEM IS CLEAR OF MOVING PARTS AND ALL ORIGINAL FUNCTIONS WORK CORRECTLY.

STAY CONNECTED TO RED POWER.

<b>Bike</b>	Royal Enfield Meteor 350	<b>Part No.</b>	PRE-102
<b>Year</b>	2020 - Current	<b>Fit Kit</b>	Z039.10718
<b>Notes</b>	Where not supplied use original fittings. Remove OE Gasket	<b>dB Killer</b>	SCEXDBK48 - (TYPE PC)



A) Start by loosening the clamp between the rear silencer and the connecting pipe.

B) Loosen and remove the nut on the back of the rear silencer mounting.

C) Support the weight of the silencer with one hand, then remove the mounting bolt.

D) Carefully remove the silencer, clamp and gasket from the bike and store in a safe place.

E) Place the supplied clamp onto the end of the Scorpion silencer.

F) Slide the Scorpion silencer on to the original connecting pipe and align the mounting bracket with the original mounting point on the frame.

G) Use the original mounting bolt and nut to secure the Scorpion silencer to the frame. Do this finger tight to begin with, adjust the silencer to the correct position and then fully tighten.

H) Now tighten the clamp between the silencer and the connecting pipe.

Take the bike for a short ride to ensure it functions as it should. Once the bike and exhaust are cool enough check all nuts, bolts and clamps are still secure.



<b>Bike</b>	Royal Enfield Meteor 350	<b>Part No.</b>	PRE-102
<b>Year</b>	2020 - Current	<b>Fit Kit</b>	Z039.10718
<b>Notes</b>	Where not supplied use original fittings. Remove OE Gasket	<b>dB Killer</b>	SCEXDBK48 - (TYPE PC)

Estimated Fitting Time: 15 Minutes



Thank you for purchasing your Scorpion Silencer.  
Care of your exhaust: Please refrain from cleaning silencer with heavy solvents or abrasives!

Vielen Dank Für den kauf eines Scorpion Schalldampfers! Pflegehinweis: Bitte verwenden Sie niemals Scheuermittel oder aggressive Reiniger zur Pflege Ihres Auspuffes!

Merci d'avoir choisi un echappement Scorpion.  
Entretien de votre silencieux: Ne pas utiliser de solvants ou de produits abrasifs!

Muchas gracias por adquirir un Silencioso Scorpion. Le recomendamos no limpiar el silencioso con productos abrasivos o aquellos que contengan disolventes.



STAY CONNECTED TO RED POWER.