

Box: PLOCK 1

BIKE	SUZUKI 650 GLADIUS	PART NO.	RSI -105
YEAR	2009 - 2016	FIT KITS	Z039.20423
NOTES	Use standard fittings where not supplied Remove standard gasket if fitted.	DB-Killer	SCEXDBK23 - (Type V)

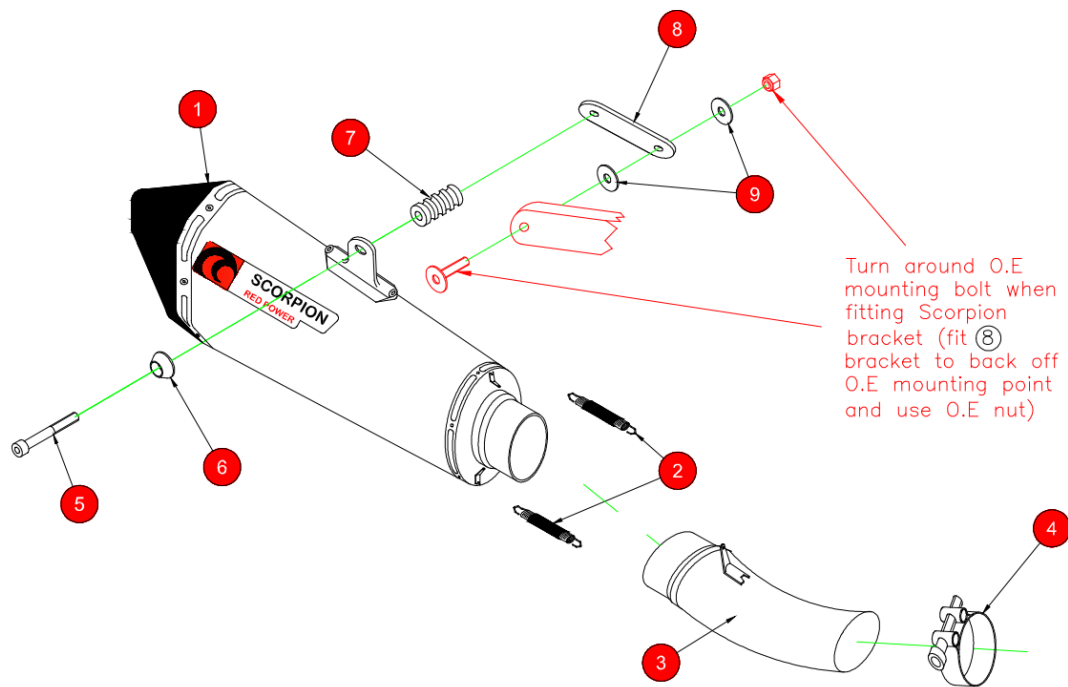

1 275mm Serket Silencer RSC231
 2 2 Red Power Springs (Z028.10030)
 3 Connecting Pipe CP639
 4 40-43mm Band Clamp (Z016.10007)
 5 M8 x 65 Cap Head Bolt (Z017.10081)
 6 Alloy Bolt Finisher (Z026.10068)
 7 20 x 65mm Spacer (Z026.20099)

8 Mounting Bracket (Z015.10077)
 9 2 x M8x25mm Washers (Z017.10825)

E-MARK ROUND	
E-MARK OVAL	BSAU 193a 1990/t3
ISSUE NO.	07
DATE	22/09/21
AUTHORISED	M.Ydlibi
CHECKED	

NOTE: ENSURE SCORPION SYSTEM IS CLEAR OF MOVING PARTS AND ALL ORIGINAL FUNCTIONS WORK CORRECTLY.



A) Remove original exhaust from bike, taking care to keep all original components in a safe place.

B) Refit Scorpion exhaust as per line diagram above.

C) When fitted take bike for a short ride to ensure all functions are correct.

D) When bike & exhaust are cool enough check all nuts and bolts are still secure.