

|              |   |                  |                      |
|--------------|---|------------------|----------------------|
| <b>Bike</b>  | Suzuki GSX-R600 / GSX-R750                | <b>Part No.</b>  | RSI128               |
| <b>Year</b>  | 2006-2007                                 | <b>Fit Kit</b>   | Z039.10726           |
| <b>Notes</b> | Where not supplied use original fittings. | <b>dB Killer</b> | SCEXDBK24 - (Type W) |

Estimated Fitting Time: 60 Minutes

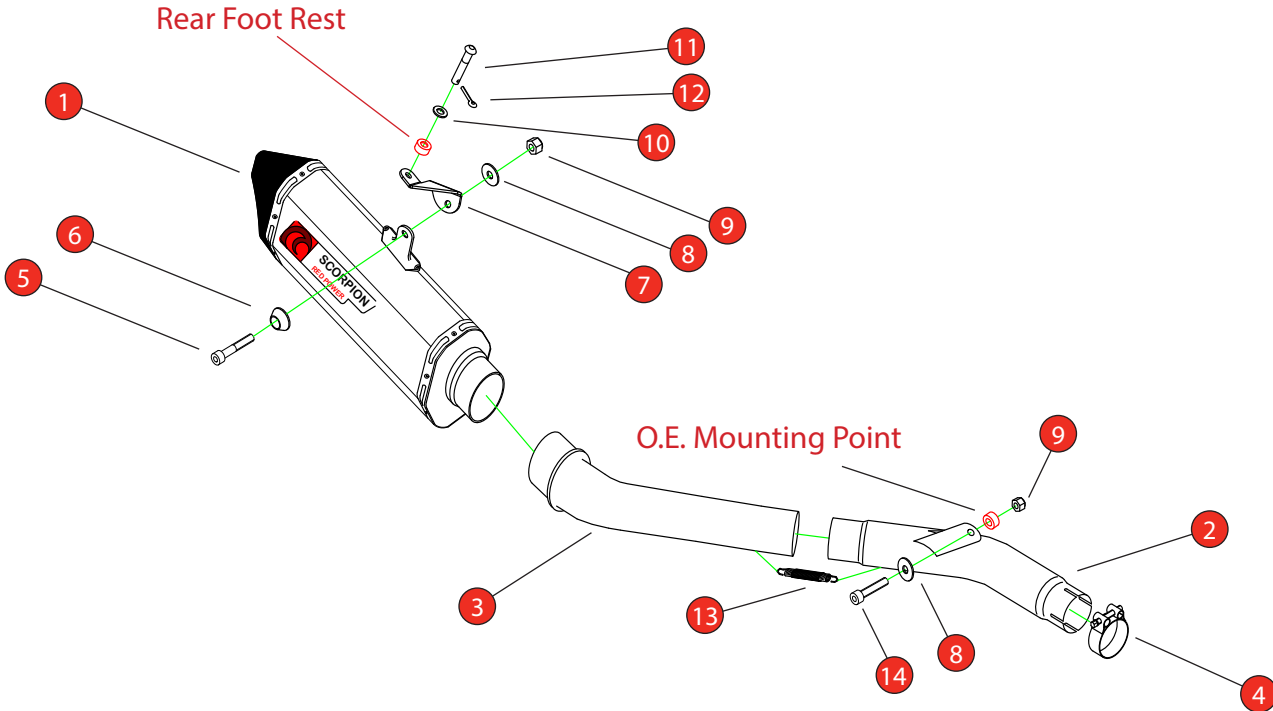

| NO.                         | PART NO.   | DESCRIPTION                                    | QTY |
|-----------------------------|------------|--|-----|
| 1                           | RSC493     | Serket Parallel Silencer                       | 1   |
| 2                           | CP1178     | Connecting Pipe                                | 1   |
| 3                           | CP1179     | Connecting Pipe                                | 1   |
| <b>Fit Kit - Z039.10726</b> |            |  |     |
| 4                           | Z016.10002 | 51-55mm Clamp                                  | 1   |
| 5                           | Z017.10072 | M8 x 20mm Caphead Bolt                         | 1   |
| 6                           | Z026.20068 | Alloy Bolt Finisher                            | 1   |
| 7                           | Z015.31563 | Silencer Mounting Bracket                      | 1   |
| 8                           | Z017.10825 | M8 x 25mm Washer                               | 2   |
| 9                           | Z017.10062 | M8 Nyloc Nut                                   | 2   |
| 10                          | Z017.10831 | M8 x 17mm Washer                               | 1   |
| 11                          | Z017.10007 | M8 x 45mm Button Head Bolt with Split Pin Hole | 1   |
| 12                          | Z017.10008 | Ø3mm x 20mm Split Pin                          | 1   |
| 13                          | Z028.10030 | Rubber Sleeved Spring                          | 1   |
| 14                          | Z017.10076 | M8 x 40mm Caphead Bolt                         | 1   |

|                |                        |
|----------------|------------------------|
| CLASSIFICATION | Closed Circuit Product |
| HOMOLOGATED    | No                     |
| DATE           | 03/08/2023             |
| ISSUE          | 00                     |
| AUTHORISED     | S Shipley              |

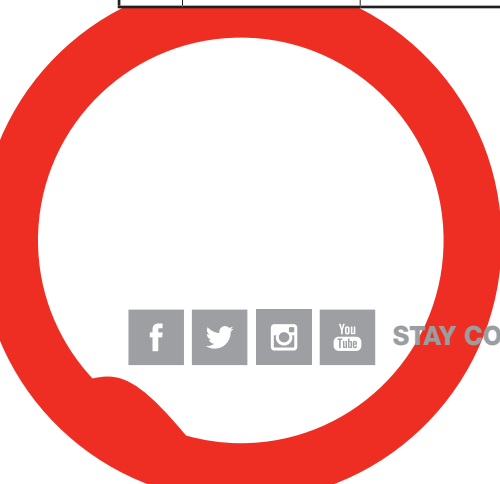

STAY CONNECTED TO RED POWER.

|              |   |                  |                      |
|--------------|---|------------------|----------------------|
| <b>Bike</b>  | Suzuki GSX-R600 / GSX-R750                | <b>Part No.</b>  | RSI128               |
| <b>Year</b>  | 2006-2007                                 | <b>Fit Kit</b>   | Z039.10726           |
| <b>Notes</b> | Where not supplied use original fittings. | <b>dB Killer</b> | SCEXDBK24 - (Type W) |

Estimated Fitting Time: 60 Minutes



A) Remove original exhaust from bike, taking care to keep all original components in a safe place.

B) Refit Scorpion exhaust as per line diagram on first page.

C) When fitted take bike for a short ride to ensure all functions are correct.

D) When bike & exhaust are cool enough check all nuts and bolts are still secure.

Thank you for purchasing your Scorpion Silencer.

Care of your exhaust: Please refrain from cleaning silencer with heavy solvents or abrasives!

Vielen Dank Für den kauf eines Scorpion Schalldampfers! Pflegehinweis: Bitte verwenden Sie niemals Scheuermittel oder aggressive Reiniger zur Pflege Ihres Auspuffes!

Merci d'avoir choisi un echappement Scorpion.

Entretien de votre silencieux: Ne pas utiliser de solvants ou de produits abrasifs!

Muchas gracias por adquirir un Silencioso Scorpion. Le recomendamos no limpiar el silencioso con productos abrasivos o aquellos que contengan disolventes.



STAY CONNECTED TO RED POWER.