

Box: PLOCK 1

BIKE	SUZUKI SV 650 HIGH LEVEL	PART NO.	ESI - 75
YEAR	2003	FIT KITS	OVAL Z039.11082 // ROUND Z039.10082
NOTES	Item 7 required to re-fit OE exhaust system	DB-Killer	SCEXDBK12 - (Type B)

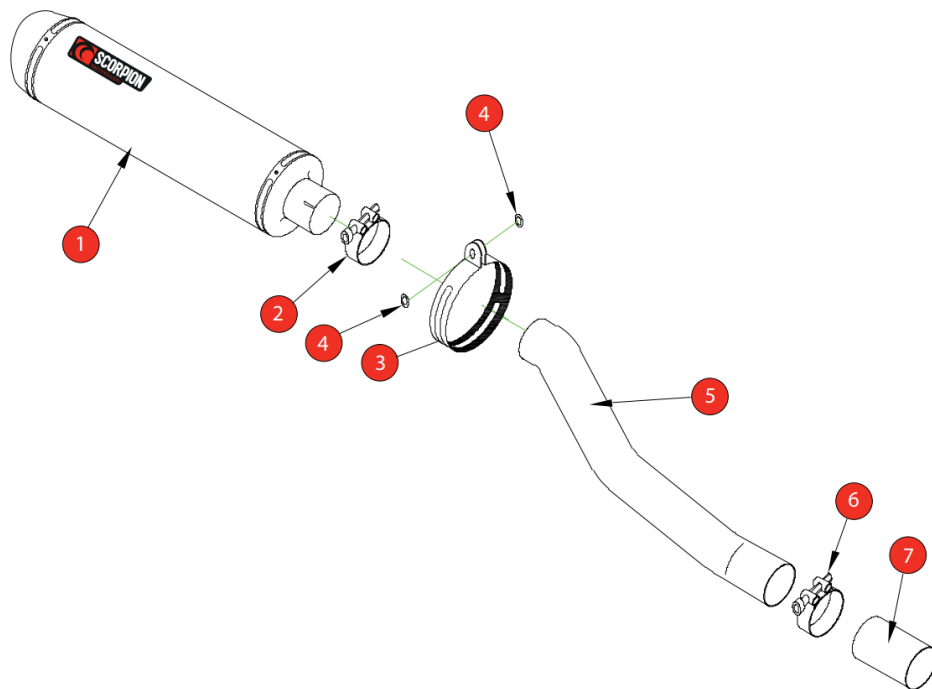

1 450mm Silencer ESC 94	8 Original Silencer Cut Diagram
2 51-55mm Band Clamp (Z016.10002)	
3 Composite Silencer Strap (R-Z038.10089)(O-Z038.10088)	
4 2 x M8 x 25mm Washers (Z017.10825)	
5 Connecting Pipe CP 325	
6 55-59mm Band Clamp (Z016.10004)	
7 Re-connecting Sleeve CP327	

E-MARK	BSAU 193a 1990/t3
ISSUE NO.	12
DATE	04/08/21
AUTHORISED	M.Ydlibi
CHECKED	

NOTE: ENSURE SCORPION SYSTEM IS CLEAR OF MOVING PARTS AND ALL ORIGINAL FUNCTIONS WORK CORRECTLY.

A) Remove original exhaust from bike, taking care to keep all original components in a safe place.

B) Refit Scorpion exhaust as per line diagram above.

C) When fitted take bike for a short ride to ensure all functions are correct.

D) When bike & exhaust are cool enough check all nuts and bolts are still secure.