

Bike	Kawasaki Z1000 SX	Part No.	KA-1014
Year	2014-16	Fit Kit	Z039.10523
Notes	OEM Gaskets MUST be re-used for both Connecting Pipes.	dB Killer	2 x SCEXDBK28 - (Type EE)

Estimated Fitting Time: 60 Minutes

DO NOT FIT WITH PANNIERS

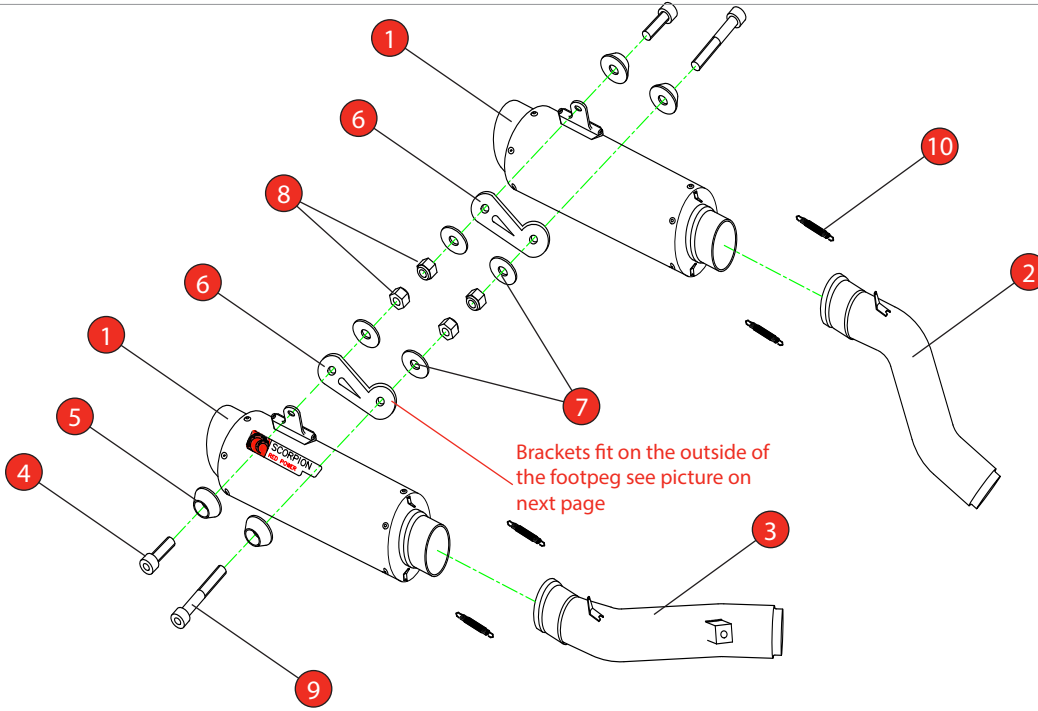

NO.	PART NO.	DESCRIPTION	QTY
1	SC287	RP1-GP Silencer	2
2	CP623	L/H Connecting Pipe	1
3	CP624	R/H Connecting Pipe	1
Fit Kit - Z039.10523			
4	Z017.10073	M8 x 25mm Cap Head Bolt	2
5	Z026.20068	Alloy Bolt Finisher	4
6	Z015.31049	Mounting Bracket	2
7	Z017.10825	M8 x 25mm Washer	4
8	Z017.10062	M8 Nyloc Nut	4
9	Z017.10079	M8 x 55mm Cap Head Bolt	2
10	Z028.10030	Rubber Coated Spring	4

E-MARK	SC287 d24 d298 9 0
DATE	18/10/2018
ISSUE	01
AUTHORISED	J.Harkin

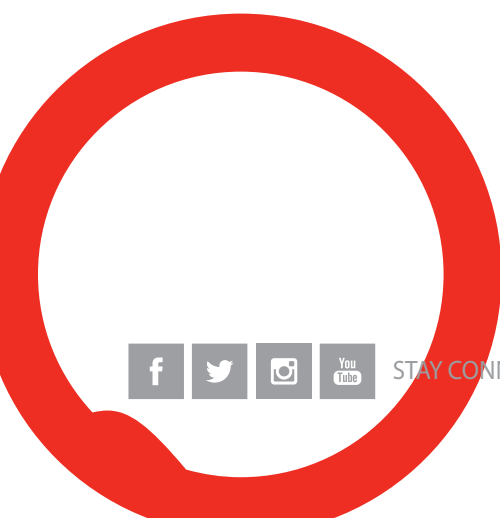

STAY CONNECTED TO RED POWER.

Bike	Kawasaki Z1000 SX	Part No.	KA-1014
Year	2014-Current	Fit Kit	Z039.10523
Notes	OEM Gaskets MUST be re-used for both Connecting Pipes.	dB Killer	2 x SCEXDBK28 - (Type EE)

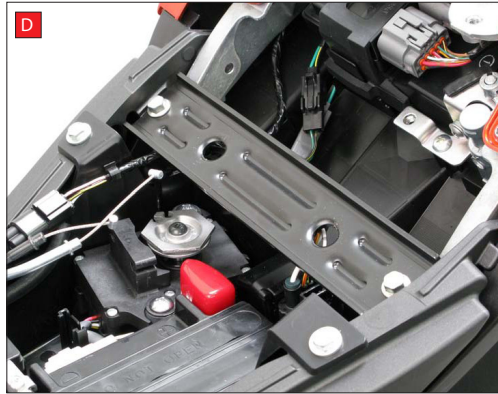

NOTE:
THESE INSTRUCTONS ARE ONLY
REQUIRED WHEN FITTING TO A
POST 2017 MODEL

- A) Unscrew heatshield bolt and remove right hand heatshield.
- B) Remove passenger seat then unscrew riders seat and remove it.
- C) Remove the saftey pin and unhook the exhaust valve cables from the servo motor wheel.

NOTE:
HOLD THE SERVO WHEEL IN
PLACE WHILST REMOVING
THE TWO CABLES. NEVER
DISCONNECT THE ELECTRICAL
MULTIPLUG FROM THE SERVO
MOTOR. FAILURE TO ADHERE TO
THESE INSTRUCTIONS COULD
RESULT IN DAMAGE TO THE
SERVO MOTOR.

D) Carefuy thread through frame so the cables are removed with the right hand silencer, SEE NOTE ABOVE.

E) Follow the line diagram above to fit the exhaust, the mounting brackets sit on the outside of the footpegs.

F) When fitted take bike for a short ride to ensure all functions are correct.

G) When bike & exhaust are cool enough check all nuts and bolts are still secure.

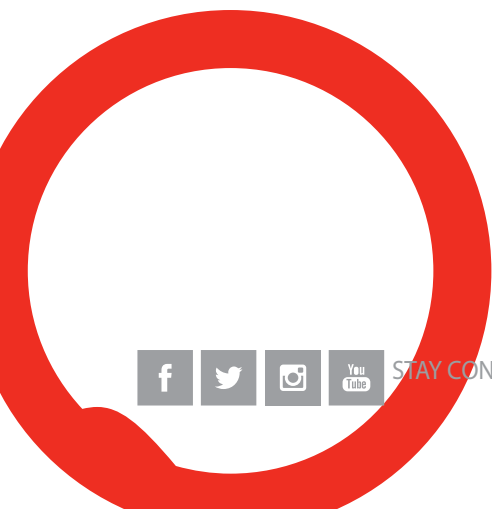

Bike	Kawasaki Z1000 SX	Part No.	KA-1014
Year	2014-Current	Fit Kit	Z039.10523
Notes	OEM Gaskets MUST be re-used for both Connecting Pipes.	dB Killer	2 x SCEXDBK28 - (Type EE)



Thank you for purchasing your Scorpion Silencer.

Care of your exhaust: Please refrain from cleaning silencer with heavy solvents or abrasives!

Vielen Dank Für den kauf eines Scorpion Schalldampfers! Pflegehinweis: Bitte verwenden Sie niemals Scheuermittel oder aggressive Reiniger zur Pflege Ihres Auspuffes!

Merci d'avoir choisi un echappement Scorpion.

Entretien de votre silencieux: Ne pas utiliser de solvants ou de produits abrasifs!

Muchas gracias por adquirir un Silencioso Scorpion. Le recomendamos no limpiar el silencioso con productos abrasivos o aquellos que contengan disolventes.



STAY CONNECTED TO RED POWER.