

Box: PLOCK 2

BIKE	YAMAHA YZF 1000 R1	PART NO.	RYA-81-CR
YEAR	2007 - 2008	FIT KITS	OVAL Z039.20446
NOTES	Where not supplied use original fittings	FEATURES	DE-CAT

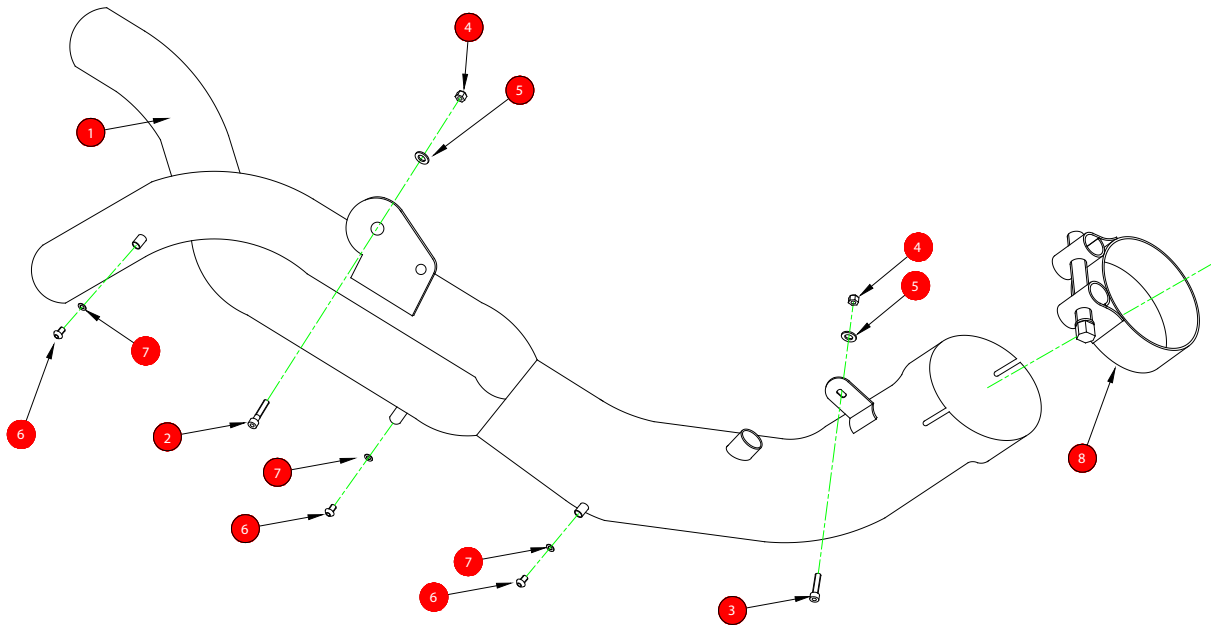

- | | |
|---------------------------------------|-----------------------------------|
| 1 Connecting Pipe CP673 | 8 63-68mm Band Clamp (Z016.10005) |
| 2 M8x40 Cap Head Bolt (Z017.10076) | |
| 3 M8x35 Cap Head Bolt (Z017.10075) | |
| 4 2 x M8 Nyloc Nuts (Z017.10062) | |
| 5 2 x M8x17mm Washers (Z017.10068) | |
| 6 3 x M6x10 Button Heads (Z017.12707) | |
| 7 3 x M6x10mm Washers (Z017.10617) | |

E-MARK	RACE USE ONLY
ISSUE NO.	2
DATE	03/04/14
AUTHORISED	T. Rowley
CHECKED	

NOTE: ENSURE SCORPION SYSTEM IS CLEAR OF MOVING PARTS AND ALL ORIGINAL FUNCTIONS WORK CORRECTLY.

A) Remove original exhaust from bike, taking care to keep all original components in a safe place.

B) Refit Scorpion exhaust as per line diagram above.

C) When fitted take bike for a short ride to ensure all functions are correct.

D) When bike & exhaust are cool enough check all nuts and bolts are still secure.