

Bike	Kawasaki Z800 e	Part No.	RKA-101
Year	2013-16	Fit Kit	Z039.10503
Notes	Where not supplied use original fittings. Remove O.E gasket before fitting connecting pipe.	dB Killer	SCEXDBK23 - (Type V)

Estimated Fitting Time: 60 Minutes

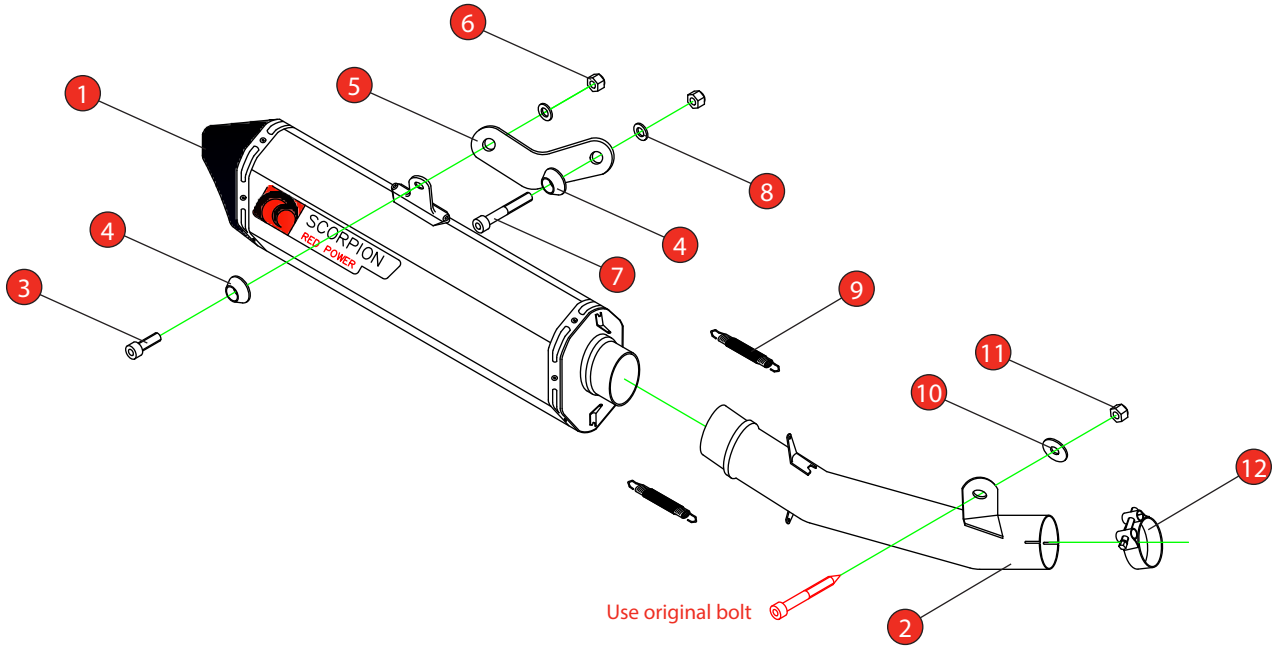

NO.	PART NO.	DESCRIPTION	QTY
1	RSC260	Serket Parallel Silencer	1
2	CP749	Connecting Pipe	1
Fit Kit - Z039.10503			
3	Z017.10073	M8 x 25mm Cap Head Screw	1
4	Z026.20068	Alloy Bolt Finisher	2
5	Z015.30941	Mounting Bracket	1
6	Z017.10062	M8 Nyloc Nut	2
7	Z017.10079	M8 x 55mm Cap Head Screw	1
8	Z017.10825	M8 x 25mm Washer	2
9	Z028.10030	Rubber Coated Springs	2
10	Z017.11014	M10 x 25mm Washer	1
11	Z017.11018	Fine Thread M10 Nyloc Nut	1
12	Z016.10003	47-51mm Clamp	1

E-MARK	RSC260 e4 2460 9 O
DATE	18/10/2018
ISSUE	02
AUTHORISED	J.Harkin

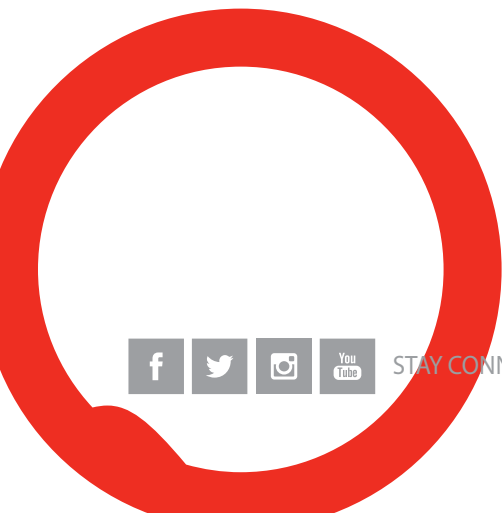

STAY CONNECTED TO RED POWER.

Bike	Kawasaki Z800 e	Part No.	RKA-101
Year	2013-Current	Fit Kit	Z039.10503
Notes	Where not supplied use original fittings. Remove O.E gasket before fitting connecting pipe.	dB Killer	SCEXDBK23 - (Type V)

Estimated Fitting Time: 60 Minutes



A) Remove original exhaust from bike, taking care to keep all original components in a safe place.

B) Refit Scorpion exhaust as per line diagram above.

C) When fitted take bike for a short ride to ensure all functions are correct.

D) When bike & exhaust are cool enough check all nuts and bolts are still secure.

Thank you for purchasing your Scorpion Silencer.

Care of your exhaust: Please refrain from cleaning silencer with heavy solvents or abrasives!

Vielen Dank Für den kauf eines Scorpion Schalldampfers! Pflegehinweis: Bitte verwenden Sie niemals Scheuermittel oder aggressive Reiniger zur Pflege Ihres Auspuffes!

Merci d'avoir choisi un echappement Scorpion.

Entretien de votre silencieux: Ne pas utiliser de solvants ou de produits abrasifs!

Muchas gracias por adquirir un Silencioso Scorpion. Le recomendamos no limpiar el silencioso con productos abrasivos o aquellos que contengan disolventes.



STAY CONNECTED TO RED POWER.