

BIKE	HONDA CBR 1000 RR	PART NO.	HA-1000
YEAR	2008 - 2011	FIT KITS	Z039.20441
NOTES	Use standard fittings where not supplied Remove standard gasket if fitted.	DB-Killer	SCEXDBK22 - (Type Z)

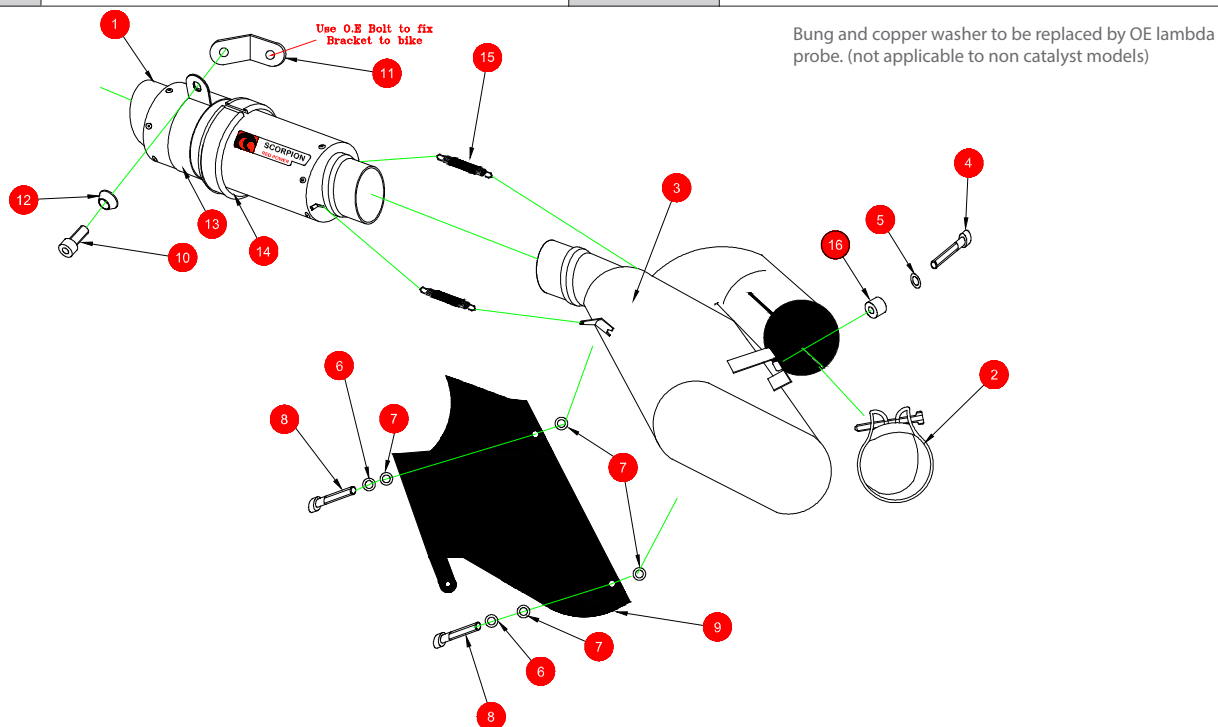

- | | |
|---|---|
| 1 RP-1GP Silencer SC226 | 10 M8 x 20mm Cap Head (Z017.10072) |
| 2 51-55mm Band Clamp (Z016.10002) | 11 Mounting Bracket (Z015.30942) |
| 3 Connecting Box CP668 | 12 Alloy Bolt Finisher (Z026.20068) |
| 4 M8 x 30mm Cap Head (Z017.10074) | 13 Titanium Silencer Strap (Z028.10013) |
| 5 M8 x 17mm Washer (Z017.10831) | 14 Square Edge Rubber (Z029.10024) |
| 6 2 x M6 Star Washers (Z017.10614) | 15 Rubber Coated Springs (Z028.10030) |
| 7 4 x Nylon Washers (Z017.12748) | 16 15mm Alloy Spacer (Z026.10005) |
| 8 2 x M6 x 10mm Button Heads (Z017.12707) | Heat Shield Left and Right Hand (Z028.10220 & Z028.10219) |
| 9 Carbon Fibre Fairing (Z028.10214) | |

E-MARK BOX	HA-95 [e4] 2295 5 9
E-MARK	HA-95 [e4] 2295 9
ISSUE NO.	04
DATE	16/10/2018
AUTHORISED	J.Harkin
CHECKED	

NOTE: ENSURE SCORPION SYSTEM IS CLEAR OF MOVING PARTS AND ALL ORIGINAL FUNCTIONS WORK CORRECTLY.



A) Remove original exhaust from bike, taking care to keep all original components in a safe place.

B) Refit Scorpion exhaust as per line diagram above.

C) When fitted take bike for a short ride to ensure all functions are correct.

D) When bike & exhaust are cool enough check all nuts and bolts are still secure.

BIKE	HONDA CBR 1000 RR	PART NO.	HA-1000
YEAR	2008 - 2011	FIT KITS	Z039.20441
NOTES	Bung and copper washer to be replaced by OE lambda probe. (not applicable to non catalyst models)	FEATURES	

CONTINUED FROM OVERLEAF:

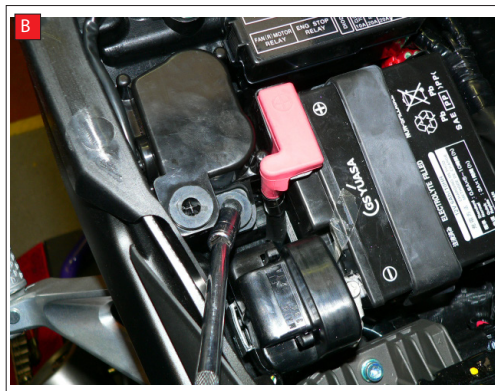

A) Remove 2 x side panels to allow seat to be removed.

B) With seat removed you can now gain access to unbolt the servo, DO NOT DISCONNECT SERVO.

C) You can now disconnect the servo cable, and then re-fit the servo unit.

D) To allow access unbolt lower fairing on left hand side of bike, this will then allow you to remove the lambda sensor.

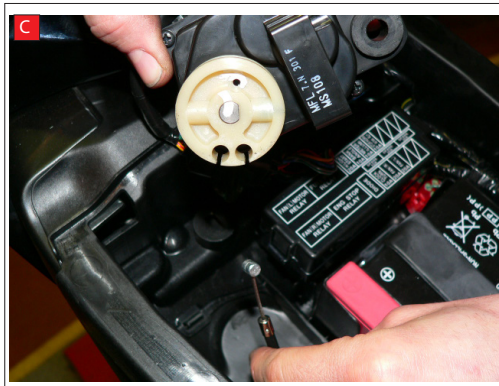

E) Undo the clamp holding the O.E exhaust silencer.

F) Remove the bolt holding O.E silencer to footrest.

G) The O.E silencer now can be removed from the bike.

H) Take the supplied heat mat and fit inside of the fairing.



Box: PLOCK 1

BIKE	HONDA CBR 1000 RR	PART NO.	HA-1000
YEAR	2008 - 2011	FIT KITS	Z039.20441
NOTES	Bung and copper washer to be replaced by OE lambda probe. (not applicable to non catalyst models)	FEATURES	

CONTINUED FROM OVERLEAF:

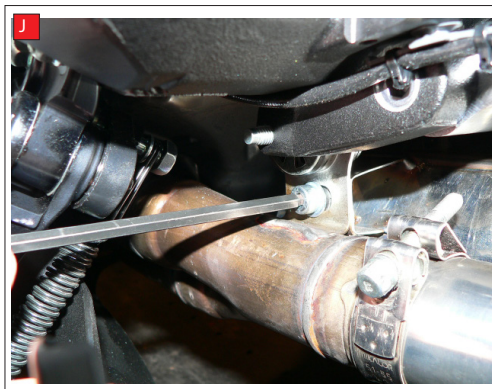

I) Slide the underbelly box onto the original pipework and tighten up the clamp.

J) Tighten up the bolt into mounting bracket.

K) For cat model bikes, re fit lambda sensor in mounting boss and tighten.
For none cat models, use the bung provided to put into the lambda boss and tighten up.

With the underbelly box, lambda sensor on and all tightened up you can now fasten the fairing back into place.



L) Fit the Scorpion silencer onto the outlet of the underbelly box.

M) Bolt through bracket onto footrest. When silencers are aligned tighten both the clamp and bracket.

N) Fit scorpion supplied infill panel and tighten up 3 bolts. Ensuring that 2 holes under silencer are aligned first. Fibre washers **MUST** be used between panel and underbelly silencer.

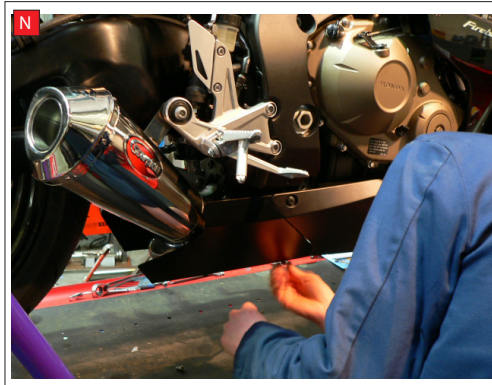

When all the above steps have been completed double check all nuts and bolts are tight and that all original bike functions are not impaired. When satisfied fitment is correct take your bike for a short run to ensure system is sealed correctly and there are no gas leaks. After a short run, allow your bike to cool and check all nuts and bolts are tight.