

Box: PLOCK 1

BIKE	HONDA CBF 600	PART NO.	EHA - 100
YEAR	2008 - 2014	FIT KITS	OVAL Z039.11298 // ROUND Z039.10298
NOTES	Use standard fittings where not supplied Remove standard gasket if fitted.	DB-Killer	SCEXDBK12 - (Type B)

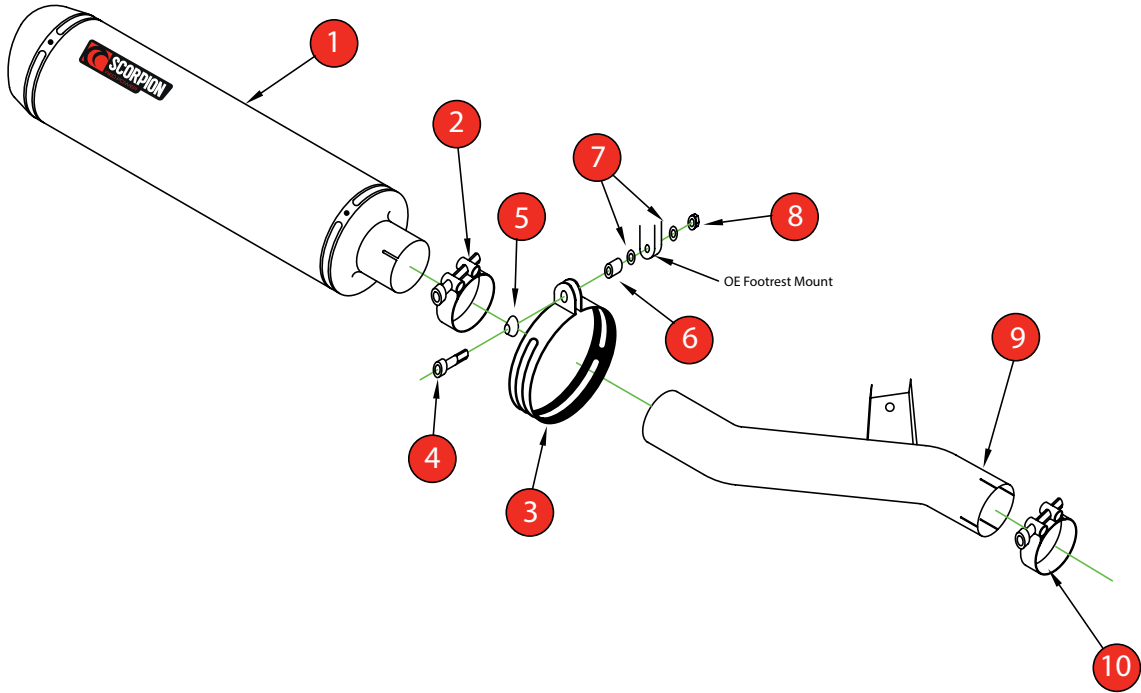

- |   |                                    |
|---|------------------------------------|
| 1 450mm Silencer ESC 50                                 | 8 M8 Nyloc Nut (Z017.10062)        |
| 2 51 - 55mm Band Clamp(Z016.10002)                      | 9 Connecting Pipe CP 477           |
| 3 Composite silencer strap (O-Z038.10088)(R-Z038.10090) | 10 43-47mm Band Clamp (Z016.10008) |
| 4 M8 x 80mm Cap Head Bolt (Z017.10084)                  | 11 Bump Stop Kit (Z017.10010)      |
| 5 Alloy Bolt Finisher (Z026.20068)                      |                                    |
| 6 25mm Spacer (Z026.10007)                              |                                    |
| 7 2 x M8 x 25mm Washers (Z017.10825)                    |                                    |

E-MARK ROUND	SCDB-RS [e4] 2035
E-MARK OVAL	SCDB-OS [e4] 2072
ISSUE NO.	04
DATE	13/12/2018
AUTHORISED	J.Harkin
CHECKED	

**NOTE:** ENSURE SCORPION SYSTEM IS CLEAR OF MOVING PARTS AND ALL ORIGINAL FUNCTIONS WORK CORRECTLY.

A) Remove original exhaust from bike, taking care to keep all original components in a safe place.

B) Refit Scorpion exhaust as per line diagram above.

C) When fitted take bike for a short ride to ensure all functions are correct.

D) When bike & exhaust are cool enough check all nuts and bolts are still secure.