

BIKE	Triumph Tiger 1050	PART NO.	ETR-63
YEAR	2007-12	FIT KITS	OVAL Z039.11249
NOTES	Use original bump stop rubber when fitting to bike with centre stand.	DB-Killer	SCEXDBK12 - (Type B)

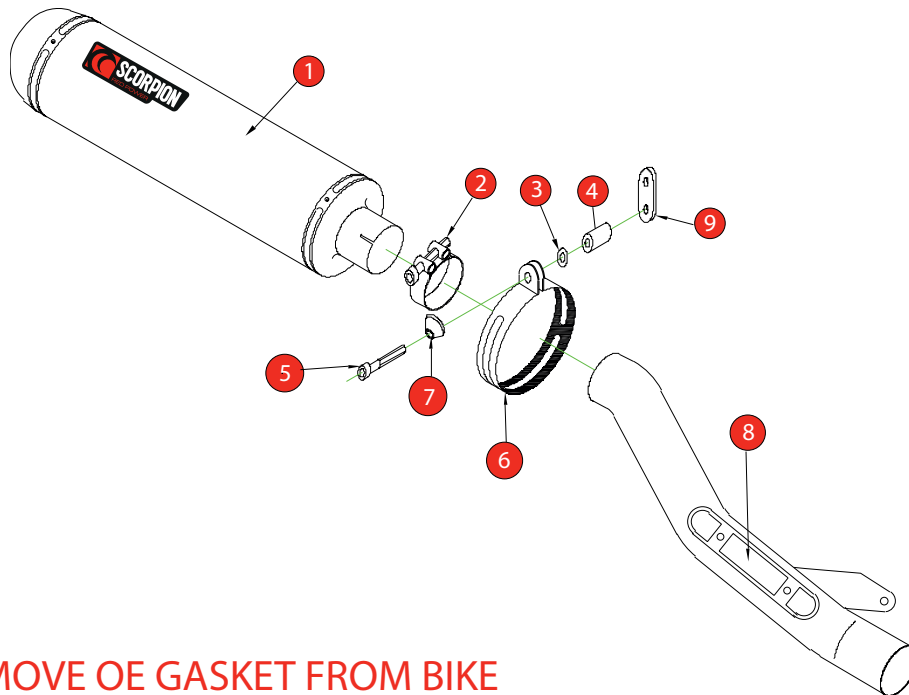

DO NOT REMOVE OE GASKET FROM BIKE

- | | |
|---|---------------------------------|
| 1 400mm Silencer ESC 157 | 8 Connecting Pipe CP 436 |
| 2 51-55mm Band Clamp (Z016.10002) | 9 Mounting Bracket (Z015.10001) |
| 3 M8 x 17mm Washer (Z017.10831) | 10 Photo Fitting Instructions |
| 4 30mm Aluminium Spacer (Z026.10008) | |
| 5 M8 x 50mm Cap Head Bolt (Z017.10078) | |
| 6 Composite Silencer Strap (Z038.10088) | |
| 7 Aluminium Bolt Finisher (Z026.20068) | |

E-MARK ROUND	N/A
E-MARK OVAL	BSAU 193a 1990/t3
ISSUE NO.	14
DATE	04/08/21
AUTHORISED	M.Ydlibi
CHECKED	

NOTE: ENSURE SCORPION SYSTEM IS CLEAR OF MOVING PARTS AND ALL ORIGINAL FUNCTIONS WORK CORRECTLY.



Box: PLOCK 2

BIKE	Triumph Tiger 1050	PART NO.	ETR-63
YEAR	2007-12	FIT KITS	OVAL Z039.11249
NOTES	Use original bump stop rubber when fitting to bike with centre stand.	FEATURES	

CONTINUED FROM OVERLEAF:



A) Using the key unlock the seat

B) Now remove the seat unit.

C) Undo the 8 bolts that hold down the grab rail.

D) Then the grab rail unit is ready to be removed.

C) Undo the 6 bolts that hold in place the seat fairing.

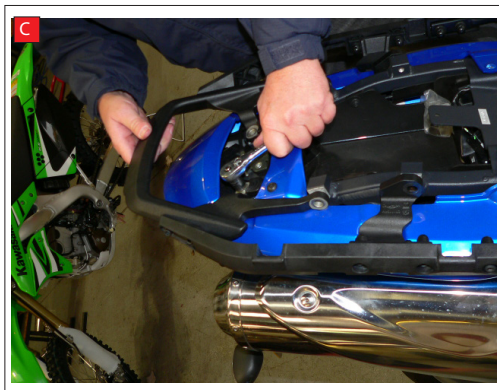

D) Remove the seat fairing, this is one whole unit.

E) Remove the front heat shield from the under belly.

F) Slacken of the O.E exhaust silencer bolt.

G) Slacken off the clamp on the O.E exhaust link pipe, located after the cat.



H) Now the whole O.E exhaust system can be removed.

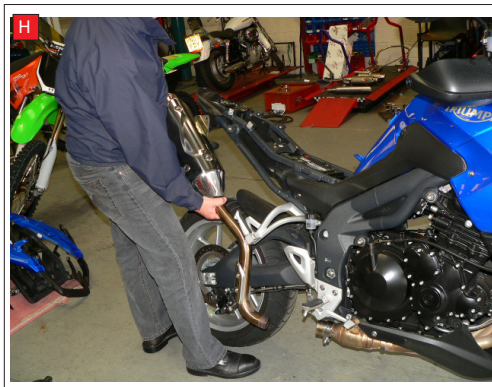
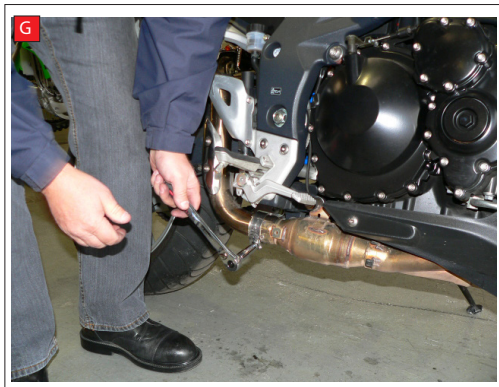

Box: PLOCK 2

BIKE	Triumph Tiger 1050	PART NO.	ETR-63
YEAR	2007-12	FIT KITS	OVAL Z039.11249
NOTES	Use original bump stop rubber when fitting to bike with centre stand.	FEATURES	

CONTINUED FROM OVERLEAF:

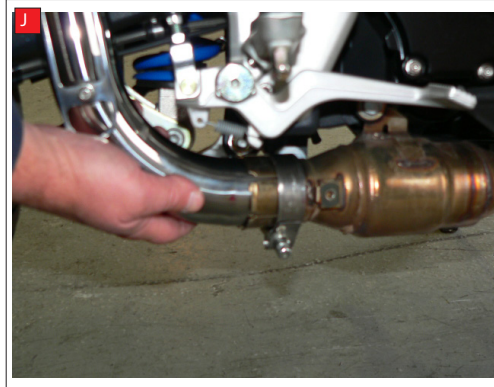

J) Introduce the Scorpion connecting pipe CP 436 to the header pipe with the clamp on the CP 436.

K) Push on the Scorpion silencer on the top end off the CP 436, again with the clamp on the silencer.

L) Fit the mounting bracket to the bike frame and slip the strap on the silencer.



M) Ensure that the Scorpion system is sitting level and square and that none of the original functions of the bike are impaired.

When you are happy tighten all nuts and bolts. refit all original parts in reverse order.

When fitted take your bike on a short ride to make sure all the nuts and bolts are tight and secure. Also that the bike has no gasses leaking from the system.

After this when back allow time for bike to cool down, then check all nuts and bolts are tight.

