

BIKE	Yamaha YZF-R6	PART NO.	YA-1000
YEAR	2006-2017	FIT KITS	Z039.10390
NOTES	Use standard fittings where not supplied Remove standard gasket if fitted.	DB-Killer	SCEXDBK28 - (Type EE)

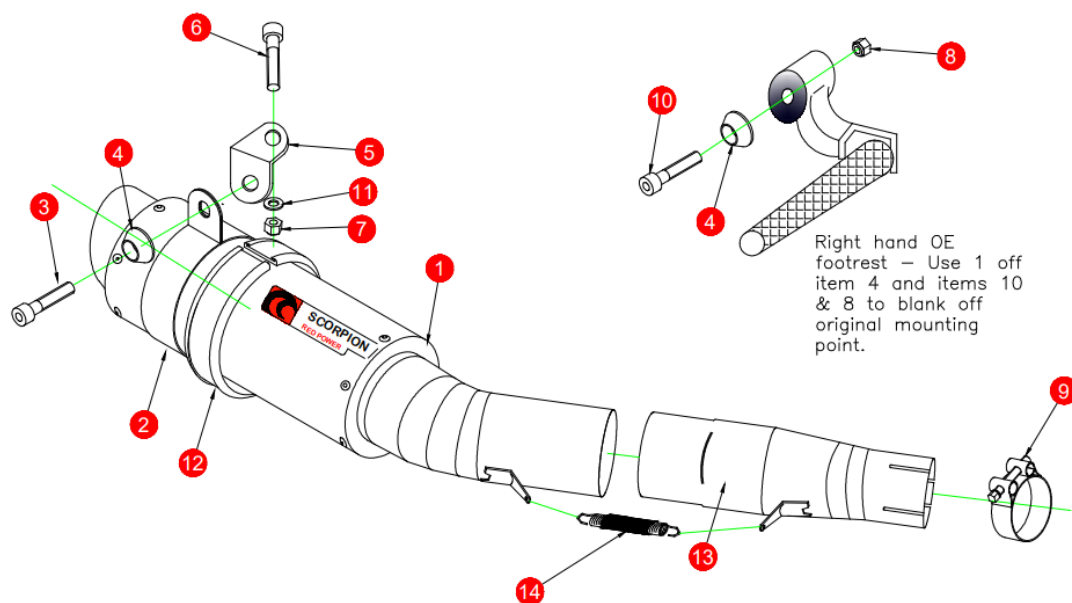

1 225mm RP-1 GP Silencer with integrated CP 582

2 Titanium Silencer Strap (Z028.10013)

3 M8x12mm Cap Head Bolts (Z017.10070)

4 2 off Bolt Finishers (Z026.20068)

5 Mounting Bracket (Z015.10080)

6 M6x40mm Cap Head Bolt (Z017.10022)

7 M6 Nyloc Nut (Z017.10033)

8 M8 Nyloc Nut (Z017.10062)

9 47-51mm Band Clamp (Z016.10003)

10 M8x30mm Cap Head Bolt (Z017.10074)

11 M6 Washer (Z017.10617)

12 Square edge rubber (Z029.10024)

13 Connecting Pipe CP838

14 Rubber Coated Spring (Z028.10030)

E-MARK ROUND	N/A
E-MARK OVAL	BSAU 193a 1990/t3
ISSUE NO.	08
DATE	05/80/21
AUTHORISED	M.Ydlibi
CHECKED	

NOTE: ENSURE SCORPION SYSTEM IS CLEAR OF MOVING PARTS AND ALL ORIGINAL FUNCTIONS WORK CORRECTLY.



Box: PLOCK 1

BIKE	Yamaha YZF-R6	PART NO.	YA-1000
YEAR	2006-2017	FIT KITS	Z039.10390
NOTES	Use standard fittings where not supplied Remove standard gasket if fitted.	FEATURES	SCEXDBK28 - (Type EE)

CONTINUED FROM OVERLEAF:

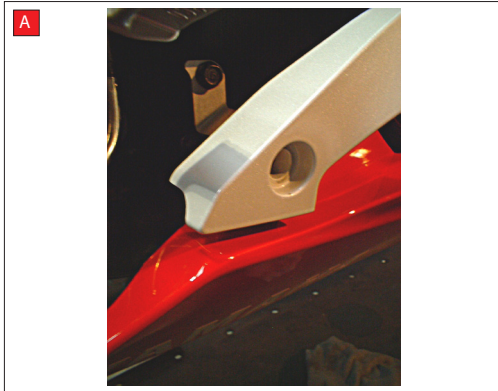

A) Remove lower fairing bolt to aid access to OE silencer clamp



B) Remove the three bolts shown to expose the expul valve & cables

C) Disconnect the cables by unscrewing the adjusting nuts & lift the nipples out of the wheel

You can now remove the OE silencer by removing the clamp & top hanging bolt

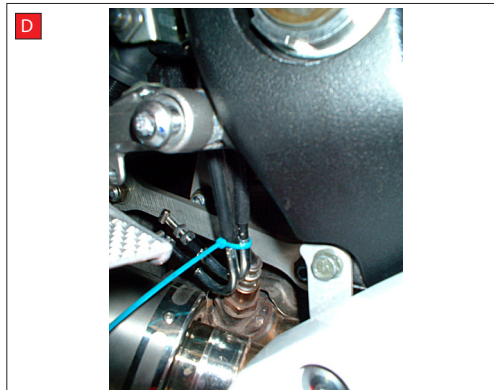
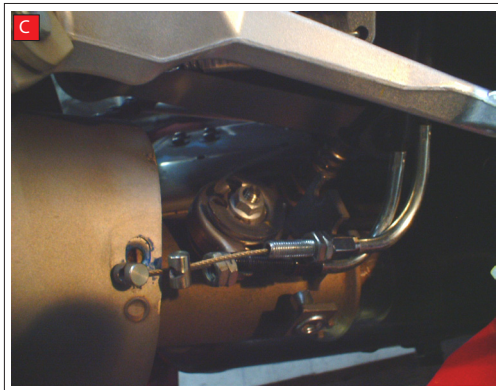

D) Before fitting the Scorpion silencer, use the cable-tie to safely attach the loose cables to the lambda sensor wire & trim the cable-tie.

E) Now remove the O.E flare and gasket from the exhaust so Scorpion product can fit the O.E.

F) Fit the Scorpion silencer with the new clamp & OE bolt and fasten securely with the Nyloc nut, then tighten the clamp.



Ensure all cables and any fitments are secured safely and all original functions work correctly prior to use.