

Box: PLOCK 2

BIKE	KAWASAKI Z 1000	PART NO.	EKA-69
YEAR	2003 - 2006	FIT KITS	OVAL Z039.11071 // ROUND Z039.10071
NOTES	Use standard fittings where not supplied Remove standard gasket if fitted.	DB-Killer	2 x SCEXDBK12 - (Type B)

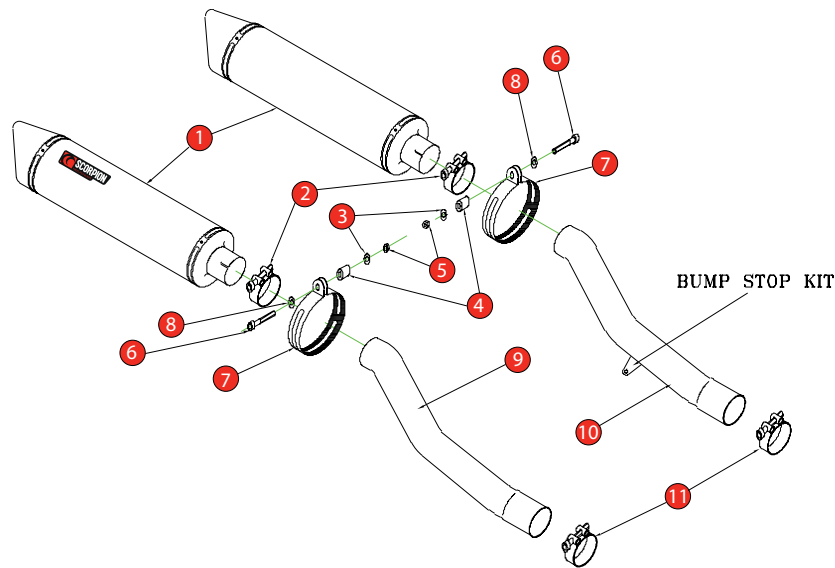

1 2 x 450mm Silencers ESC 50	8 2 x M10 x 25mm Washers (Z017.11014)
2 2 x 51-55mm Band Clamps (Z016.10002)	9 Connecting Pipe CP 134
3 2 x M10 x 17mm Washers (Z017.10108)	10 Connecting Pipe CP 135
4 2 x 30mm (M10) Aluminium Spacers (Z026.10101)	11 2 x 47-51mm Band Clamps (Z016.10003)
5 2 x M10 Nyloc Nuts (Z017.10103)	12 Bump Stop Kit (Z017.10010)
6 2 x M10 x 90mm Cap Head Bolts (Z017.12755)	
7 2 x Comp/ Silencer Straps (R-Z038.10090)(O-Z038.10088)	

E-MARK ROUND	SCDB-RS e4 2035
E-MARK OVAL	SCDB-OS e4 2072
ISSUE NO.	09
DATE	18/10/2018
AUTHORISED	J.Harkin
CHECKED	

NOTE: ENSURE SCORPION SYSTEM IS CLEAR OF MOVING PARTS AND ALL ORIGINAL FUNCTIONS WORK CORRECTLY.

A) Remove original exhaust from bike, taking care to keep all original components in a safe place.

B) Refit Scorpion exhaust as per line diagram above.

C) When fitted take bike for a short ride to ensure all functions are correct.

D) When bike & exhaust are cool enough check all nuts and bolts are still secure.