

BIKE	Yamaha MT-125	PART NO.	RYA-97-SYS
YEAR	2014-19	FIT KITS	Z039.10525
NOTES	Use standard fittings where not supplied Remove standard gasket if fitted.	DB-Killer	SCEXDBK26 - (Type X)

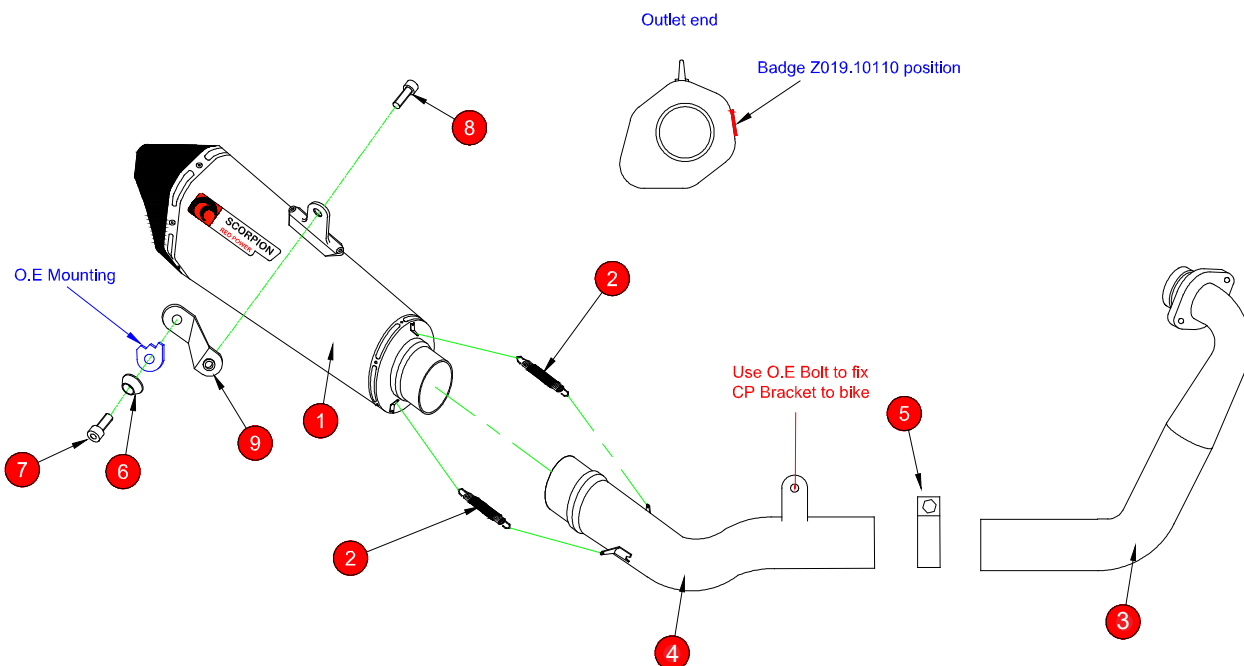

- | | |
|--------------------------------------|--------------------------------------|
| 1 Taper Serket Silencer RSC309 | 7 M8x35mm Cap Head Bolt (Z017.10075) |
| 2 Rubber Coated Springs (Z028.10030) | 8 M8x20mm Cap Head Bolt (Z017.10072) |
| 3 Connecting Pipe CP803 | 9 Mounting Bracket (Z015.31018) |
| 4 Connecting Pipe CP804 | |
| 5 43-47mm Band Clamp (Z016.10008) | |
| 6 Alloy Bolt Finisher (Z026.20068) | |

E-MARK OVAL	BSAU 193a 1990/t3
ISSUE NO.	02
DATE	22/10/2018
AUTHORISED	J.Harkin
CHECKED	

NOTE: ENSURE SCORPION SYSTEM IS CLEAR OF MOVING PARTS AND ALL ORIGINAL FUNCTIONS WORK CORRECTLY.



BIKE	Yamaha MT-125	PART NO.	RYA-97-SYS
YEAR	2014-19	FIT KITS	Z039.10525
NOTES	Where not supplied use original fittings	FEATURES	

CONTINUED FROM OVERLEAF:



A) Remove 3 x fairing on right side of bike.

B) Remove O.E header nuts, there is 2 nuts to remove, keep the nuts safe as they are needed later to fit Scorpion header pipe.

C) Remove O.E silencer mounting bolt and O.E lower mounting bolt, and again keep safe as is needed later on. the O.E system can now be removed.

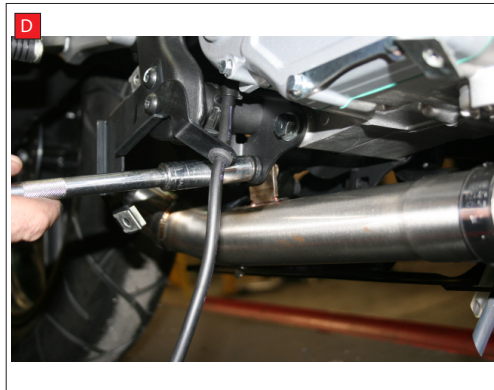

D) Attach Scorpion link pipe to the header pipe, making sure you put the clamp on loose, once slotted in tighten up the lower mounting bracket but only FINGER TIGHT.

E) Next fit the Scorpion mounting bracket to the silencer, using the picture and the line drawing diagram, loosely put together so that it looks the same as the picture, this makes fitting the silencer easier.

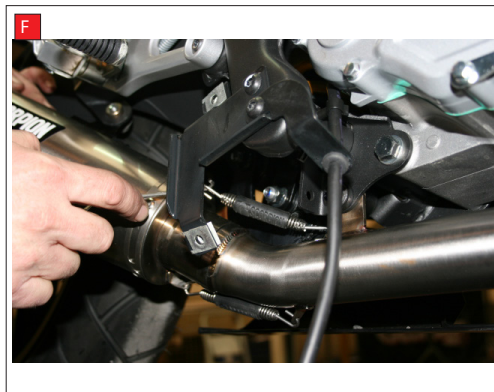

F) Now you can offer the Scorpion silencer to the bike and connecting pipe, slide the silencer into the collar of the scorpion link pipe and attach the rubber coated springs (best tool is a spring puller, we can supply you with this tool)

G) Bolt the Scorpion silencer to the O.E mounting bracket and fully tighten. Then fully tighten the bolt that goes onto the Scorpion silencer mounting bracket.



H) Fully tighten the lower mounting bracket and the clamp that fixes the header pipe and the link pipe together.

Box: PLOCK 2

BIKE	Yamaha MT-125	PART NO.	RYA-97-SYS
YEAR	2014-19	FIT KITS	Z039.10525
NOTES	Where not supplied use original fittings	FEATURES	

CONTINUED FROM OVERLEAF:



I) Fully tighten up the header nuts and then the Scorpion system is fitted.

J) Once happy that all nuts/ bolts are tight you can refit all three O.E fairing, making sure they are back in the correct place as how you found it and that nothing is in contact with the Scorpion system.

K) When all steps have been completed and you are happy that the fitment is all correct take your bike out for a short run, this is to ensure the system is sealed correctly and there are no gas leaks. After a short run allow bike to cool down then check that all nuts and bolts are still tight and system is sealed.



Box: PLOCK 2

BIKE	Yamaha MT-125	PART NO.	RYA-97-SYS
YEAR	2014-19	FIT KITS	Z039.10525
NOTES		FEATURES	

Thank you for purchasing your Scorpion Silencer.

Care of your exhaust: Please refrain from cleaning silencer with heavy solvents or abrasives!

Vielen Dank für den Kauf eines Scorpion Schalldämpfers! Pflegehinweis: Bitte verwenden Sie niemals Scheuermittel oder aggressive Reiniger zur Pflege Ihres Auspuffes!

Merci d'avoir choisi un échappement Scorpion.

Entretien de votre silencieux: Ne pas utiliser de solvants ou de produits abrasifs!

“Muchas gracias por adquirir un Silencioso Scorpion. Le recomendamos no limpiar el silencioso con productos abrasivos o aquellos que contengan disolventes.”