

Box:PLOCK 1

BIKE	Triumph Daytona 675 / Daytona 675 R	PART NO.	RTR-75
YEAR	2013-16	FIT KITS	Z039.20486
NOTES	Use standard fittings where not supplied Remove standard gasket if fitted.	DB-Killer	SCEXDBK23 - (Type V)

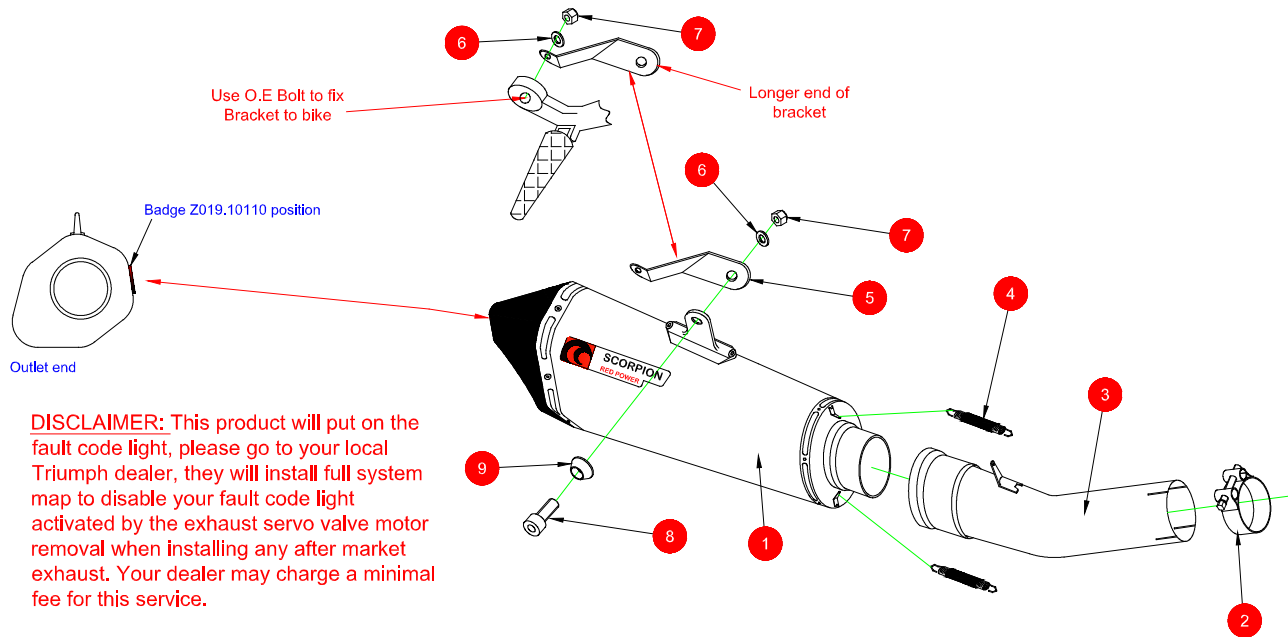

**DISCLAIMER:** This product will put on the fault code light, please go to your local Triumph dealer, they will install full system map to disable your fault code light activated by the exhaust servo valve motor removal when installing any after market exhaust. Your dealer may charge a minimal fee for this service.

- |  |                                    |
|--|------------------------------------|
| 1 Serket Silencer RSC265                 | 9 Alloy Bolt Finisher (Z026.20068) |
| 2 47-51mm Band Clamp (Z016.10003)        |                                    |
| 3 Connecting Pipe CP718                  |                                    |
| 4 2 x Rubber Coated Springs (Z028.10030) |                                    |
| 5 Bracket (Z015.31031)                   |                                    |
| 6 2 x M8x17mm Washers (Z017.10831)       |                                    |
| 7 2 x M8 Nyloc Nuts (Z017.10062)         |                                    |
| 8 M8x25mm Cap Head Bolt (Z017.10073)     |                                    |

CLASSIFICATION	Closed Circuit Product
HOMOLOGATED	No
ISSUE NO.	05
DATE	28/06/21
AUTHORISED	M.Ydlibi

**NOTE:** ENSURE SCORPION SYSTEM IS CLEAR OF MOVING PARTS AND ALL ORIGINAL FUNCTIONS WORK CORRECTLY.

A) Remove original exhaust from bike including servo motor and cable (see next page) taking care to keep all original components in a safe place.

B) Refit Scorpion exhaust as per line diagram above.

C) When fitted take bike for a short ride to ensure all functions are correct.

D) When bike & exhaust are cool enough check all nuts and bolts are still secure.



BIKE	Triumph Daytona 675 / Daytona 675 R	PART NO.	RTR-75
YEAR	2013-16	FIT KITS	Z039.20486
NOTES	Use standard fittings where not supplied <b>Remove standard gasket if fitted.</b>	FEATURES	



A) The picture to the left is the bikes O.E servo motor. This must be unplugged and removed with original exhaust.

You will need to plug in a servo eliminator or a full system map.

Thank you for purchasing your Scorpion Silencer.  
Care of your exhaust: Please refrain from cleaning silencer with heavy solvents or abrasives!

Vielen Dank für den Kauf eines Scorpion Schalldämpfers! Pflegehinweis: Bitte verwenden Sie niemals Scheuermittel oder aggressive Reiniger zur Pflege Ihres Auspuffes!

Merci d'avoir choisi un échappement Scorpion.  
Entretien de votre silencieux: Ne pas utiliser de solvants ou de produits abrasifs!

Muchas gracias por adquirir un Silencioso Scorpion. Le recomendamos no limpiar el silencioso con productos abrasivos o aquellos que contengan disolventes.