

BIKE	HONDA CBR 1000 RR	PART NO.	HA-1001
YEAR	2012 - 13	FIT KITS	Z039.20451
NOTES	Bung and copper washer to be replaced by OE lambda probe. (not applicable to non catalyst models), nylon washer either side of item 9.	DB-Killer	SCEXDBK22 - (Type Z)

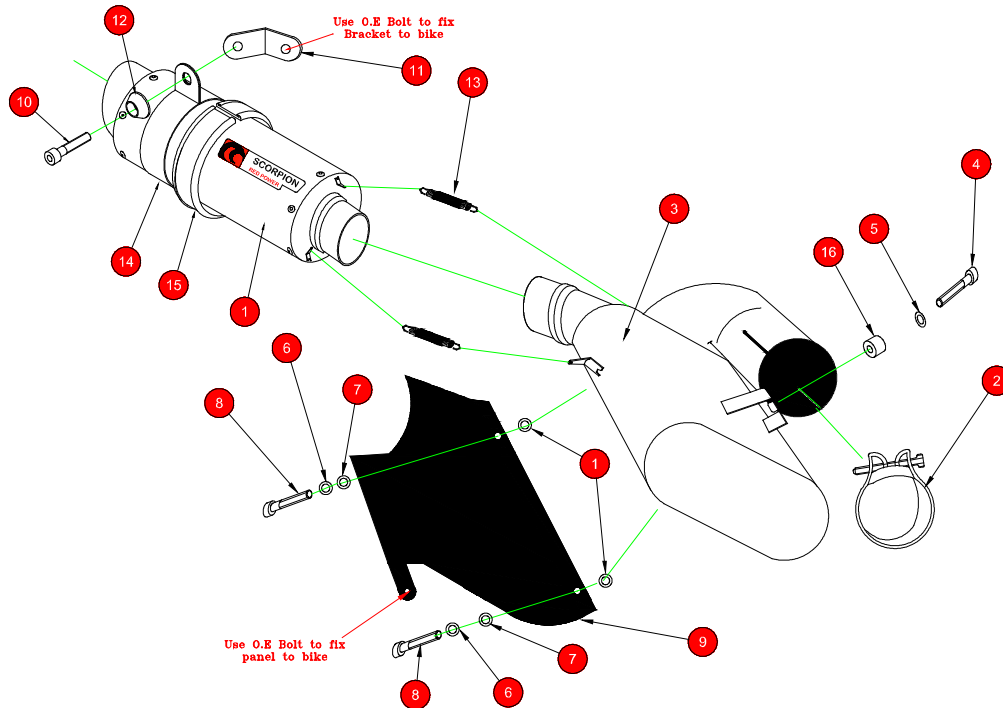

1 RP1-GPSilencer SC230	9 Panel (Z028.20181)
2 51-55mm Band Clamp (Z016.100030)	10 M8 x 20mm Cap Head (Z017.10072)
3 Connecting Box CP668	11 Mounting Bracket (Z015.30942)
4 M8 x 30mm Cap Head (Z017.10074)	12 Alloy Bolt Finisher (Z026.20068)
5 M8 x 17mm Washer (Z017.10831)	13 2 x Rubber Coated Springs (Z028.10030)
6 2 x M6 Star Washers (Z017.10614)	14 Titanium Silencer Strap (Z028.10013)
7 4 x Nylon Washers (Z017.12748)	15 Square Edge Rubber (Z029.10024)
8 2 x M6 x 10mm Button Heads (Z017.12707)	16 15mm Alloy Spacer (Z026.10005)

E-MARK BOX	<a href="#">HA-95 [e4]2295</a> ©
E-MARK OVAL	<a href="#">HA-95 [e4]2295</a> ©
ISSUE NO.	04
DATE	16/10/2018
AUTHORISED	J.Harkin
CHECKED	

**NOTE:** ENSURE SCORPION SYSTEM IS CLEAR OF MOVING PARTS AND ALL ORIGINAL FUNCTIONS WORK CORRECTLY.

Fitting instructions on next page.



BIKE	HONDA CBR 1000 RR	PART NO.	HA-1001
YEAR	2012 - 13	FIT KITS	Z039.20451
NOTES	Bung and copper washer to be replaced by OE lambda probe. (not applicable to non catalyst models), nylon washer either side of item 9.	FEATURES	

CONTINUED FROM OVERLEAF:



A) Remove side panel behind pillion foot peg.

B) Remove back panel to allow access to servo wheel.

C) Turn servo wheel 45° clockwise, this make the cable easier to remove.

D) Remove the cable from the clip at the back of the servo wheel unit.

E) Remove the bolt on the belly pan to allow access to the O.E exhaust, save this bolt as it is used later on.

F) Remove the bolt on the other side belly pan to allow access to the O.E exhaust.

G) Remove Lambda sensor (if bike is fitted with one)

H) Loosen O.E clamp to free the O.E exhaust from O.E system.

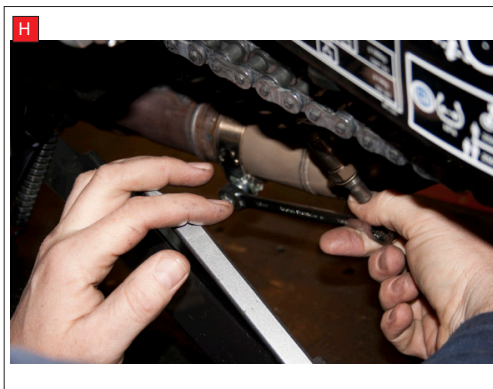
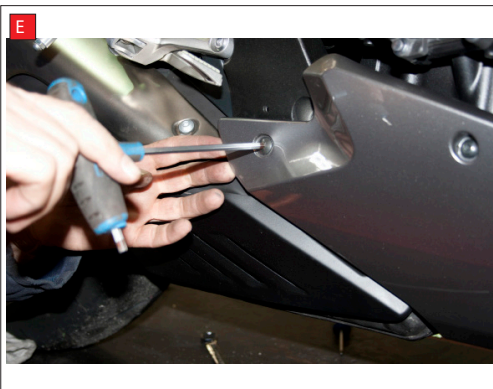

BIKE	HONDA CBR 1000 RR	PART NO.	HA-1001
YEAR	2012 - 13	FIT KITS	Z039.20451
NOTES	Bung and copper washer to be replaced by OE lambda probe. (not applicable to non catalyst models), nylon washer either side of item 9.	FEATURES	

CONTINUED FROM OVERLEAF:

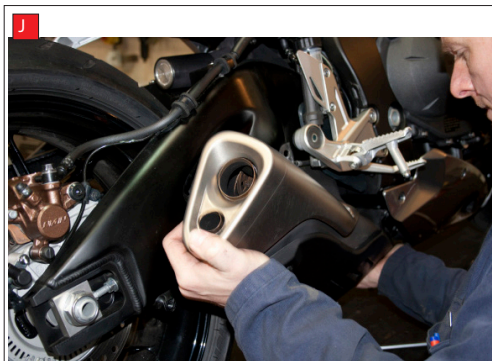

I) Remove O.E silencer mounting bolt, keep this bolt as it will be needed later on in fitting Scorpion Exhaust.

J) Slowly remove the O.E exhaust< take care with feeding out the servo cable.

K) Introduce the connecting box CP668 upto the O.E system, DO NOT tighten up the clamp.

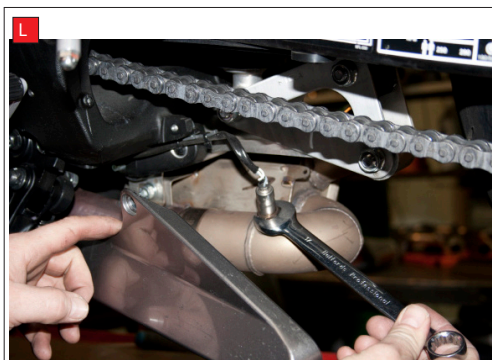
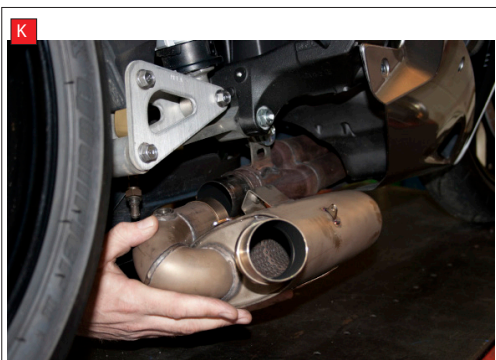

L) Put the Lambda sensor into the CP668, if no lambda sensor is on bike then leave in blanking plug, make sure the Lambda or blanking plug is tight.

M) Bolt on the Scorpion mounting bracket using the O.E mounting bolt, DO NOT FULLY TIGHTEN.

N) Fit Scorpion silencer to CP668, position strap and rubber and bolt to the mounting bracket. tighten up both bolts and attach the 2 x rubber coated springs.

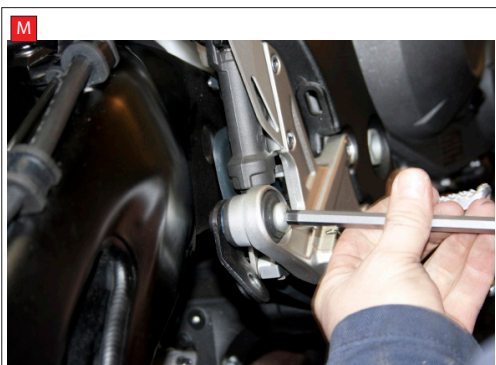

O) Fully tighten the clamp on CP668 to O.E system.

P) Bolt back the belly pan fairing on this side.

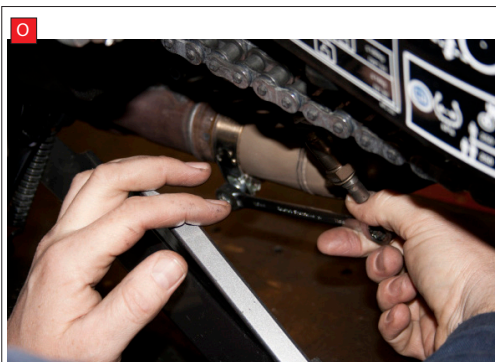

Box: PLOCK 3

BIKE	HONDA CBR 1000 RR	PART NO.	HA-1001
YEAR	2012 - 13	FIT KITS	Z039.20451
NOTES	Bung and copper washer to be replaced by OE lambda probe. (not applicable to non catalyst models), nylon washer either side of item 9.	FEATURES	

CONTINUED FROM OVERLEAF:



Q) Fit the Scorpion composite fairing, using the line drawing on page 1 to make sure all the fixings are in the correct place, on the top mounting point on the fairing use the O.E bolt.

R) Bolt back the 2 x plastic panels that hid the servo wheel.

S) When all the steps have been carried out double check all nuts and bolts are tight and that all the bikes original functions work correctly and that nothing on the bike is impaired. When satisfied fitment is correct take your bike for a short run to ensure system is sealed correctly and there ar no gas leaks. After a short run, check all nuts and bolts are still tight and nothing has come loose.

