

Box: PLOCK 2

BIKE	SUZUKI GSF 600 / 650 BANDIT	PART NO.	ESI - 67
YEAR	2000 - 2006	FIT KITS	OVAL Z039.11081 // ROUND Z039.10081
NOTES	Use standard fittings where not supplied Remove standard gasket if fitted.	DB-Killer	SCEXDBK12 - (Type B)

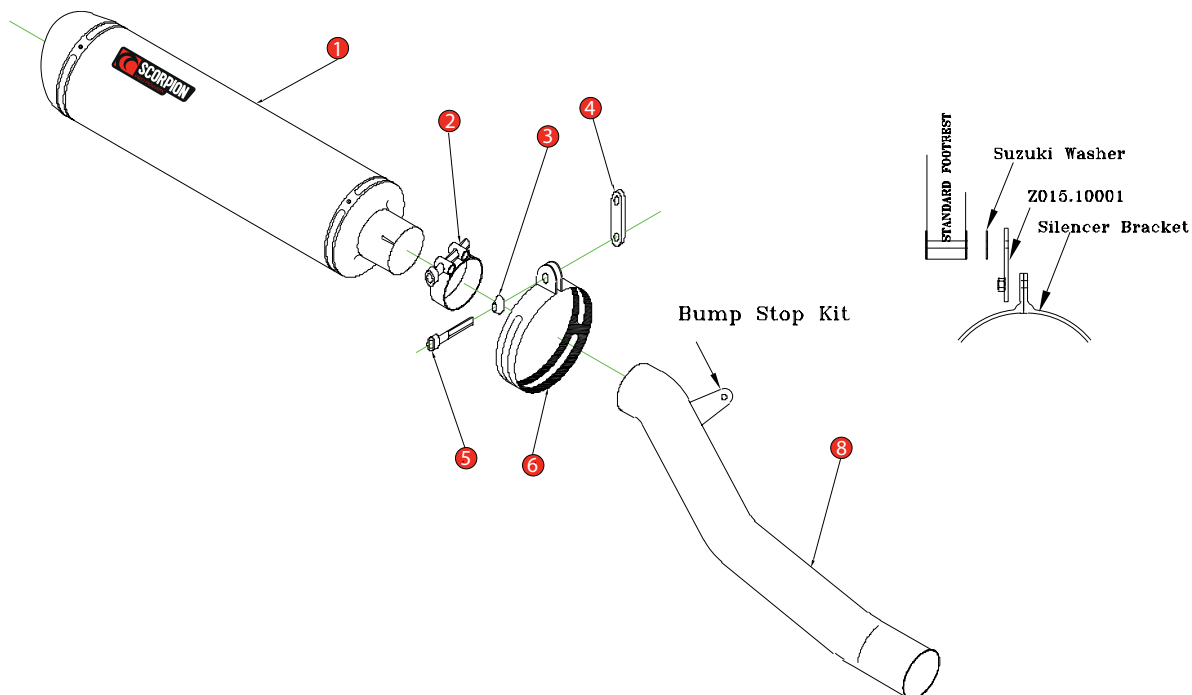

- 1 450mm Silencer ESC 50
- 2 51-55mm Band Clamp (Z016.10002)
- 3 Alloy Bolt Finisher (Z026.20068)
- 4 Mounting Bracket (Z015.10001)
- 5 M8 x 16mm Cap Head Bolt (Z017.10808)
- 6 Composite Silencer Strap (R-Z038.10090)(O-Z030.10088)
- 7 Connecting Pipe CP 33

8 Bump Stop Kit

E-MARK ROUND	BSAU 193a 1990/t3
E-MARK OVAL	BSAU 193a 1990/t3
ISSUE NO.	08
DATE	04/08/21
AUTHORISED	M.Ydlibi
CHECKED	

NOTE: ENSURE SCORPION SYSTEM IS CLEAR OF MOVING PARTS AND ALL ORIGINAL FUNCTIONS WORK CORRECTLY.



A) Remove original exhaust from bike, taking care to keep all original components in a safe place.

B) Refit Scorpion exhaust as per line diagram above.

C) When fitted take bike for a short ride to ensure all functions are correct.

D) When bike & exhaust are cool enough check all nuts and bolts are still secure.

