

Bike	Kawasaki Z H2	Part No.	RKA-135
Year	2020-Current	Fit Kit	Z039.10675
Notes	Where not supplied use original fittings. Remove original gasket.	dB Killer	SCEXDBK25 (TYPE Y)

Estimated Fitting Time: 60 Minutes

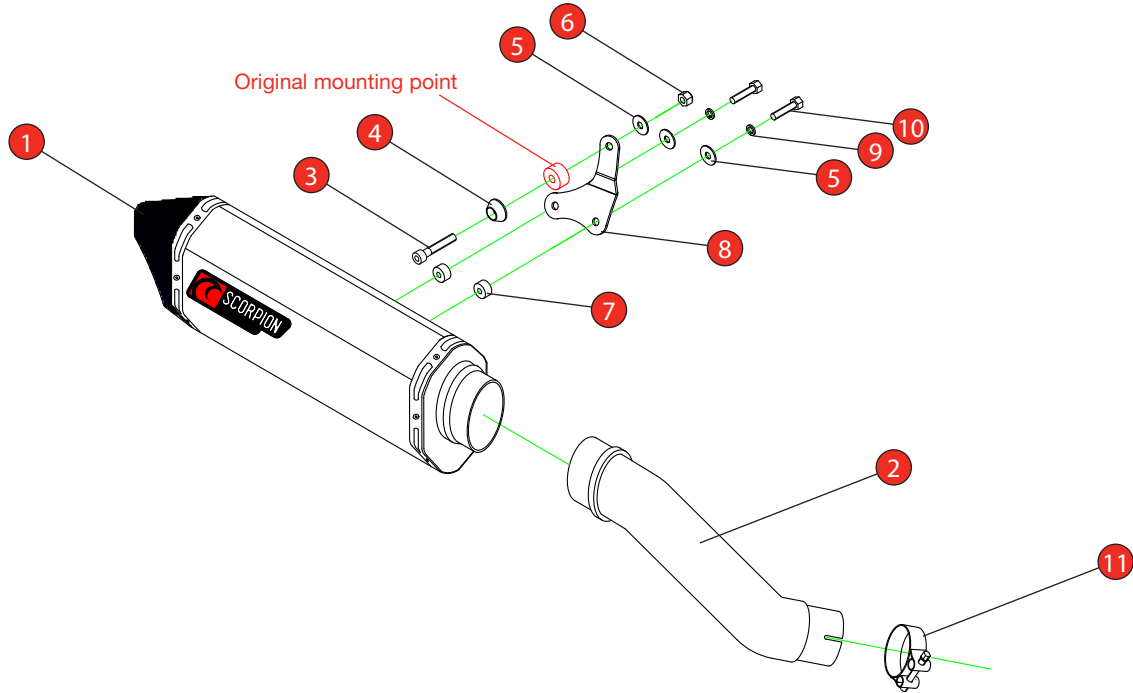

NO.	PART NO.	DESCRIPTION	QTY
1	RSC483	Serket Silencer	1
2	CP1084	Connecting Pipe	1
Fit Kit - Z039.10675			
3	Z017.10076	M8 x 40mm Cap Head Bolt	1
4	Z026.20068	Alloy Bolt Finisher	1
5	Z017.10825	M8 25mm Washer	3
6	Z017.10062	M8 Nyloc Nut	1
7	Z026.20049	5mm Alloy Spacer	2
8	Z015.31415	Mounting Bracket	1
9	Z017.10064	M8 Spring Washer	2
10	Z017.10048	M8 x 25mm Hex Head Bolt	2
11	Z016.10004	55-59mm Clamp	1

E-MARK	BSAU 193a 1990/t3
DATE	20/05/20
ISSUE	00
AUTHORISED	M.Ydlibi

NOTE: ENSURE SCORPION SYSTEM IS CLEAR OF MOVING PARTS AND ALL ORIGINAL FUNCTIONS WORK CORRECTLY.



Loosely fit the bracket to the silencer before fitting to the bike



STAY CONNECTED TO RED POWER.

Bike	Kawasaki Z H2	Part No.	RKA-135
Year	2020-Current	Fit Kit	Z039.10675
Notes	Where not supplied use original fittings. Remove original gasket.	dB Killer	SCEXDBK25 (TYPE Y)

Estimated Fitting Time: 60 Minutes



A) Remove original exhaust from bike, taking care to keep all original components in a safe place.

B) Refit Scorpion exhaust as per line diagram above.

C) When fitted take bike for a short ride to ensure all functions are correct.

D) When bike & exhaust are cool enough check all nuts and bolts are still secure.

Thank you for purchasing your Scorpion Silencer.

Care of your exhaust: Please refrain from cleaning silencer with heavy solvents or abrasives!

Vielen Dank Für den kauf eines Scorpion Schalldampfers! Pflegehinweis: Bitte verwenden Sie niemals Scheuermittel oder aggressive Reiniger zur Pflege Ihres Auspuffes!

Merci d'avoir choisi un echappement Scorpion.

Entretien de votre silencieux: Ne pas utiliser de solvants ou de produits abrasifs!

“Muchas gracias por adquirir un Silencioso Scorpion. Le recomendamos no limpiar el silencioso con productos abrasivos o aquellos que contengan disolventes.”



STAY CONNECTED TO RED POWER.