

Box: PLOCK 1

BIKE	SUZUKI GSXR 600 / GSX-R 750	PART NO.	SI-1001
YEAR	2008-10	FIT KITS	ROUND Z039.10370
NOTES	Use standard fittings where not supplied Remove standard gasket if fitted.	DB-Killer	SCEXDBK21 - (Type U)

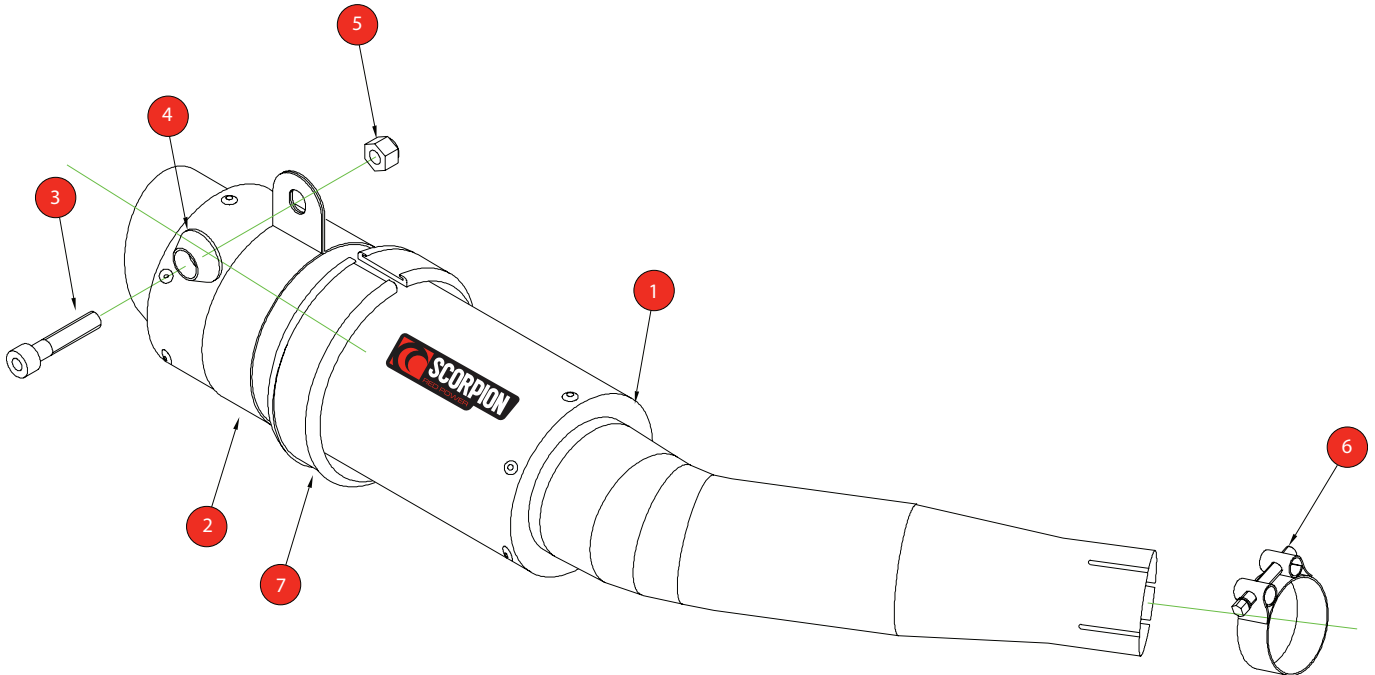

- 1 225mm RP-1 GP Silencer with intergrated CP 564
- 2 Titanium Silencer Strap (Z028.10013)
- 3 M8x40mm Cap Head Bolt (Z017.10076)
- 4 1 Alloy Bolt Finishers (Z026.20068)
- 5 M8 Nyloc nut (Z017.10062)
- 6 47-51mm Band Clamp (Z016.10003)
- 7 Square edge rubber (Z029.10024)

E-MARK	SI-102 e4 2275 9
ISSUE NO.	03 <input type="checkbox"/> <input type="checkbox"/> <input type="checkbox"/>
DATE	19/10/2018
AUTHORISED	J.Harkin
CHECKED	

NOTE: ENSURE SCORPION SYSTEM IS CLEAR OF MOVING PARTS AND ALL ORIGINAL FUNCTIONS WORK CORRECTLY.



A) Remove original exhaust from bike, taking care to keep all original components in a safe place.

B) refit Scorpion exhaust as per line diagram above.

C) When fitted take bike for a short ride to ensure all functions are correct.

D) When bike & exhaust are cool enough check all nuts and bolts are still secure.