

Box: PLOCK 1

BIKE	HONDA CBR 900 RR F/Blade 898	PART NO.	EHA -60
YEAR	1992-1995	FIT KITS	OVAL Z039.11042 // ROUND Z039.10042
NOTES	Ensure billet is fitted with M8x16 cap heads & spring washers prior to dispatch	DB-Killer	SCEXDBK12 - (Type B)

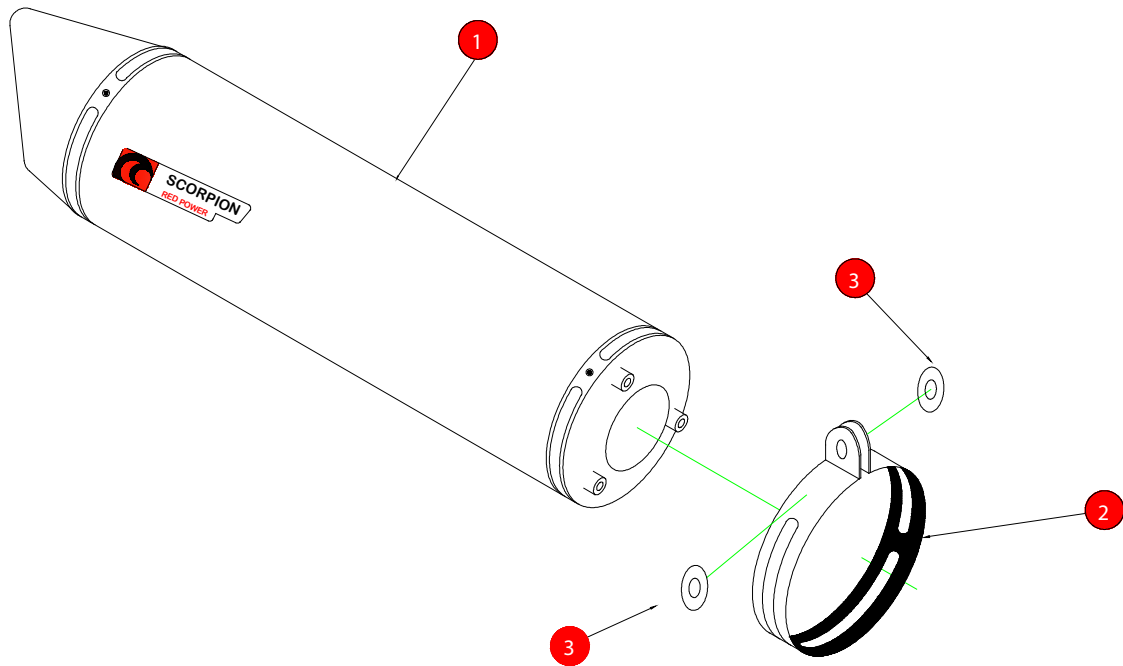

- 1 450mm Silencer (R-ZE40.03A) (O-ZE40.04A)
- 2 'H' Composite Silencer Strap (R-Z038.10090) (O-Z038.10088)
- 3 2 off M8x25mm Washers (Z017.10868)

E-MARK ROUND	SCDB-RB [e4] 2103
E-MARK OVAL	SCDB-OB [e4] 2104
ISSUE NO.	07
DATE	16/10/2018
AUTHORISED	J.Harkin
CHECKED	

NOTE: ENSURE SCORPION SYSTEM IS CLEAR OF MOVING PARTS AND ALL ORIGINAL FUNCTIONS WORK CORRECTLY.

A) Remove original exhaust from bike, taking care to keep all original components in a safe place.

B) Refit Scorpion exhaust as per line diagram above.

C) When fitted take bike for a short ride to ensure all functions are correct.

D) When bike & exhaust are cool enough check all nuts and bolts are still secure.