

Box: PLOCK 1

BIKE	SUZUKI GSXR 1000	PART NO.	ESI - 71
YEAR	2001 - 2004	FIT KITS	OVAL Z039.11094 // ROUND Z039.10094
NOTES	Ensure billet is fitted with M8 x 16 Cap Heads & spring washers prior to despatch	DB-Killer	SCEXDBK12 - (Type B)

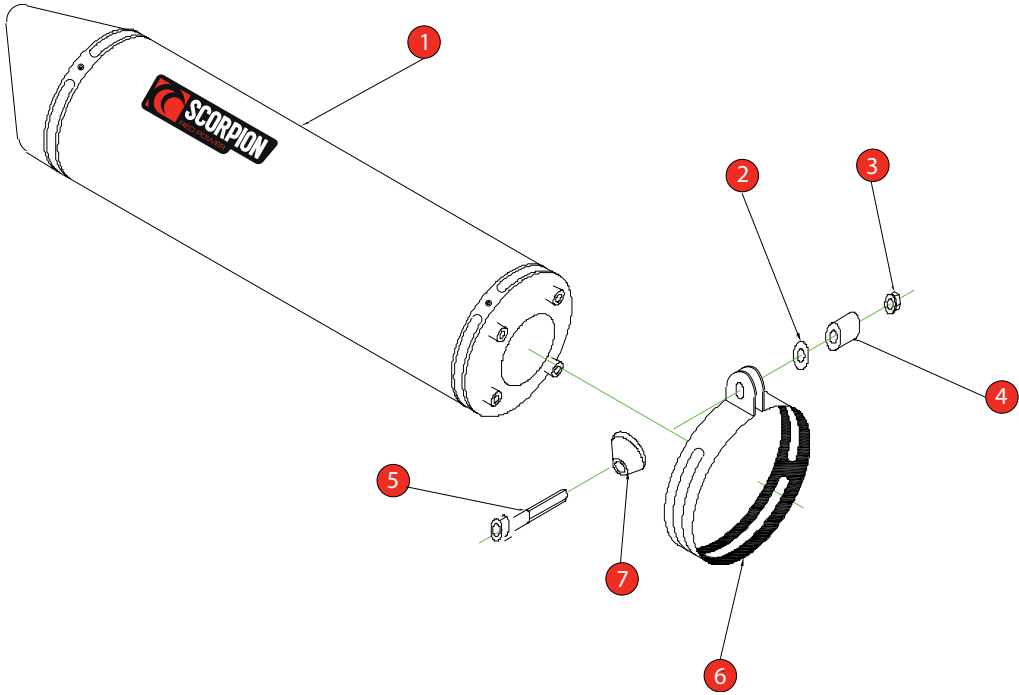

- 1 450mm Silencer (ZE40.17H)(ZE40.18H)
- 2 M\* x 25mm Washer (Z017.10825)
- 3 M8 Nyloc Nut (Z017.10062)
- 4 15mm Spacer (Z026.10005)
- 5 M8 x 50mm Cap Head Bolt (Z017.10078)
- 6 Composite Strap (R-Z038.10089)(O-Z038.10088)
- 7 Aluminium Bolt Finisher (Z026.20068)

E-MARK ROUND	BSAU 193a 1990/t3
E-MARK OVAL	BSAU 193a 1990/t3
ISSUE NO.	08
DATE	04/08/21
AUTHORISED	M.Ydlibi
CHECKED	

**NOTE:** ENSURE SCORPION SYSTEM IS CLEAR OF MOVING PARTS AND ALL ORIGINAL FUNCTIONS WORK CORRECTLY.

- A) Remove original exhaust from bike, taking care to keep all original components in a safe place.
- B) Refit Scorpion exhaust as per line diagram above.
- C) When fitted take bike for a short ride to ensure all functions are correct.
- D) When bike & exhaust are cool enough check all nuts and bolts are still secure.