

Bike	Yamaha Tenere 700 World Raid	Part No.	RYA-125
Year	2022-Current	Fit Kit	Z039.10667
Notes	Where not supplied use original fittings. Use original gasket when fitting Scorpion slip-on.	dB Killer	SCEXDBK25 - (Type Y)

Estimated Fitting Time: 60 Minutes

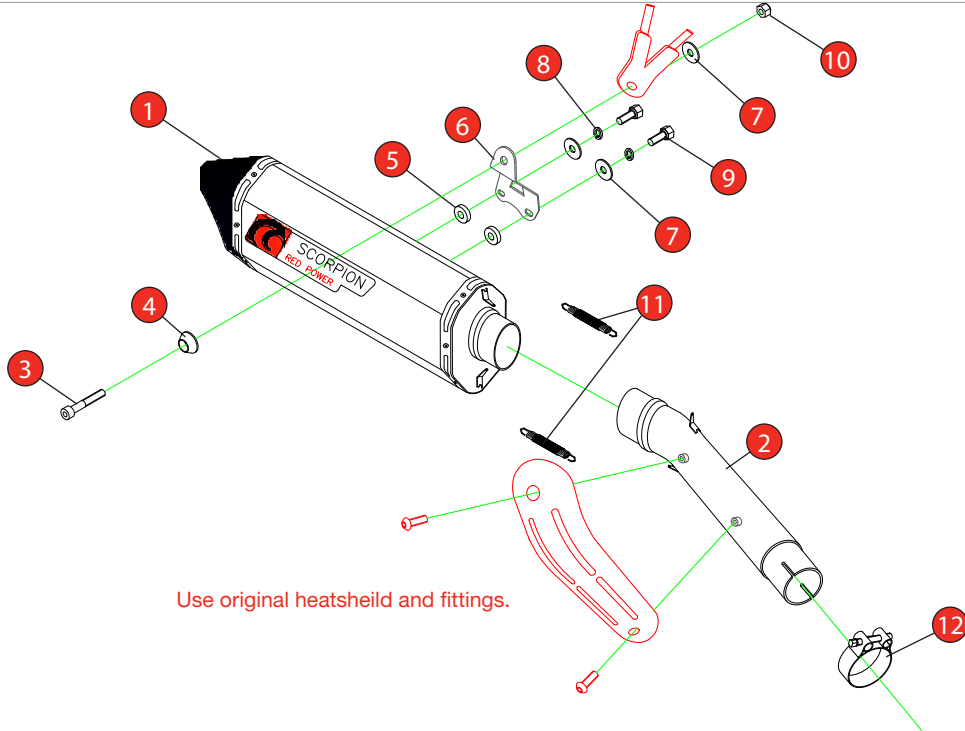

NO.	PART NO.	DESCRIPTION	QTY
1	RSC479	350mm Serket Parallel	1
2	CP1067	Connecting Pipe	1
Fitting Kit - Z039.10667			
3	Z017.10076	M8 x 40mm Cap Head Bolt	1
4	Z026.20068B	Alloy Bolt Finisher (Black)	1
5	Z026.20049	5mm Alloy Spacer	2
6	Z015.31404	Mounting Bracket	1
7	Z017.10825	M8 x 25mm Washer	3
8	Z017.10064	M8 Spring Washer	2
9	Z017.10110	M8 x 25 Button Head	2
10	Z017.10062	M8 Nyloc Nut	1
11	Z028.10030	Rubber Coated Spring	2
12	Z016.10003	47-51mm Clamp	1

CLASSIFICATION	Closed Circuit Product
HOMOLOGATED	NO
DATE	11/04/2023
ISSUE	00
AUTHORISED	S Shipley

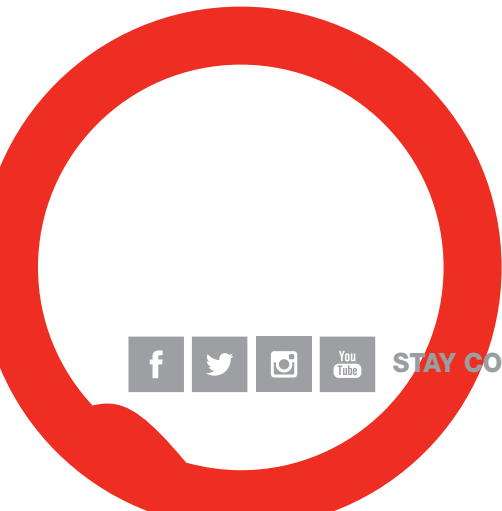
NOTE: ENSURE SCORPION SYSTEM IS CLEAR OF MOVING PARTS AND ALL ORIGINAL FUNCTIONS WORK CORRECTLY.

STAY CONNECTED TO RED POWER.

Bike	Yamaha Tenere 700 World Raid	Part No.	RYA-125
Year	2022-Current	Fit Kits	Z039.10667
Notes	Where not supplied use original fittings. Use original gasket when fitting Scorpion slip-on.	dB Killer	SCEXDBK25 - (Type Y)

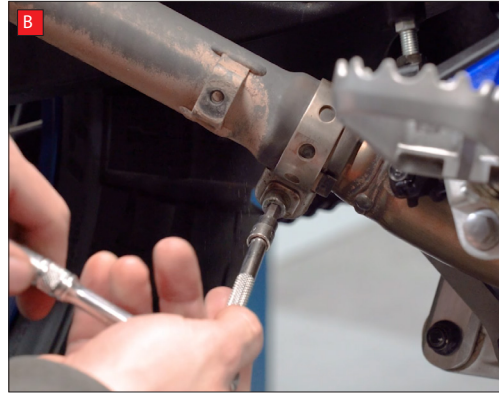

NOTE: If installing at the same time as the Scorpion Header kit follow those instructions instead.

A) Start by removing the heat shield from the original exhaust.

B) Loosen the clamp between the rear silencer and centre section and remove the bolt.

C) Loosen the rear silencer mounting bolt/nut. Support the weight of the silencer and remove the bolt.

D) Carefully remove the silencer from the bike.

E) Remove the gasket from the original exhaust and insert it into the Scorpion connecting pipe. If the gasket isn't in a good enough condition to re-use, replace it with a new genuine gasket from Yamaha.

NOTE: If fitting with the Scorpion header pipe kit the gasket is not required.

F) Slide the Scorpion connecting pipe along with the supplied clamp onto the original centre section.

G) Attach the silencer mounting bracket to the silencer using the supplied hardware and spacers as per the diagram on the first page.

H) Slide the silencer onto the connecting pipe, align it with the original mounting point and insert the mounting bolt to loosely hold it in place.

Bike	Yamaha Tenere 700 World Raid	Part No.	RYA-125
Year	2022-Current	Fit Kits	Z039.10667
Notes	Where not supplied use original fittings. Use original gasket when fitting Scorpion slip-on.	dB Killer	SCEXDBK25 - (Type Y)

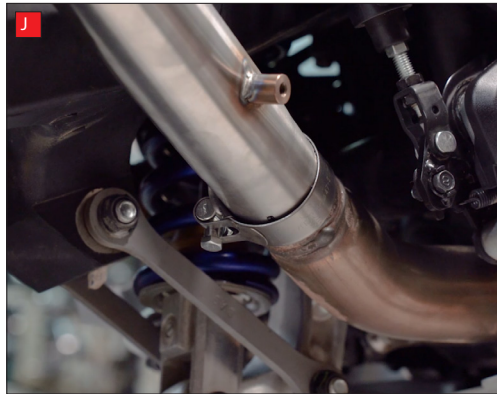

I) Attach the springs between the silencer and the connecting pipe.

J) Align the system so that it sits nicely under no tension and is clear of any moving parts and then tighten the clamp between the Scorpion connecting pipe and the centre section.

K) Tighten the bolts holding the bracket to the rear of the silencer.

L) Tighten the silencer mounting bolt.



M) Attach the original heat shield to the Scorpion connecting pipe and tighten the mounting screws.

Take the bike for a short ride to ensure it functions as it should. Once the bike and exhaust are cool enough check all nuts and bolts are still secure.

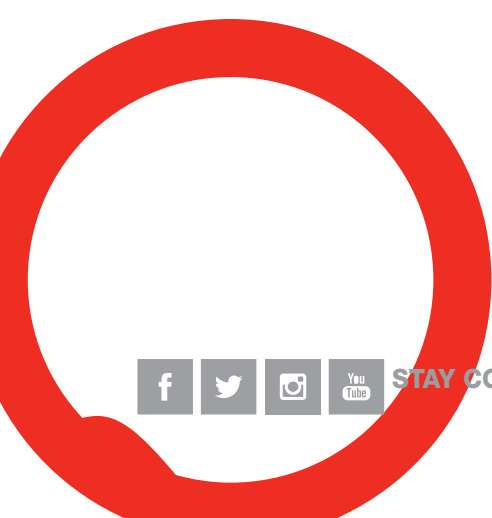

STAY CONNECTED TO RED POWER.

Bike	Yamaha Tenere 700 World Raid	Part No.	RYA-125
Year	2022-Current	Fit Kit	Z039.10667
Notes	Where not supplied use original fittings. Use original gasket when fitting Scorpion slip-on.	dB Killer	SCEXDBK25 - (Type Y)

Estimated Fitting Time: 60 Minutes



Thank you for purchasing your Scorpion Silencer.

Care of your exhaust: Please refrain from cleaning silencer with heavy solvents or abrasives!

Vielen Dank Für den kauf eines Scorpion Schalldampfers! Pflegehinweis: Bitte verwenden Sie niemals Scheuermittel oder aggressive Reiniger zur Pflege Ihres Auspuffes!

Merci d'avoir choisi un echappement Scorpion.

Entretien de votre silencieux: Ne pas utiliser de solvants ou de produits abrasifs!

Muchas gracias por adquirir un Silencioso Scorpion. Le recomendamos no limpiar el silencioso con productos abrasivos o aquellos que contengan disolventes.



STAY CONNECTED TO RED POWER.