

Box: PLOCK 1

BIKE	Yamaha MT-10	PART NO.	YA-102-CR
YEAR	2016-Current	FIT KITS	Z039.10549
NOTES	Where not supplied use original fittings. Fitting this bypass system will increase the noise produced by the bike. To reduce the noise a DB-Killer can be purchased for the Serket silencer.	DB-Killer	SCEXDBK25 - (Type Y) - FOR SERKET TAPER ONLY (RYA102) Use original DB-Killer Supplied with RP1-GP YA1003

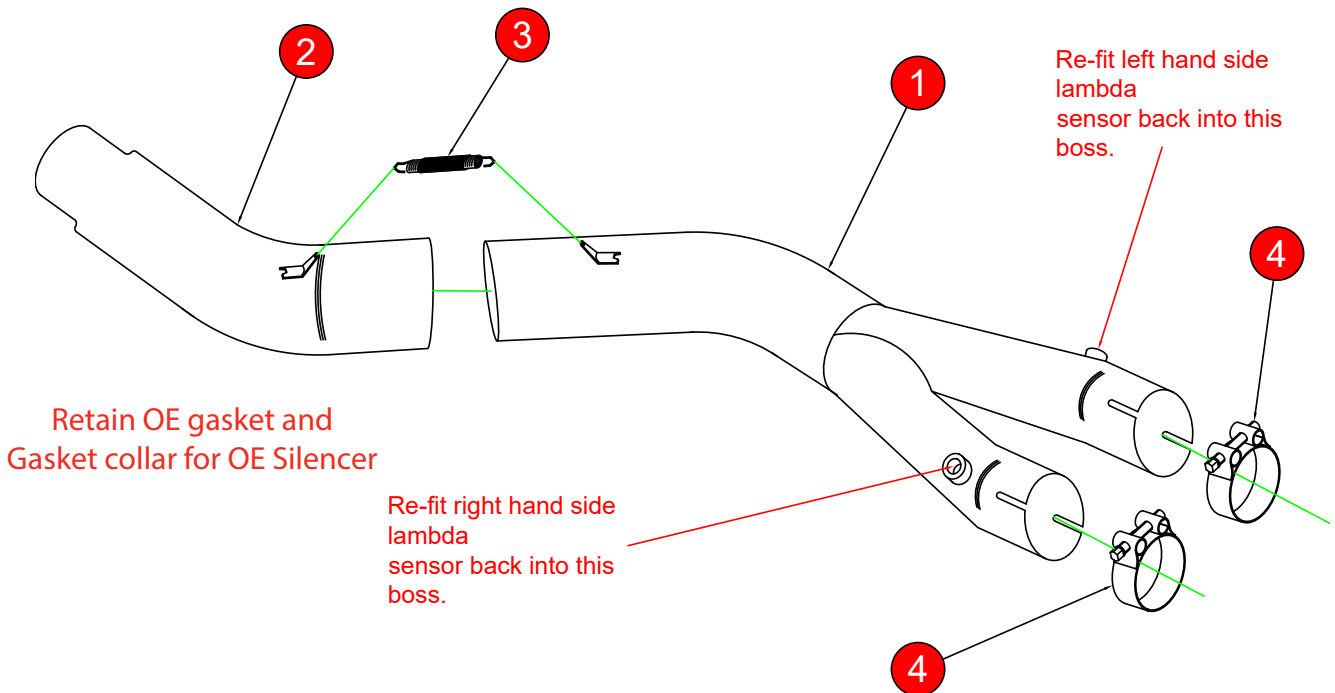

- | | |
|-------------------------|-------------------------------------|
| 1 Connecting Pipe CP915 | 3 Rubber Coated Spring (Z028.10030) |
| 2 Connecting Pipe CP916 | 4 2 x 51-55mm Clamp (Z016.10002) |

ISSUE NO.	02
DATE	22/10/2018
AUTHORISED	J.Harkin
CHECKED	

NOTE: ENSURE SCORPION SYSTEM IS CLEAR OF MOVING PARTS AND ALL ORIGINAL FUNCTIONS WORK CORRECTLY.



Fitted with original silencer. Retain OE gasket and gasket collar

When removing the O.E catalyst, disconnect the valve cables and remove them from the bike.



Fitted with Scorpion serket taper silencer (RYA-102).



Fitted with Scorpion RP1-GP silencer (YA-1003).