

Bike	Kawasaki Z900	Part No.	RKA-114-MA
Year	2017-Current	Fit Kit	Z039.10616
Notes	Where not supplied use original fittings. The catalyst and dB killer must be fitted for EC approval to be valid.	dB Killer	Z038.10565 (TYPE WW) - RKA-114 Z038.10530 (TYPE EE) - KA-1013

Estimated Fitting Time: 1 Hour 30 Minutes

When fitting headers with Scorpion slip-on (RKA-114 or KA-1013) use heat shield and clamp supplied with the slip-on.

When fitting the headers with original silencer use the original clamp and gasket then bolt the silencer heat shield to the pipe work.

Catalyst must be fitted for EC approval to be valid. To purchase a catalyst contact your local Scorpion dealer. Part number : SCC106

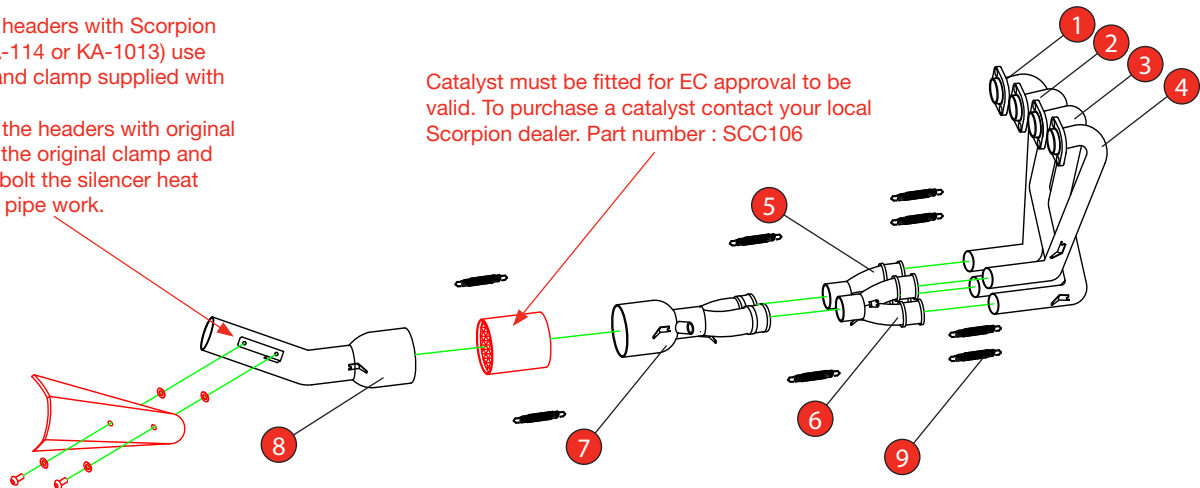

NO.	PART NO.	DESCRIPTION	QTY
1	Z035.10963	L/H Outside Header Pipe	1
2	Z035.10964	L/H Inside Header Pipe	1
3	Z035.10965	R/H Inside Header Pipe	1
4	Z035.10966	R/H Outside Header Pipe	1
5	Z035.10967	L/H Primary Collector	1
6	Z035.10968	R/H Primary Collector	1
7	Z035.10969	Secondary Collector	1
8	Z035.10970	Connecting Pipe	1
Fit Kit - Z039.10616			
9	Z028.10030	Rubber Coated Spring	8
10	Z038.10565	Type 'WW' DB Killer (To be fitted with Scorpion Serket Taper RKA-114)	1
11	Z017.12707	M6 x 10mm Button Head Bolt (Use to fit item 11)	1
12	Z017.10027	M6 Spring Washer (Use to fit item 11)	1

E-MARK	e11 00516
DATE	10/01/18
ISSUE	00
AUTHORISED	M.Ydlibi

NOTE: ENSURE SCORPION SYSTEM IS CLEAR OF MOVING PARTS AND ALL ORIGINAL FUNCTIONS WORK CORRECTLY.



STAY CONNECTED TO RED POWER.

Bike	Kawasaki Z900	Part No.	RKA-114-MA
Year	2017-Current	Fit Kit	Z039.10616
Notes	Where not supplied use original fittings. The catalyst and dB killer must be fitted for EC approval to be valid.	dB Killer	Z038.10565 (TYPE WW) - RKA-114 Z038.10530 (TYPE EE) - KA-1013



Fitted with Scorpion serket taper slip-on RKA-114



Fitted with Scorpion RP1-GP slip-on KA-1013

A) Remove original exhaust from bike, taking care to keep all original components in a safe place.

B) Refit Scorpion exhaust as per line diagram above.

C) When fitted take bike for a short ride to ensure all functions are correct.

D) When bike & exhaust are cool enough check all nuts and bolts are still secure.

Thank you for purchasing your Scorpion Silencer.

Care of your exhaust: Please refrain from cleaning silencer with heavy solvents or abrasives!

Vielen Dank Für den kauf eines Scorpion Schalldampfers! Pflegehinweis: Bitte verwenden Sie niemals Scheuermittel oder aggressive Reiniger zur Pflege Ihres Auspuffes!

Merci d'avoir choisi un echappement Scorpion.

Entretien de votre silencieux: Ne pas utiliser de solvants ou de produits abrasifs!

Muchas gracias por adquirir un Silencioso Scorpion. Le recomendamos no limpiar el silencioso con productos abrasivos o aquellos que contengan disolventes.



STAY CONNECTED TO RED POWER.