

Box: PLOCK 1

BIKE	SUZUKI GSXR 600 WV	PART NO.	ESI - 56
YEAR	1997 - 2000	FIT KITS	OVAL Z039.11078 // ROUND Z039.10078
NOTES	Ensure billet is fitted with M8 x 16 cap heads & spring washers prior to despatch	DB-Killer	SCEXDBK12 - (Type B)

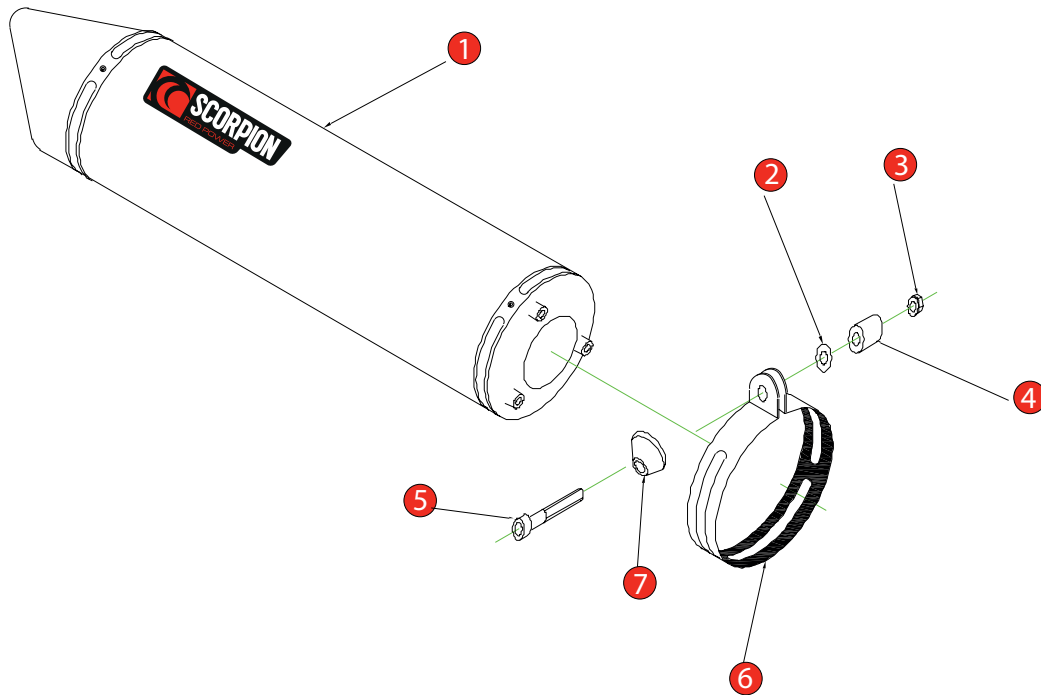

- | | |
|---|---|
| 1 | 450mm Silencer (R-ZE40.03A) (O-ZE40.04A) |
| 2 | M8 X 25mm Washer (Z017.10825) |
| 3 | M8 Nyloc Nut (Z017.10062) |
| 4 | 10mm Spacer (Z026.10004) |
| 5 | M* x 60mm Cap Head Bolt (Z017.10080) |
| 6 | Composite Strap (R-Z038.10090) (O-Z038.10088) |
| 7 | Aluminium Bolt Finisher (Z026.20068) |

E-MARK ROUND	SCDB-RB e4 2103
E-MARK OVAL	SCDB-OB e4 2104
ISSUE NO.	06
DATE	14/12/2018
AUTHORISED	J.Harkin
CHECKED	

NOTE: ENSURE SCORPION SYSTEM IS CLEAR OF MOVING PARTS AND ALL ORIGINAL FUNCTIONS WORK CORRECTLY.

A) Remove original exhaust from bike, taking care to keep all original components in a safe place.

B) Refit Scorpion exhaust as per line diagram above.

C) When fitted take bike for a short ride to ensure all functions are correct.

D) When bike & exhaust are cool enough check all nuts and bolts are still secure.