

Box: PLOCK 2

BIKE	SUZUKI GSX 750F / 600F	PART NO.	ESI - 64
YEAR	1997 - 2006	FIT KITS	OVAL Z039.11085 // ROUND Z039.10085
NOTES	Use standard fittings where not supplied <b>Remove standard gasket if fitted.</b>	DB-Killer	SCEXDBK12 - (Type B)

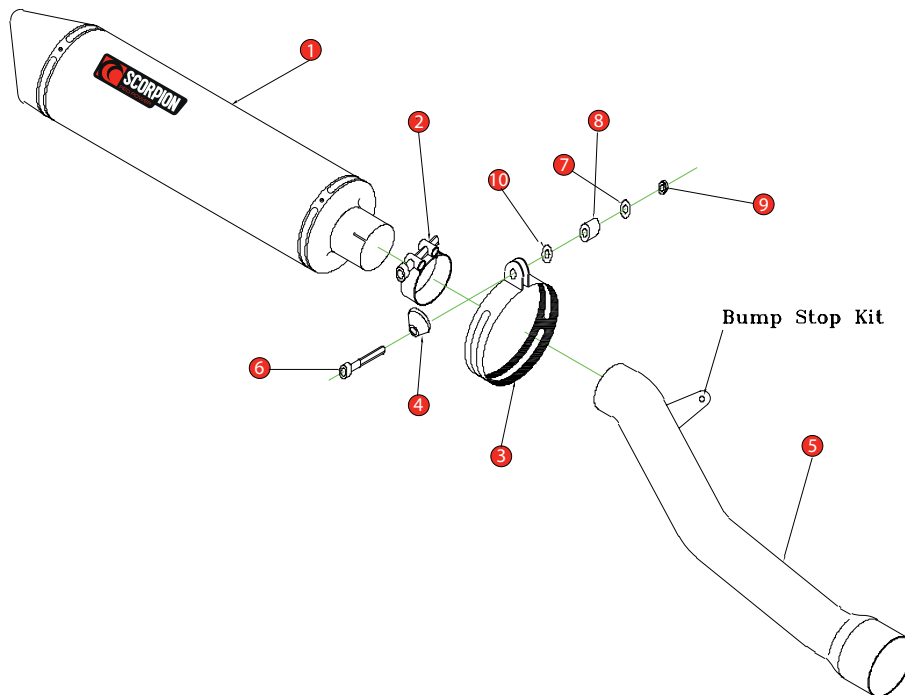

1 450mm Silencer ESC 93	8 10mm Aluminium Spacer (Z026.10004)
2 51-55mm Band Clamp (Z016.10002)	9 M8 Nyloc Nut (Z017.10062)
3 Composite silencer strap (R-Z038.10089)(O-Z038.10088)	10 M8 x 25mm WAsher (Z017.10825)
4 Aluminium Bolt Finisher(Z026.20068)	11 Bump Stop Kit (Z017.10010)
5 Connecting Pipe CP 33	
6 M8 x 60mm Cap Head Bolt (Z017.10080)	
7 2 x M8 x 17mm Washers (Z017.10831)	

E-MARK ROUND	BSAU 193a 1990/t3
E-MARK OVAL	BSAU 193a 1990/t3
ISSUE NO.	07
DATE	04/08/21
AUTHORISED	M.Ydlibi
CHECKED	

**NOTE:** ENSURE SCORPION SYSTEM IS CLEAR OF MOVING PARTS AND ALL ORIGINAL FUNCTIONS WORK CORRECTLY.

A) Remove original exhaust from bike, taking care to keep all original components in a safe place.

B) Refit Scorpion exhaust as per line diagram above.

C) When fitted take bike for a short ride to ensure all functions are correct.

D) When bike & exhaust are cool enough check all nuts and bolts are still secure.