

Box: PLOCK 1

BIKE	Yamaha YZF-R6	PART NO.	EYA-73
YEAR	2006-Current	FIT KITS	OVAL Z039.11194
NOTES	Use standard fittings where not supplied Remove standard gasket if fitted.	DB-Killer	SCEXDBK11 - (Type A)

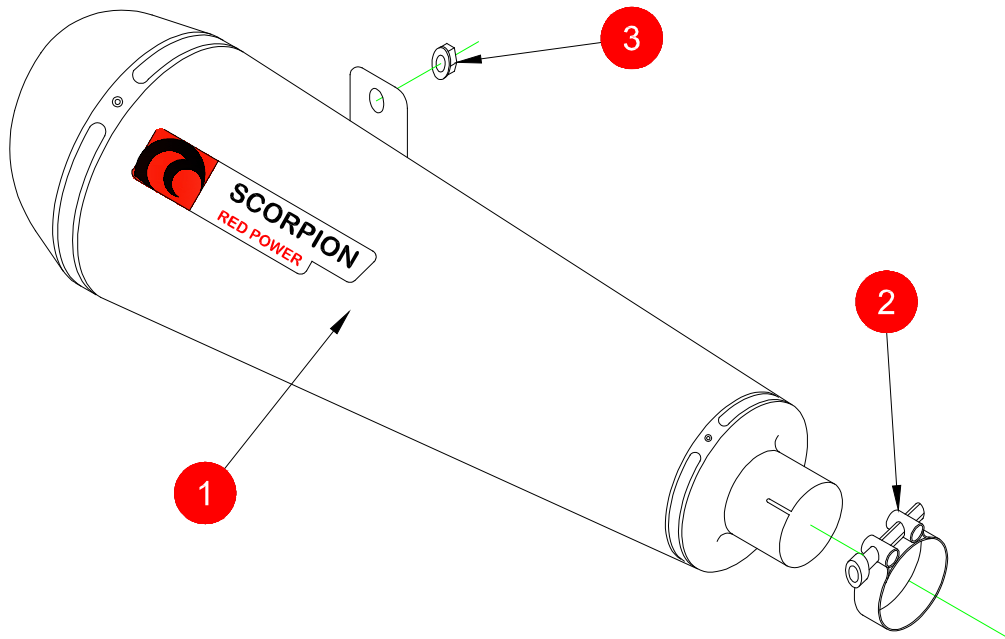

- 1 275mm Silencer ESC 86
- 2 47-51mm Band Clamp (Z016.10003)
- 3 M8 Nyloc Nut (Z017.10062)
- 4 100mm Cable Tie (Z017.10062)

E-MARK ROUND	N/A
E-MARK OVAL	SC-86 [e4] 2217
ISSUE NO.	08
DATE	23/10/2018
AUTHORISED	J.Harkin
CHECKED	

NOTE: ENSURE SCORPION SYSTEM IS CLEAR OF MOVING PARTS AND ALL ORIGINAL FUNCTIONS WORK CORRECTLY.



Box: PLOCK 1

BIKE	Yamaha YZF-R6	PART NO.	EYA-73
YEAR	2006-Current	FIT KITS	OVAL Z039.11194
NOTES	Use standard fittings where not supplied Remove standard gasket if fitted.	FEATURES	

CONTINUED FROM OVERLEAF:

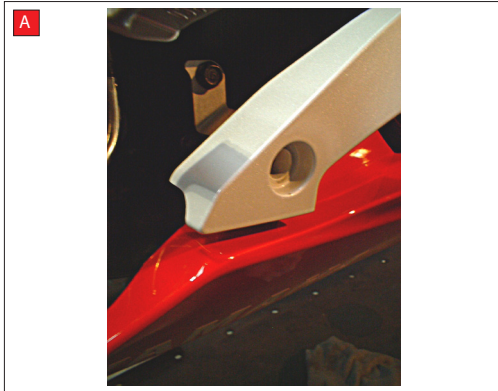

A) Remove lower fairing bolt to aid access to OE silencer clamp



B) Remove the three bolts shown to expose the expul valve & cables

C) Disconnect the cables by unscrewing the adjusting nuts & lift the nipples out of the wheel

You can now remove the OE silencer by removing the clamp & top hanging bolt

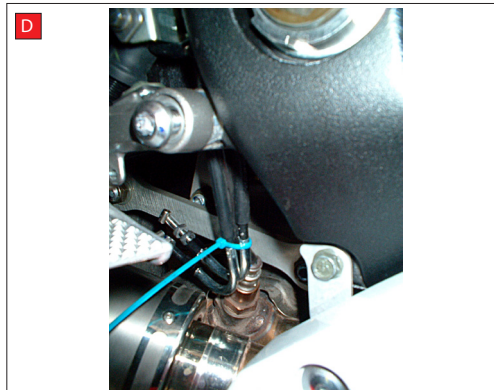
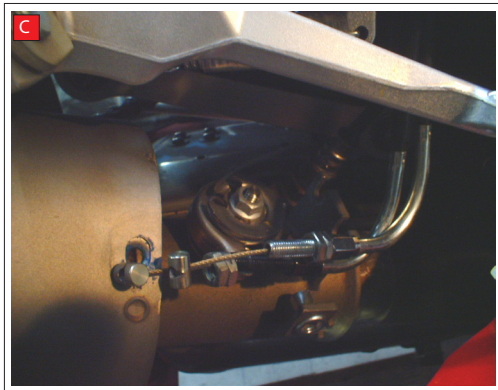

D) Before fitting the Scorpion silencer, use the cable-tie to safely attach the loose cables to the lambda sensor wire & trim the cable-tie.

E) Now remove the O.E flare and gasket from the exhaust so Scorpion product can fit the O.E.

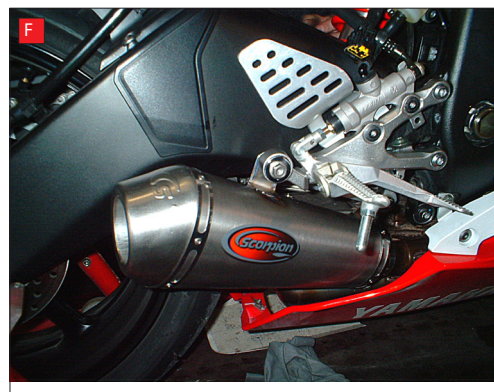

F) Fit the Scorpion silencer with the new clamp & OE bolt and fasten securely with the Nyloc nut, then tighten the clamp.

Ensure all cables and any fitments are secured safely and all original functions work correctly prior to use.