

Bike	Yamaha XSR-125	Part No.	RYA-117-SYS
Year	2021-Current	Fit Kit	Z039.10706
Notes	Where not supplied use original fittings. Remove OE Gaskets for correct fitment.	dB Killer	SCEXDBK23 - (TYPE V)

Estimated Fitting Time: 90 Minutes

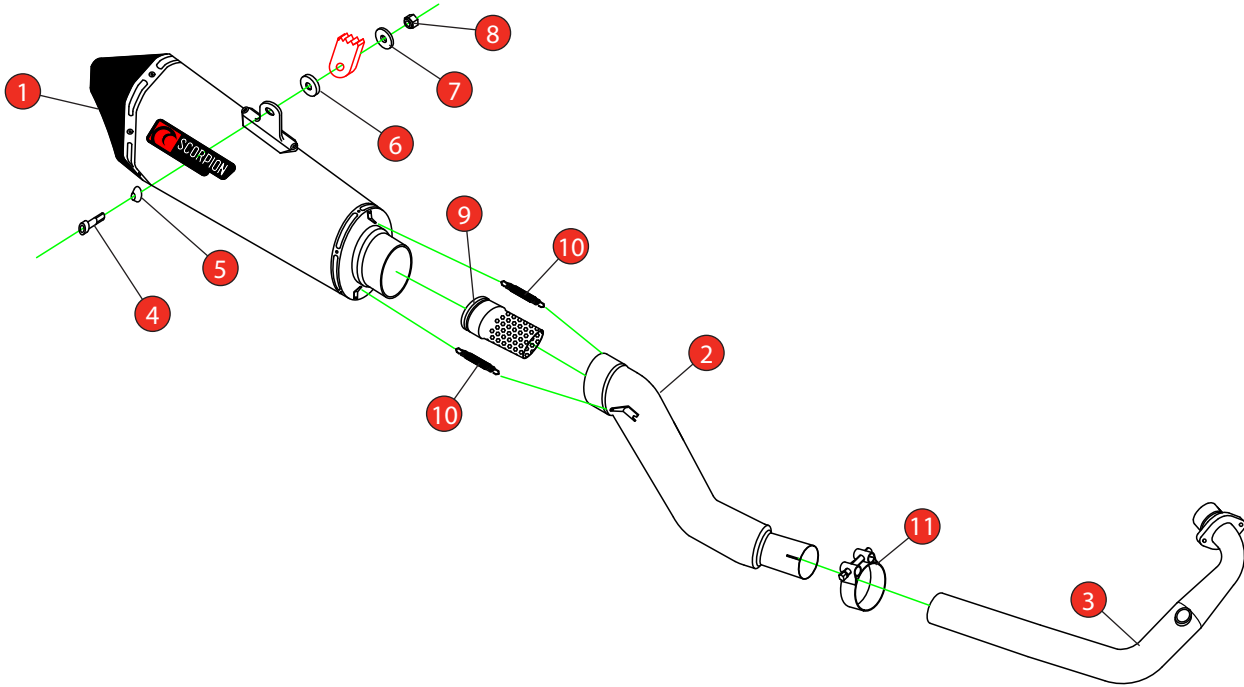

NO.	PART NO.	DESCRIPTION	QTY
1	RSC231	Serket Taper Silencer	1
2	CP1039	Connecting Pipe	1
3	CP1121	Header Pipe	1
Fit Kit - Z039.10706			
4	Z017.10079	M8 x 55mm Cap Head Bolt	1
5	Z026.20068	Alloy Bolt Finisher	1
6	Z026.20309	Ø30 x 10mm Anodised Alloy Spacer	1
7	Z017.10825	M8 Washer	1
8	Z017.10062	M8 Nyloc Nut	1
9	Z028.20264	Open End Internal Flute	1
10	Z028.10030	Rubber Coated Spring	2
11	Z016.10008	43-47mm Band Clamp	1
12	Z017.12732	Tie Wrap for Lambda Sensor Cable	1

E-MARK	BSAU 193a 1993t3
DATE	20/01/22
ISSUE	00
AUTHORISED	S Shipley

NOTE: ENSURE SCORPION SYSTEM IS CLEAR OF MOVING PARTS AND ALL ORIGINAL FUNCTIONS WORK CORRECTLY.

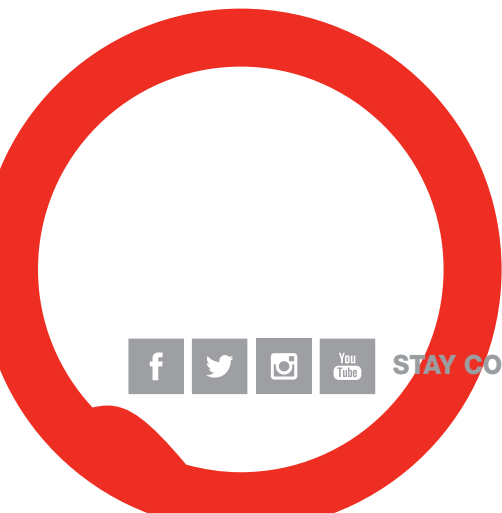

STAY CONNECTED TO RED POWER.

Bike	Yamaha XSR-125	Part No.	RYA-117-SYS
Year	2021-Current	Fit Kits	Z039.10706
Notes	Where not supplied use original fittings. Remove OE Gaskets for correct fitment.	dB Killer	SCEXDBK23 - (TYPE V)

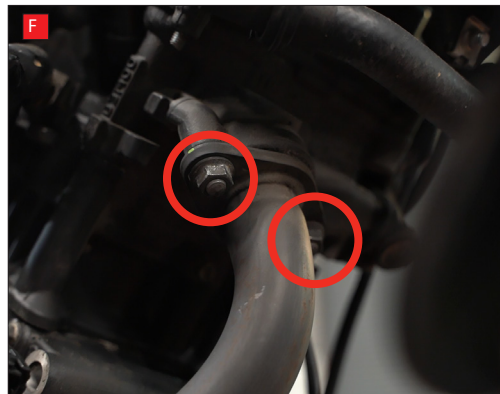
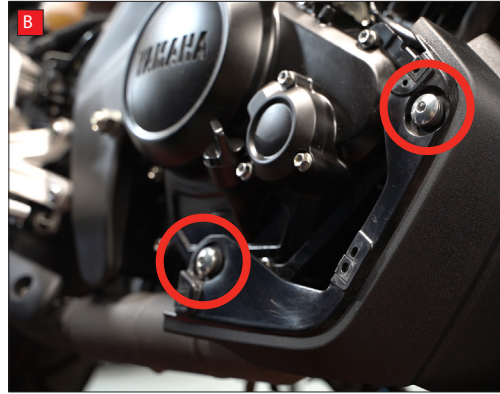
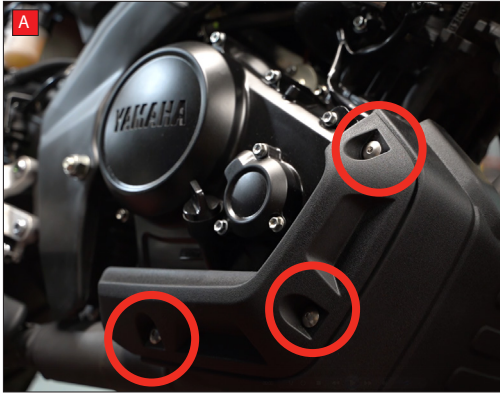

PLEASE NOTE: The images show fitting of the Red Power silencer, the Serket Taper silencer is fitted in the same way.

A) Remove the 3 screws on the right side lower front panel and then the 3 on the left side as well.

B) You will now have access to a further 2 screws each side. Remove these screws and the front panel will come away from the bike.

C) Cut the cable tie that holds the lambda sensor wiring to the bike.

D) Unplug the Lambda sensor by lifting the small tab circled and pulling the 2 halves apart.

E) Remove the Lambda sensor from the pipe.

F) Remove the 2 header pipe nuts.

G) Loosen the nut and bolt attaching the rear silencer to the mounting bracket. Remove the nut but leave the bolt in place to support the weight of the exhaust.

H) Supporting the system with both hands carefully pull the exhaust away from the header studs at the front and from the mounting bracket at the back of the system.

Bike	Yamaha XSR-125	Part No.	RYA-117-SYS
Year	2021-Current	Fit Kits	Z039.10706
Notes	Where not supplied use original fittings. Remove OE Gaskets for correct fitment.	dB Killer	SCEXDBK23 - (TYPE V)

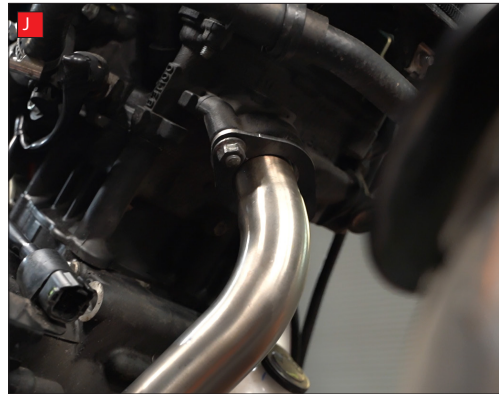
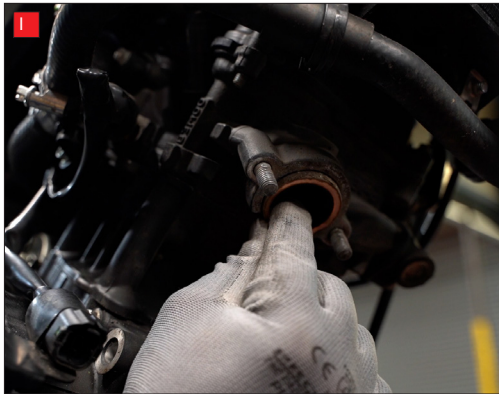

I) If the exhaust gasket has stayed on the engine, remove it now as it's not required with the Scorpion system.

J) Attach the Scorpion header pipe to the bike using the original header nuts. At this stage you should leave the nuts a little loose to allow for some adjustment of the system.



K) Slide the connecting pipe along with the clamp onto the header pipe. Do not tighten the clamp at this stage.

L) OPTIONAL - In the fitting kit we supply a Flute to place between the connecting pipe and the silencer. This is an optional part to reduce the sound level. If you wish to use it now is the time to insert it into the connecting pipe.



M) Slide the rear silencer onto the connecting pipe and align the system with the original mounting bracket on the bike.

N) Bolt the rear silencer to the original mounting bracket using the supplied hardware and spacer. Use the diagram on the first page to see the order they need to be fitted. Leave slightly loose until the rest of the system has been adjusted and tightened.



O) Adjust the system so that it is positioned correctly, there is no stress on any of the joints and it has good clearance to parts around it. Then fully tighten the 2 header nuts.

P) Fully tighten the clamp between the header pipe and the connecting pipe.

Bike	Yamaha XSR-125	Part No.	RYA-117-SYS
Year	2021-Current	Fit Kits	Z039.10706
Notes	Where not supplied use original fittings. Remove OE Gaskets for correct fitment.	dB Killer	SCEXDBK23 - (TYPE V)



Q) Fully tighten the rear silencer mounting hardware.

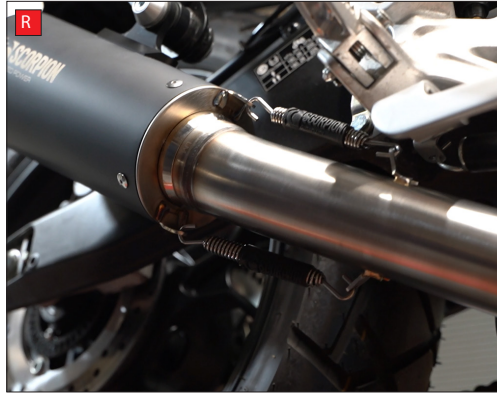

R) Attach both springs between the silencer and connecting pipe.

S) Screw the Lambda sensor into the Scorpion header pipe and fully tighten.

T) Plug in the Lambda sensor.

U) Secure the Lambda sensor wire to the bracket using the tie wrap provided in the fitting kit and trim off the excess.

V) Refit the lower front panel and it's trim panels in reverse order to how you removed it.

Take the bike for a short ride to ensure all functions are correct. Once the bike & exhaust are cool enough, check all nuts and bolts are still secure.

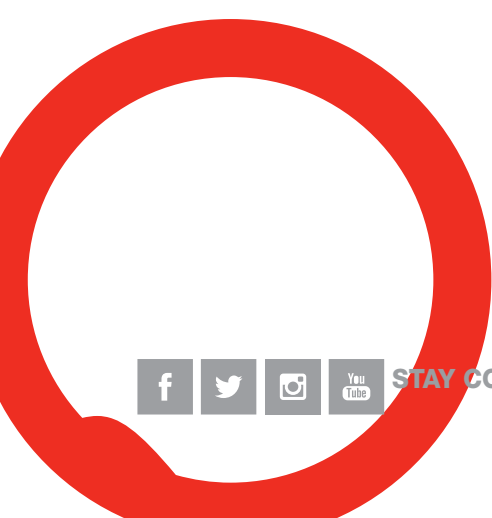
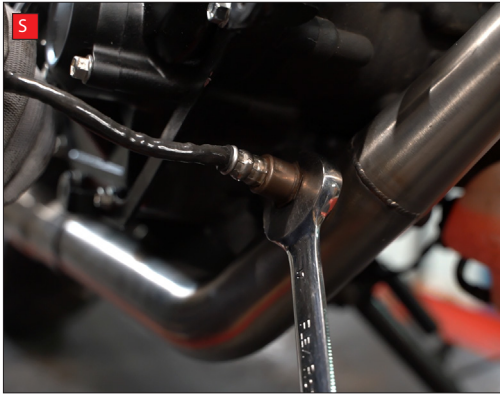

Bike	Yamaha XSR-125	Part No.	RYA-117-SYS
Year	2021-Current	Fit Kit	Z039.10706
Notes	Where not supplied use original fittings. Remove OE Gaskets for correct fitment.	dB Killer	SCEXDBK23 - (TYPE V)

Estimated Fitting Time: 90 Minutes



Thank you for purchasing your Scorpion Silencer.

Care of your exhaust: Please refrain from cleaning silencer with heavy solvents or abrasives!

Vielen Dank Für den kauf eines Scorpion Schalldampfers! Pflegehinweis: Bitte verwenden Sie niemals Scheuermittel oder aggressive Reiniger zur Pflege Ihres Auspuffes!

Merci d'avoir choisi un echappement Scorpion.

Entretien de votre silencieux: Ne pas utiliser de solvants ou de produits abrasifs!

Muchas gracias por adquirir un Silencioso Scorpion. Le recomendamos no limpiar el silencioso con productos abrasivos o aquellos que contengan disolventes.



STAY CONNECTED TO RED POWER.