

BIKE	Yamaha YZF-R1	PART NO.	EYA-85
YEAR	2009-14	FIT KITS	OVAL Z039.11347
NOTES	Use standard fittings where not supplied Remove standard gasket if fitted.	DB-Killer	2 x SCEXDBK12 - (Type B)

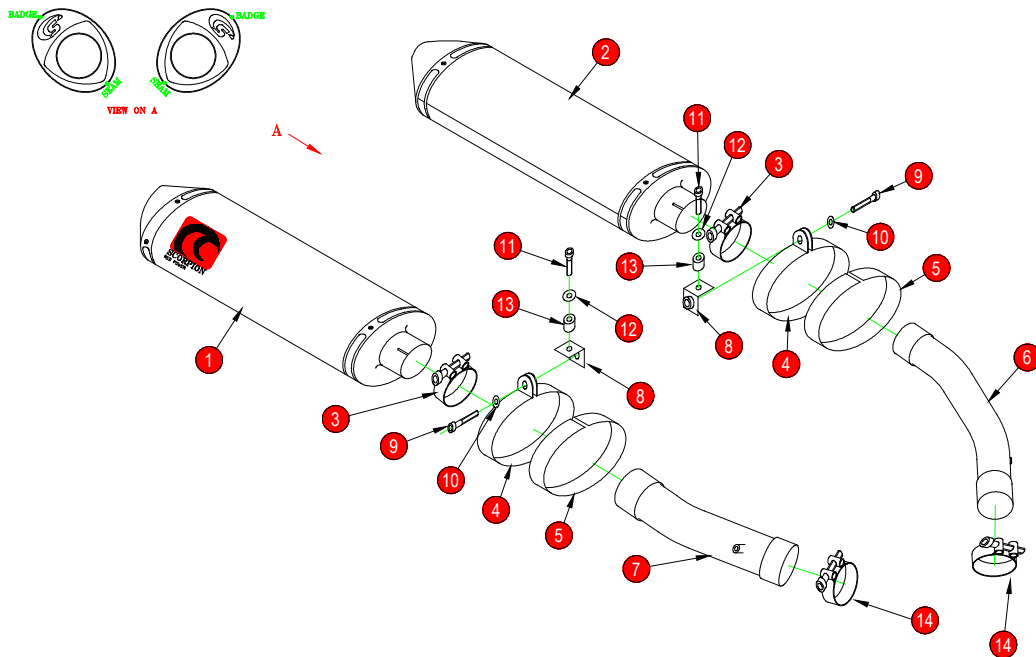

- | | |
|---|---|
| 1 300mm Silencer ESC 151 (Rotated 45°) | 8 2 x Mounting Brackets (Z015.10090) |
| 2 300mm Silencer ESC 152 (Rotated 45°) | 9 2 x M8 x 16mm Cap Head Bolts (Z017.10808) |
| 3 2 x 51-55mm Band Clamps (Z016.10002) | 10 4 x M8 x 17mm Washers (Z017.12754) |
| 4 2 x Phased Silencer Straps (Z028.10271) | 11 2 x M8 x 30mm Cap Head Bolts (Z017.10074) |
| 5 2 x Protective Rubber Strips (Z029.10022) | 12 2 x M8 x 30mm Washers (Z017.12754) |
| 6 Connecting Pipe CP536 - See Note 2 | 13 2 x 15mm Alloy Spacers (Z026.10005) - See Note 1 |
| 7 Connecting Pipe CP537 - See Note 2 | 14 2 x 43x47mm Band Clamps (Z016.10008) |

E-MARK ROUND	N/A
E-MARK OVAL	YA-85 2325
ISSUE NO.	03
DATE	23/10/2018
AUTHORISED	J.Harkin
CHECKED	

NOTE: ENSURE SCORPION SYSTEM IS CLEAR OF MOVING PARTS AND ALL ORIGINAL FUNCTIONS WORK CORRECTLY.



BIKE	Yamaha YZF-R1	PART NO.	EYA-85
YEAR	2009-14	FIT KITS	OVAL Z039.11347
NOTES	Use standard fittings where not supplied Remove standard gasket if fitted.	FEATURES	

CONTINUED FROM OVERLEAF:

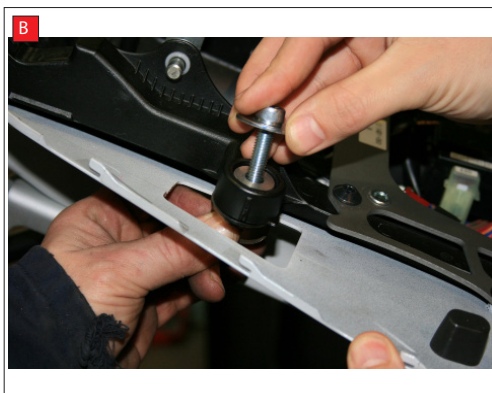

A) Remove O.E exhaust from bike and remove highlighted rubber bush.

B) Install Scorpion supplied mountings.

C) Attach O.E heatshields to Scorpion link pipes, using O.E fixings.

D) Put back on O.E pipework.

E) Install silencers to pipework.



F) Fit silencer strap round silencer and bolt to scorpion mountings. ensure silencer is square and fitted correctly then tighten up all nuts, bolts and clamps.

G) repeat steps A-F for opposite side of bike then refit all O.E plastics that have been removed.



When all the above steps have been completed ensure that all original functions are working correctly, take your bike out for a short journey, upon return allow your bike to cool before rechecking all nuts and bolts.