

<b>Bike</b>	Yamaha YZF-R125 Euro 5+ / R15 V4 M	<b>Part No.</b>	PYA-129-SYS
<b>Year</b>	2024-Current	<b>Fit Kit</b>	Z039.10755
<b>Notes</b>	Where not supplied use original fittings. Remove OE Gaskets for correct fitment.	<b>dB Killer</b>	SCEXDBK49 - (TYPE PD)

Estimated Fitting Time: 90 Minutes

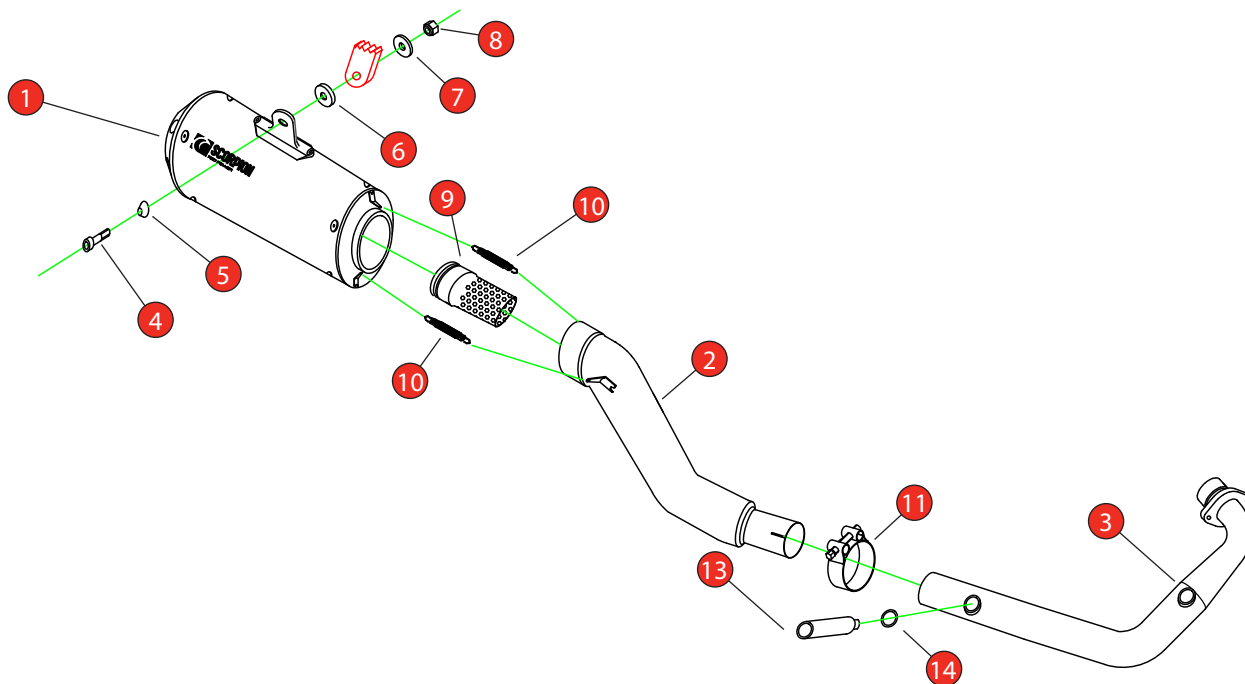

NO.	PART NO.	DESCRIPTION	QTY
1	PSC445	Red Power Silencer	1
2	CP1040	Connecting Pipe	1
3	CP1192	Header Pipe	1
<b>Fit Kit - Z039.10755</b>			
4	Z017.10079	M8 x 55mm Cap Head Bolt	1
5	Z026.20068	Alloy Bolt Finisher	1
6	Z026.20309	Ø30 x 10mm Anodised Alloy Spacer	1
7	Z017.10825	M8 Washer	1
8	Z017.10062	M8 Nyloc Nut	1
9	Z028.20264	Open End Internal Flute	1
10	Z028.10030	Rubber Coated Spring	2
11	Z016.10008	43-47mm Band Clamp	1
12	Z017.12732	Tie Wrap for Lambda Sensor Cable	1
13	Z026.20185	M12 Lambda Catalyst	1
14	Z017.10728	M12 Copper Washer	1

CLASSIFICATION	Closed Circuit Product
HOMOLOGATED	NO
DATE	17/04/24
ISSUE	00
AUTHORISED	G. O'Shea

**NOTE:** ENSURE SCORPION SYSTEM IS CLEAR OF MOVING PARTS AND ALL ORIGINAL FUNCTIONS WORK CORRECTLY.

STAY CONNECTED TO RED POWER.

<b>Bike</b>	Yamaha YZF-R125 Euro 5+ / R15 V4 M	<b>Part No.</b>	PYA-129-SYS
<b>Year</b>	2024-Current	<b>Fit Kits</b>	Z039.10755
<b>Notes</b>	Where not supplied use original fittings. Remove OE Gaskets for correct fitment.	<b>dB Killer</b>	SCEXDBK49 - (TYPE PD)



A) On the right side of the bike, remove the lower fairing bolt. This has a nut on the back so you will need to use a spanner as well as a allen key.

B) Remove the bolt from the upper part of the fairing.

C) Remove the upper bolt from the front panel.

D) Remove the 2 lower bolts from the front panel.



E) On the left side of the bike, remove the upper bolt from the front panel.

F) Remove the 2 push clips from underneath the front panel. These release by pushing the centre inwards.

G) Release the clips that hold the fairings to the front panel then remove it from the bike.



H) On the right side of the bike, remove the 2 bolts that join the lower fairing to the upper fairing.

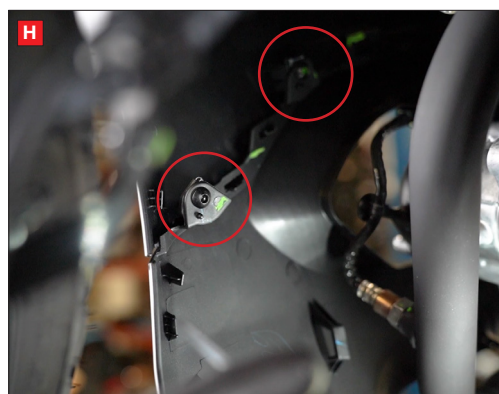



<b>Bike</b>	Yamaha YZF-R125 Euro 5+ / R15 V4 M	<b>Part No.</b>	PYA-129-SYS
<b>Year</b>	2024-Current	<b>Fit Kits</b>	Z039.10755
<b>Notes</b>	Where not supplied use original fittings. Remove OE Gaskets for correct fitment.	<b>dB Killer</b>	SCEXDBK49 - (TYPE PD)

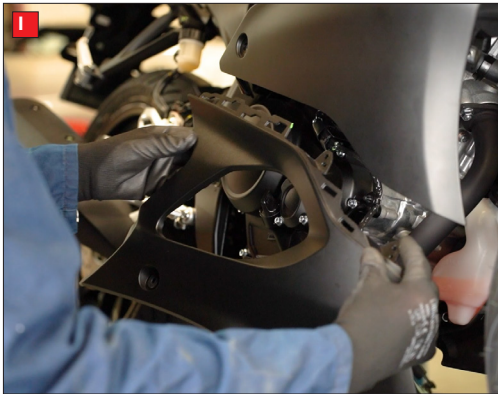

I) Carefully remove the lower fairing.

J) Remove both Lambda sensors from the original exhaust.

K) Remove the 2 header nuts.

L) Support the weight of the exhaust, then remove the silencer mounting bolt.

M) Carefully remove the original exhaust from the bike.

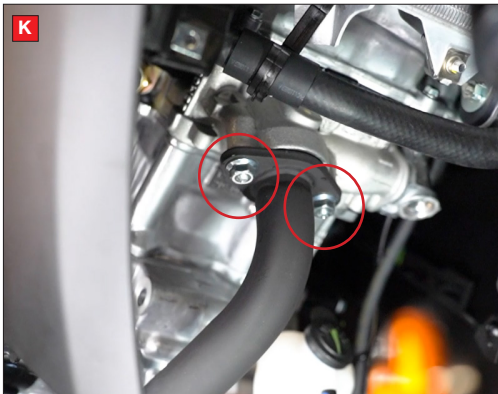

N) Remove the original gasket from the header port.

O) Fit the Scorpion header pipe to the bike and loosely secure in place with the original header nuts. Do not fully tighten, you will do that in a later step.

P) Slide the Scorpion connecting pipe and the clamp on to the header pipe.

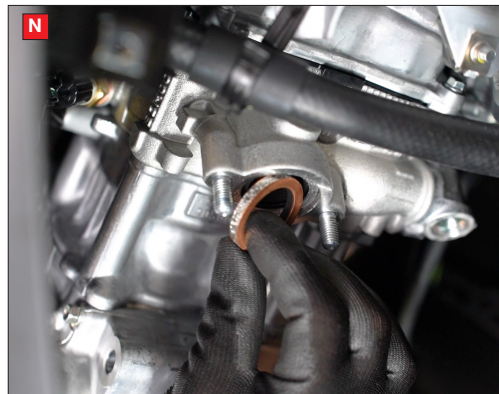



<b>Bike</b>	Yamaha YZF-R125 Euro 5+ / R15 V4 M	<b>Part No.</b>	PYA-129-SYS
<b>Year</b>	2024-Current	<b>Fit Kits</b>	Z039.10755
<b>Notes</b>	Where not supplied use original fittings. Remove OE Gaskets for correct fitment.	<b>dB Killer</b>	SCEXDBK49 - (TYPE PD)



Q) Slide the Scorpion silencer and flute (optional) onto the connecting pipe and align the silencer mounting bracket with the original mount on the bike.

**NOTE: THE SCORPION SILENCER MOUNTS TO THE OUTSIDE OF THE FRAME UNLIKE THE ORIGINAL WHICH MOUNTED TO THE INSIDE.**

R) Use the supplied spacer and mounting hardware to attach the silencer to the frame. Do not fully tighten yet, you will do this in a later step.

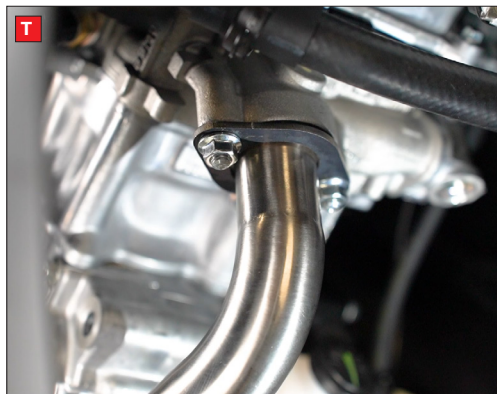

S) Fit the springs between the spring hoops.

T) Fully tighten the header nuts.

U) Fully tighten the clamp.

V) Fully tighten the silencer mounting bolt.



W) Fit both Lambda sensors to the Scorpion header pipe. The rear sensor should be fitted with the Lambda Catalyst and copper washer as per the diagram on the front page.

X) Re-fit the fairing and front panel. Installation steps are reverse of removal.

When fitted take bike for a short ride to ensure all functions are correct. When bike & exhaust are cool enough check all nuts and bolts are still secure.



<b>Bike</b>	Yamaha YZF-R125 Euro 5+ / R15 V4 M	<b>Part No.</b>	PYA-129-SYS
<b>Year</b>	2024-Current	<b>Fit Kit</b>	Z039.10755
<b>Notes</b>	Where not supplied use original fittings. Remove OE Gaskets for correct fitment.	<b>dB Killer</b>	SCEXDBK49 - (TYPE PD)

Estimated Fitting Time: 90 Minutes



Thank you for purchasing your Scorpion Silencer.

Care of your exhaust: Please refrain from cleaning silencer with heavy solvents or abrasives!

Vielen Dank Für den kauf eines Scorpion Schalldampfers! Pflegehinweis: Bitte verwenden Sie niemals Scheuermittel oder aggressive Reiniger zur Pflege Ihres Auspuffes!

Merci d'avoir choisi un echappement Scorpion.

Entretien de votre silencieux: Ne pas utiliser de solvants ou de produits abrasifs!

Muchas gracias por adquirir un Silencioso Scorpion. Le recomendamos no limpiar el silencioso con productos abrasivos o aquellos que contengan disolventes.



STAY CONNECTED TO RED POWER.