

Bike	Yamaha X-Max 125cc	Part No.	RYA-105
Year	2008-2016	Fit Kits	Z039.10607
Notes	Where not supplied use original fittings	dB Killer	SCEXDBK42 - (Type MM)

Estimated Fitting Time: 60 Minutes

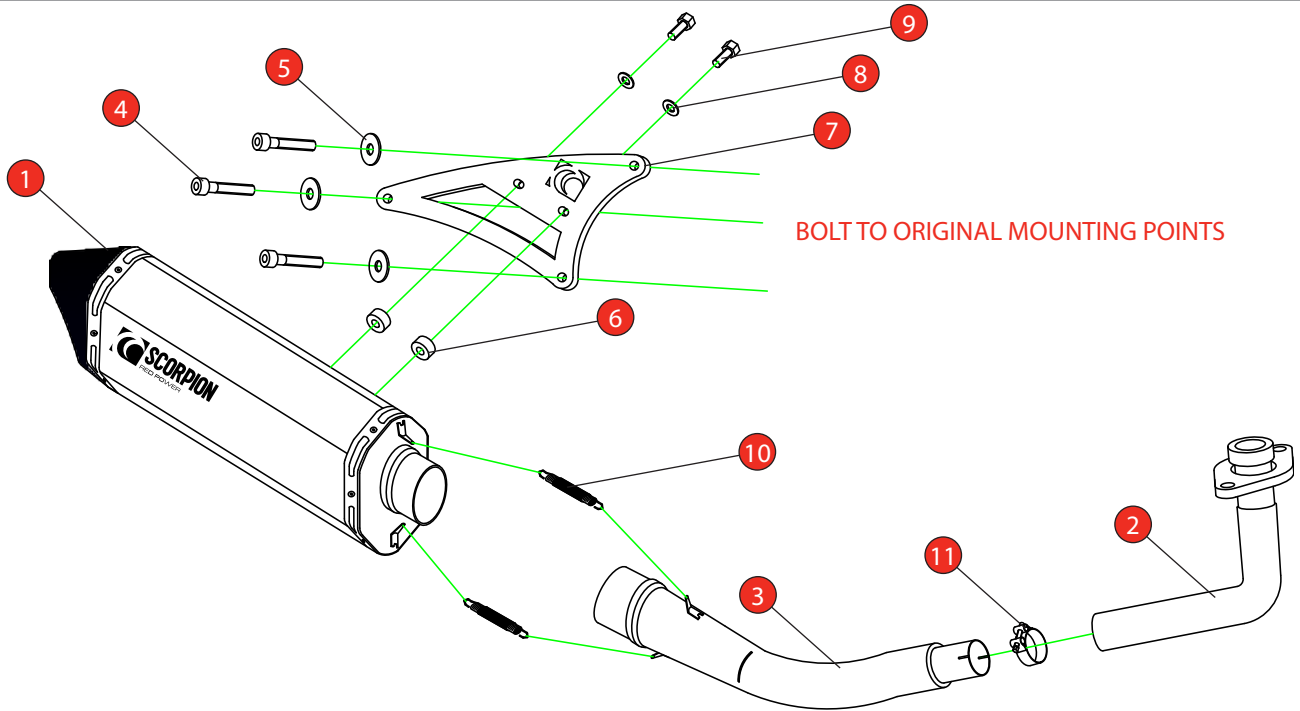

NO.	PART NO.	DESCRIPTION	QTY
1	RSC405	Serket Parallel Silencer	1
2	Z035.10948	Header Pipe	1
3	Z035.10949	Connecting Pipe	1
Fit Kit - Z039.10607			
4	Z017.12715	M10 x 50mm Fine Thread Cap Head Bolt	3
5	Z017.11015	M10 x 25mm Washer	3
6	Z026.20049	M8 x 5mm Alloy Spacer	2
7	Z007.31515	Mounting Bracket	1
8	Z017.10831	M8 x 17mm Washer	2
9	Z017.10044	M8 x 20mm Hex Head Bolt	2
10	Z028.10030	Rubber Coated Spring	2
11	Z016.10010	34-37mm Clamp	1

E-MARK	BSAU 193a 1990/t3
DATE	24/10/2018
ISSUE	02
AUTHORISED	J.Harkin

NOTE: ENSURE SCORPION SYSTEM IS CLEAR OF MOVING PARTS AND ALL ORIGINAL FUNCTIONS WORK CORRECTLY.



STAY CONNECTED TO RED POWER.

Bike	Yamaha X-Max 125cc	Part No.	RYA-105
Year	2008-2016	Fit Kits	Z039.10607
Notes	Where not supplied use original fittings	dB Killer	SCEXDBK42 - (Type MM)



A) Unbolt the lambda sensor from the original pipework, then remove original exhaust from bike. Taking care to keep all original components in a safe place.

B) Fit the header pipe using O.E nuts finger tight, then re-fit the lambda sensor and tighten fully.

C) Slide the connecting pipe onto the header pipe, remember to have the clamp loosely over the connecting pipe.

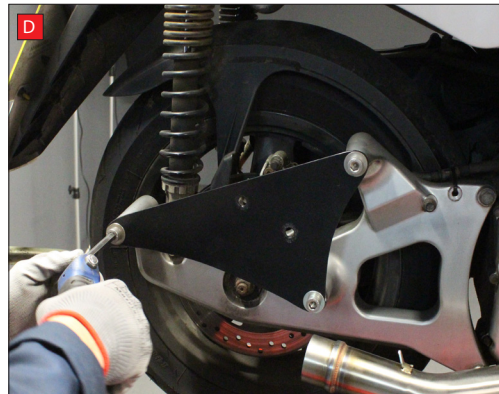

D) Fully bolt the bracket to the bike.

E) Slide the silencer on to the connecting pipe.

F) Mount the silencer to the bracket ensuring you're using the correct bolts and spacers. Once happy with the alignment of the system tighten all fittings.

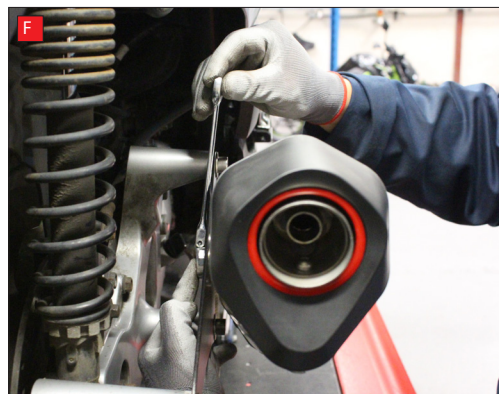

G) Fit the springs to secure the fitting between the silencer and connecting pipe.

H) When fitted, take scooter for a short test run, upon return allow bike to cool and check all nuts and bolts are secure.



Bike	Yamaha X-Max 125cc	Part No.	RYA-105
Year	2008-2016	Fit Kits	Z039.10607
Notes	Where not supplied use original fittings	dB Killer	SCEXDBK42 - (Type MM)

Estimated Fitting Time: 60 Minutes



Thank you for purchasing your Scorpion Silencer.

Care of your exhaust: Please refrain from cleaning silencer with heavy solvents or abrasives!

Vielen Dank Für den kauf eines Scorpion Schalldampfers! Pflegehinweis: Bitte verwenden Sie niemals Scheuermittel oder aggressive Reiniger zur Pflege Ihres Auspuffes!

Merci d'avoir choisi un echappement Scorpion.

Entretien de votre silencieux: Ne pas utiliser de solvants ou de produits abrasifs!

Muchas gracias por adquirir un Silencioso Scorpion. Le recomendamos no limpiar el silencioso con productos abrasivos o aquellos que contengan disolventes.



STAY CONNECTED TO RED POWER.