

BIKE	KAWASAKI NINJA 300 KAWASAKI Z300	PART NO.	RKA-96-SYS
YEAR	Ninja :- 2012 - 2015 Z300 :- 2015 - 2016	FIT KITS	Z039.20473
NOTES	Use standard fittings where not supplied.	DB-Killer	SCEXDBK23 - (Type V)

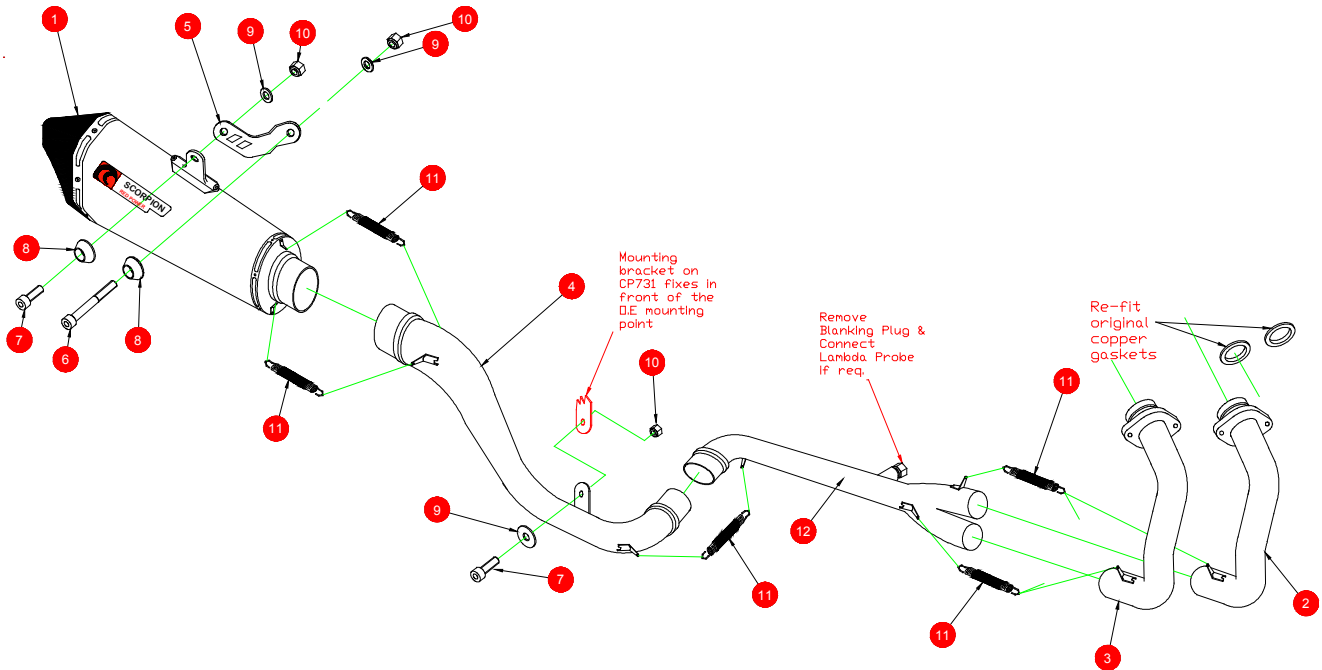

- | | |
|--|---|
| 1 275mm Serket Taper Silencer RSC 253 | 8 2 x Aluminium Bolt Finishers (Z026.20068) |
| 2 Connecting Pipe CP760 (Front Pipe L/H) | 9 3 x M8x17mm Washers (Z017.10831) |
| 3 Connecting Pipe CP761 (Front Pipe R/H) | 10 3 x M8 Nyloc Nuts (Z017.10062) |
| 4 Connecting Pipe CP763 (Link Pipe) | 11 5 x Rubber Coated Springs (Z028.10030) |
| 5 Mounting Bracket (Z015.31027) | 12 Collector CP762 |
| 6 M8x60mm Cap Head Bolt (Z017.10080) | |
| 7 2 x M8x20mm Cap Head Bolt (Z017.10072) | |

E-MARK	BSAU 193a t3/1990
ISSUE NO.	07
DATE	17/10/2018
AUTHORISED	J.Harkin
CHECKED	

NOTE: ENSURE SCORPION SYSTEM IS CLEAR OF MOVING PARTS AND ALL ORIGINAL FUNCTIONS WORK CORRECTLY.



A) Remove original exhaust, taking care not to lose or damage any of the original components.

B) Fit the Scorpion Exhaust as per line diagram above.

C) When fitted, take bike for a short test run, upon return allow bike to cool and check all nuts and bolts are secure.

Box: PLOCK 2

BIKE	KAWASAKI NINJA 300 KAWASAKI Z300	PART NO.	RKA-96SYS
YEAR	2012 - Current 2015 - Current	FIT KITS	Z039.20473
NOTES		FEATURES	

Thank you for purchasing your Scorpion Silencer.

Care of your exhaust: Please refrain from cleaning silencer with heavy solvents or abrasives!

Vielen Dank Für den kauf eines Scorpion Schalldampfers! Pflegehinweis: Bitte verwenden Sie niemals Scheuermittel oder aggressive Reiniger zur Pflege Ihres Auspuffes!

Merci d'avoir choisi un echappement Scorpion.

Entretien de votre silencieux: Ne pas utiliser de solvants ou de produits abrasifs!

"Muchas gracias por adquirir un Silencioso Scorpion. Le recomendamos no limpiar el silencioso con productos abrasivos o aquellos que contengan disolventes."