

# YAMAHA YZF1000 R1 2009-0N

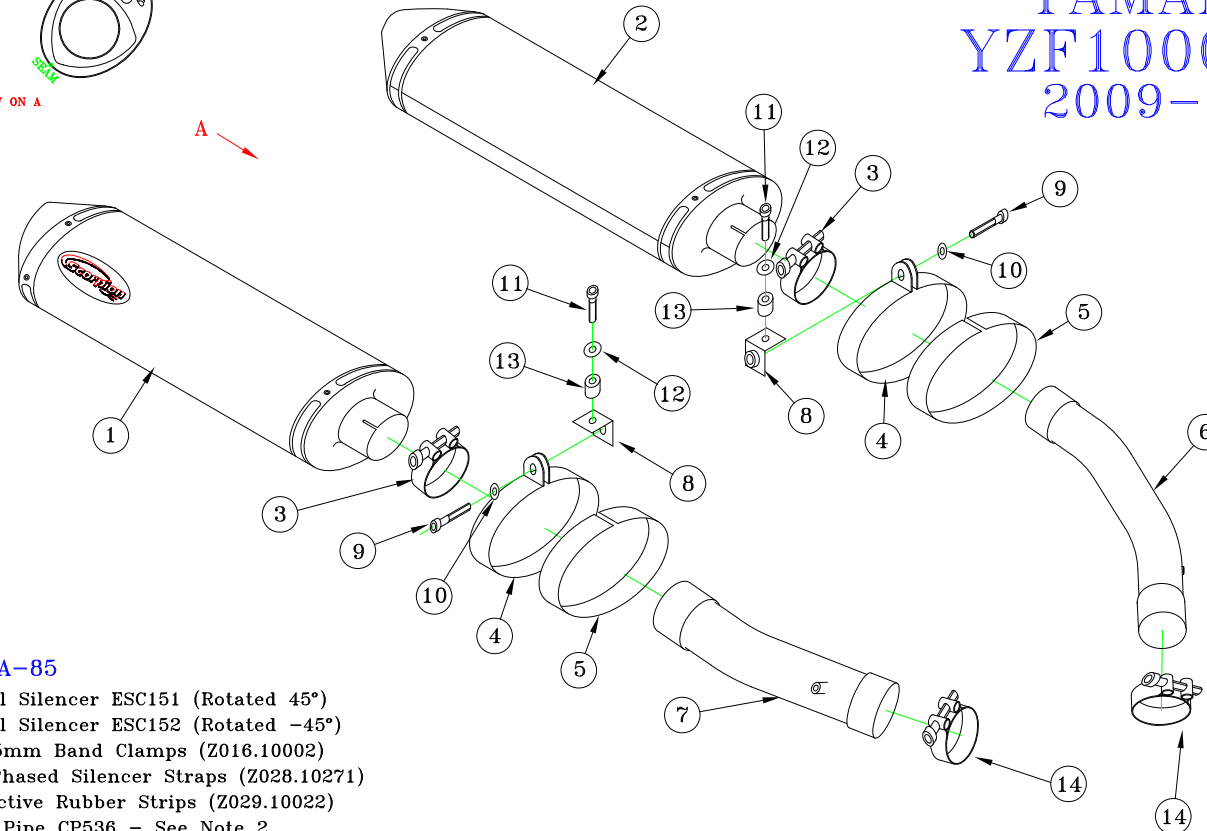

## Part No. EYA-85

- ① 300mm Oval Silencer ESC151 (Rotated 45°)
- ② 300mm Oval Silencer ESC152 (Rotated -45°)
- ③ 2 off 51-55mm Band Clamps (Z016.10002)
- ④ 2 off "H" Phased Silencer Straps (Z028.10271)
- ⑤ 2 off Protective Rubber Strips (Z029.10022)
- ⑥ Connecting Pipe CP536 - See Note 2
- ⑦ Connecting Pipe CP537 - See Note 2
- ⑧ 2 off Mounting Brackets (Z015.10080)
- ⑨ 2 off M8 x 16mm Cap Head Bolts (Z017.10808)
- ⑩ 4 off M8 x 17mm Washers (Z017.10831)
- ⑪ 2 off M8 x 30mm Cap Head Bolts (Z017.10074)
- ⑫ 2 off M8 x 30mm Washers (Z017.12754)
- ⑬ 2 off 15mm Alloy Spacers (Z026.10005) - See Note 1
- ⑭ 2 off 43-47mm Band Clamps (Z016.10008)

Photographic Fitting Instructions

**NOTE 2: OE HEATSHIELDS SHOULD BE ATTACHED TO SCORPION CONNECTING PIPES USING OE BOLTS AND BAND CLAMPS SHOWN IN STEP 3 OF PHOTOGRAPHIC FITTING INSTRUCTIONS**

**NOTE 1: REPLACE OE RUBBER MOUNT WITH ITEM 13**

E-Mark Oval	YA-85 [e4] 2325 9
Issue No.	1
Date	12/05/09
Authorised	S.NORTHPROP
CHECKED	

**Note :- ENSURE SCORPION SYSTEM IS CLEAR OF MOVING PARTS AND ALL ORIGINAL FUNCTIONS WORK CORRECTLY**



# YAMAHA YZF 1000 R1 FITTING INSTRUCTIONS **EDGE** EYAB5

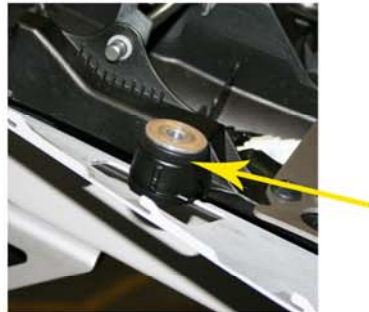

## STEP 1

Remove O.E exhaust from bike and remove highlighted rubber bush.



## STEP 2

Install Scorpion supplied mountings.



## STEP 3

Attach O.E heatshields to Scorpion link pipes, using O.E fixings.



## STEP 4

Install link pipes to O.E pipework, and install silencers to pipework.



## STEP 5

Fit silencer strap round silencer and bolt to Scorpion mountings. Ensure Silencer is square and fitted correctly then tighten up all nuts, bolts and clamps.



## STEP 6

Repeat steps 1-5 for opposite side of bike, then refit all O.E plastics that have been removed.

**When all the above steps have been completed ensure that all original functions are working correctly take your bike out for a short journey, upon return allow your bike to cool before rechecking all nuts and bolts.**

Issue:- 1  
Date:- 16-03-09  
Approved:-