

Where not supplied use original fittings

KAWASAKI
ZX10 R
2008-0N

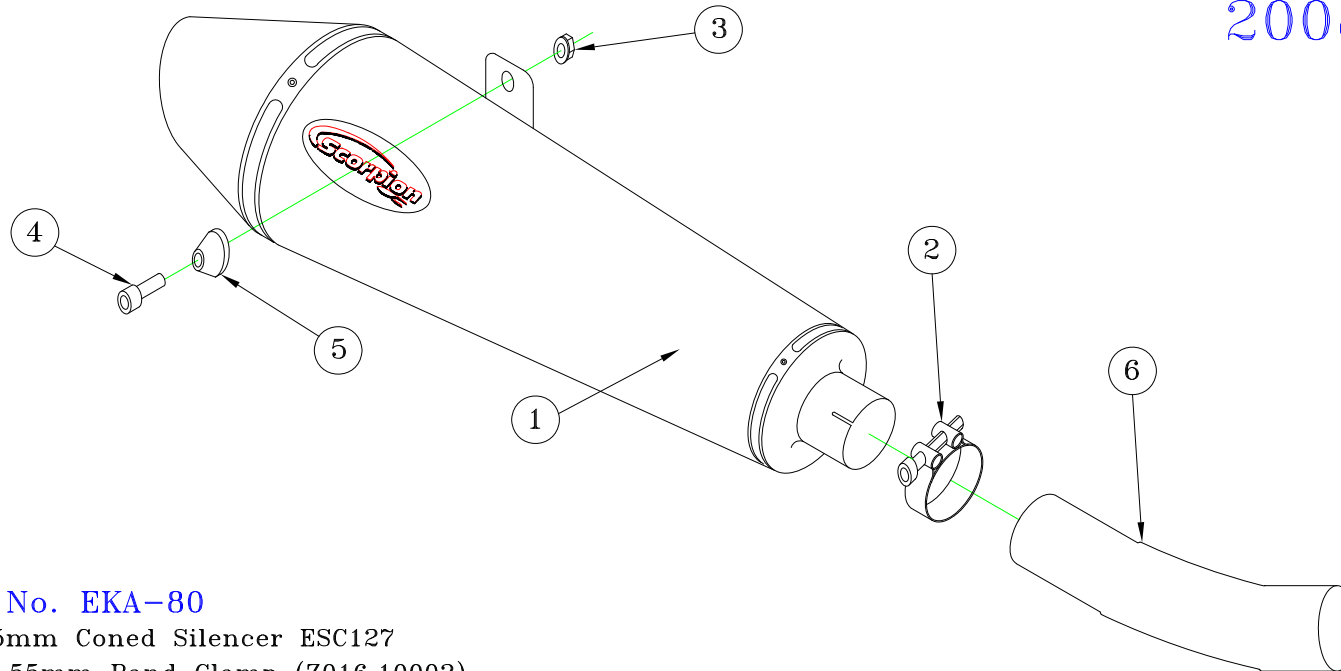

Part No. EKA-80

- ① 275mm Coned Silencer ESC127
- ② 51-55mm Band Clamp (Z016.10002)
- ③ M8 Nyloc Nut (Z017.10062)
- ④ M8 x 35mm Caphead Bolt (Z017.10075)
- ⑤ Aluminium Bolt Finisher (Z026.20068)
- ⑥ Connecting Pipe CP463
- ⑦ Servo wheel (Z007.10955)
- ⑧ Aluminium Collar (Z026.20045)
- ⑨ M6 Split Washer (Z017.10027)

Photo Fitting Instructions

EMark	KA80 e4 2363 ⑨
Issue No.	4
Date	20/07/09
Authorised	S.NORTHROP
Checked	

Note :- ENSURE SCORPION SYSTEM IS CLEAR OF MOVING PARTS AND ALL ORIGINAL FUNCTIONS WORK CORRECTLY

Kawasaki ZX10R 2008

Servo Wheel Fitting Instructions

To disconnect cables at the seat end, you have to remove the hexagonal wheel, without turning it's shaft.



Remove bolt in centre of hexagonal wheel. Support wheel if tight.

Remove hexagonal wheel from shaft, retaining OE bolt.
DO NOT TURN SHAFT



Remove spring clip retaining cables and completely remove the cables



The replacement wheel comes with an aluminium collar that is secured in place with OE bolt and split washer.

TIGHTEN TO 5ft/lb USING A TORQUE WRENCH



The replacement wheel must be fitted with the etched letters "UP"



The replacement wheel will only fit one way with the letters "UP". In case of difficulty please contact us.

With servo wheel fitted, the loose cables will be removed with rest of exhaust system.

Date :- 10/11/09
Issue :- 2
Authorised :- S.NORTHROP